

SILVERTON ROAD WASTE UNIT (BLDG 731-3A) FIELD INSPECTION CHECKLIST

WORKING COPY

This document is a Working Copy. Prior to start of work, verify this is the latest revision per the Procedure Index.

Denny Sahn

 Verified By

07/29/2024

 Date

CAUTION

The Inspector will IMMEDIATELY notify the Post-Closure Manager and Environmental Compliance Authority if there has been a breach or compromise of the institutional controls of this waste unit. This notification will be in accordance with Savannah River Site post-closure inspection procedures.

NOTE

1. Manual C3, Volume I, Procedure ER-SOP-019, Waste Unit and IOU Inspection and Maintenance, will be used as a reference for inspection details.
2. Monitoring wells associated with this waste unit are maintained in accordance with EC&ACP Monitoring Well Procedures.
3. Steps in this checklist may be completed concurrently or in any order.

SCHEDULED

UNSCHEDULED

A = Satisfactory X = Unsatisfactory (Explanation required)		A or X	Observation/Corrective Action Taken
1.	VERIFY roads to waste unit are accessible.	A	
2.	VERIFY that the waste unit signs (4) are in acceptable condition, have correct information and are legible from a distance of 25 feet.	A	

Silverton Road Waste Unit (Bldg 731-3A) Field Inspection Checklist

Manual: C3
 Procedure: ER-IDS-019-001
 Revision: 9
 Page: 2 of 3

SCHEDULED

UNSCHEDULED

A = Satisfactory X = Unsatisfactory (Explanation required)		A or X	Observation/Corrective Action Taken
3.	VERIFY that there is no excavating, digging, or construction activity on the soil cover.	A	
4.	CHECK integrity of drainage ditches for the presence of excessive erosion, sediment buildup, and any debris restricting water flow.	A	
5.	VERIFY that no woody vegetation is growing on the soil cover, AND REMOVE OR IDENTIFY as needed.	A	
6.	VISUALLY CHECK vegetative cover for grass density with no bare spots more than 3 feet by 3 feet in area. (The height of the vegetation should not impair the visual inspection of the soil cover. This will be determined by the Inspector.)	A	
7.	CHECK the soil cover for signs of erosion or depressions (subsidence).	A	
8.	CHECK for signs of burrowing animals.	A	
9.	Other Small standing dead tree near hog barrier fencing.	A	

Inspected By

Donald A. Sahm (Print Name)	 (Signature)	07/29/2024 (Date)
--------------------------------	------------------------------------------------------------------------------------------------------	----------------------

Reviewed by Post-Closure Manager

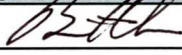
Brian Hanshew (Print Name)	 (Signature)	7/29/2024 (Date)
-------------------------------	-----------------------------------------------------------------------------------------------------	---------------------

Map of Silverton Road Waste Unit (Bldg. 731-3A)

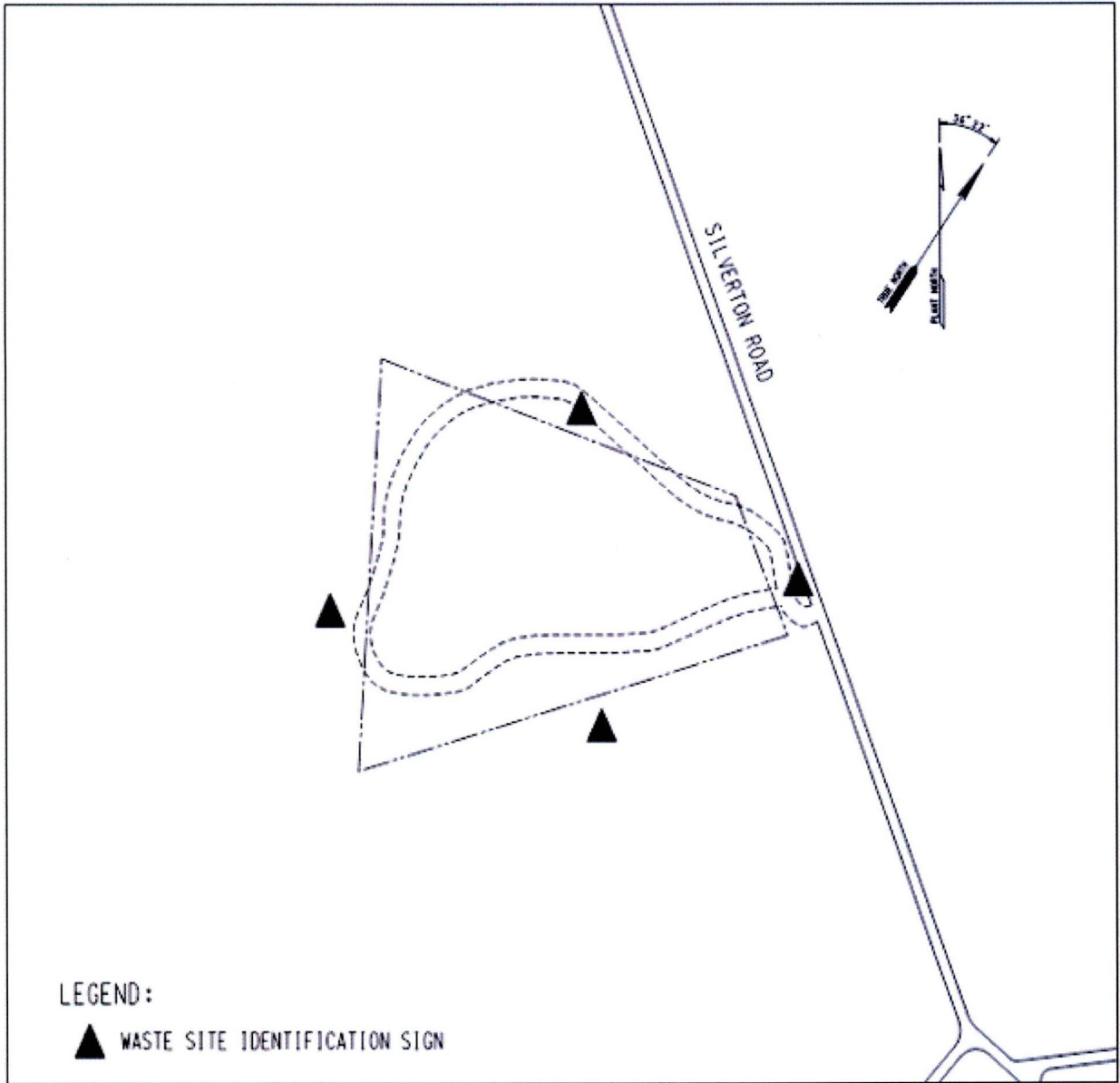

NOTES: NONE
