

**ENVIRONMENTAL COMPLIANCE & AREA COMPLETION PROJECTS (EC&ACP) STANDARD  
OPERATING PROCEDURES, VOL. I**
**Manual: C3**  
**Procedure: ER-IDS-019-044**  
**Revision: 5**  
**Effective Date: 01/11/2022**  
**Type-Class: Checklist**  
**Page: 1 of 4**
**HP-52 FIELD INSPECTION CHECKLIST**
**WORKING COPY**

This document is a Working Copy. Prior to start of work, verify this is the latest revision per the Procedure Index.

Dylan Price  
Verified By

11/18/2024  
Date

**CAUTION**

The Inspector is required to IMMEDIATELY notify the Post-Closure Manager and Environmental Compliance Authority if there has been a breach or compromise of the institutional controls of this waste unit. This notification is in accordance with Savannah River Site post-closure inspection procedures.

**NOTE**

1. Manual C3, Volume 1, Procedure ER-SOP-019, Waste Unit and IOU Inspection and Maintenance, is referenced for inspection details.
2. Monitoring wells associated with this waste unit are maintained in accordance with Environmental Compliance and Area Completion Projects monitoring well procedures.
3. Steps in this checklist may be completed concurrently or in any order.

 SCHEDULED

 UNSCHEDULED

<b>A = Satisfactory</b> <b>X = Unsatisfactory (Explanation required)</b>	<b>A or X</b>	<b>Observation/Corrective Action Taken</b>
1. <b>VERIFY</b> roads are accessible.	A	
2. <b>VERIFY</b> waste unit signs (7) are in acceptable condition, have correct information, and are legible from a distance of 25 feet.	A	

HP-52 Field Inspection Checklist

Manual: C3  
 Procedure: ER-IDS-019-044  
 Revision: 5  
 Page: 2 of 4

SCHEDULED

UNSCHEDULED

A = Satisfactory X = Unsatisfactory (Explanation required)		A or X	Observation/Corrective Action Taken
3.	In restored wetland areas, <b>VERIFY</b> there is safe access for maintenance of warning signs and monuments. (Natural vegetation is expected to grow in the wetland area located to the South side of the channel.)	A	
4.	<b>VERIFY</b> no woody vegetation is growing on soil cover outside wetland area. <b>REMOVE OR IDENTIFY</b> as needed.	A	
5.	<b>CHECK AND MAINTAIN</b> integrity of H-08 Outfall sampling station and drainage channel for presence of excessive erosion, sediment buildup, and any debris restricting water flow. <b>NOTIFY</b> H-Area Operations for any visible signs of damage or unusual condition of headwall at east-end of drainage channel. (The headwall has fixed contamination. The headwall will be maintained and monitored by H-Area Operations).	X	Vegetation restricting water flow in the H-08 drainage channel. Site roads will apply herbicide. see map note: 1 Reference Maintenance Register: PC-2024-00091
6.	<b>VERIFY</b> there are no excavation, digging, or construction activities within site boundary.	A	
7.	<b>VISUALLY CHECK</b> vegetative cover for grass density with no bare spots more than 3-feet by 3-feet in area. (The height of vegetative cover should not impair visual inspection of soil cover. This will be determined by the Inspector.)	A	
8.	<b>CHECK</b> soil cover for signs of erosion or depressions (subsidence).	A	
9.	<b>VERIFY</b> that monuments are visible and have not been damaged.	A	

HP-52 Field Inspection Checklist

Manual: C3  
 Procedure: ER-IDS-019-044  
 Revision: 5  
 Page: 3 of 4

SCHEDULED

UNSCHEDULED

A = Satisfactory		A or X	Observation/Corrective Action Taken
X = Unsatisfactory (Explanation required)			
10.	CHECK for signs of burrowing animals.	A	
11.	Limb debris inside fence. Other. Chain on SE gate needs to be extended.	X	Limb debris inside fence. see map note: 2 maintenance register:PC-2024-00070 Chain on SE gate needs to be extended. see map note 3. Maintenance Register:PC-2024-00071

Inspected By

Dylan Price <i>(Print Name)</i>	<i>Dylan Price</i> <i>(Signature)</i>	11/18/2024 <i>(Date)</i>
------------------------------------	--	-----------------------------

Reviewed By Post-Closure Manager

Brian Hanshew <i>(Print Name)</i>	<i>BH</i> <i>(Signature)</i>	12-19-2024 <i>(Date)</i>
--------------------------------------	---------------------------------	-----------------------------

MAP OF HP-52

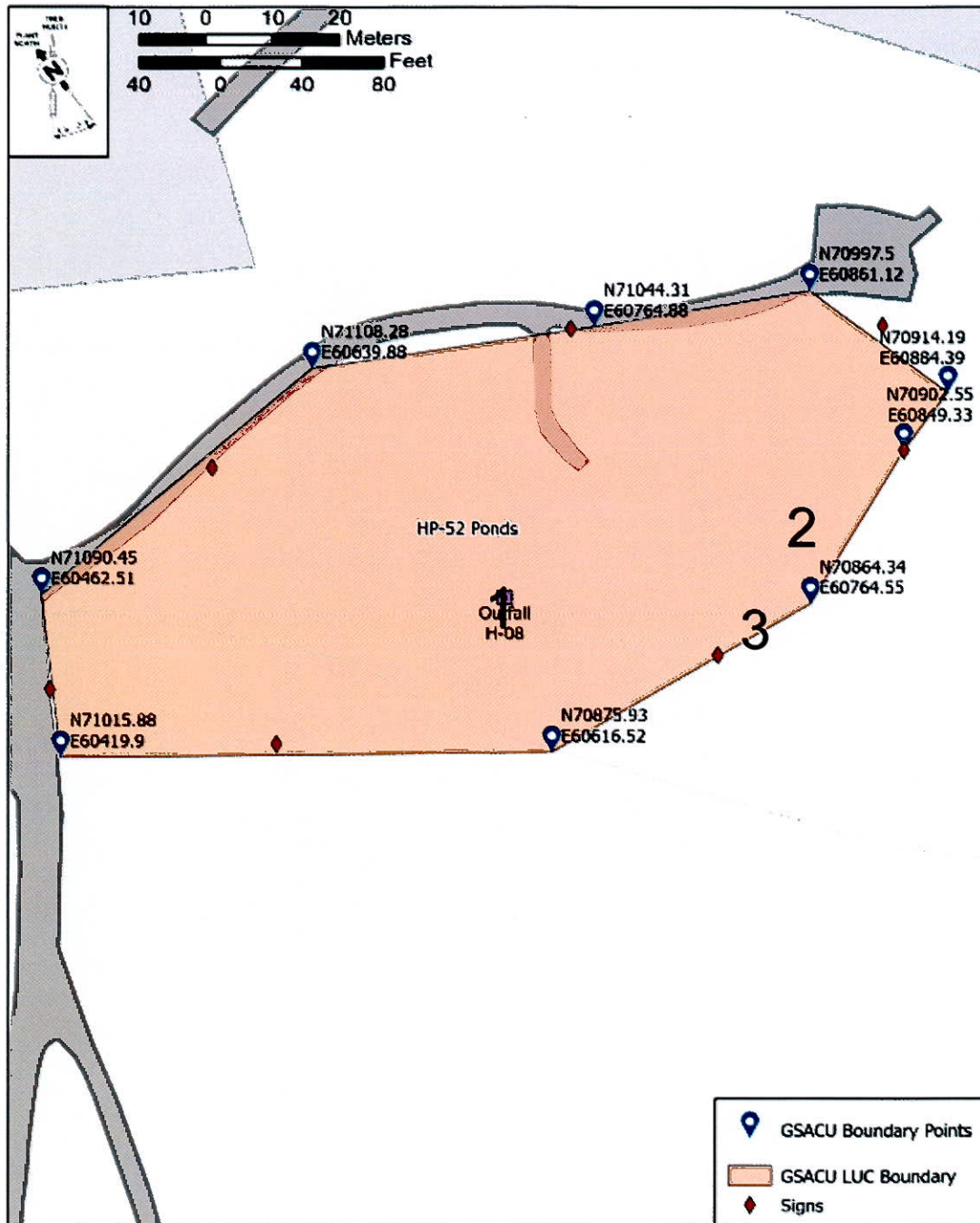

**NOTES:** Note 1 - Vegetation restricting water flow in the H-08 drainage channel. Site roads will apply herbicide.

Note:2 Limb debris inside fence.

Note:3 Chain on SE gate needs to be extended.