

**ENVIRONMENTAL COMPLIANCE & AREA COMPLETION PROJECTS (EC&ACP) STANDARD
OPERATING PROCEDURES, VOL. I**
Manual: C3
Procedure: ER-IDS-019-053
Revision: 2
Effective Date: 06/01/2016
Type-Class: Form
Page: 1 of 3
**L-AREA EARLY CONSTRUCTION AND OPERATIONAL DISPOSAL SITE (ECODS) L-1 OPERABLE
UNIT FIELD INSPECTION CHECKLIST**
WORKING COPY

This document is a Working Copy. Prior to start of work, verify this is the latest revision per the Procedure Index.



Verified By

10/14/2019

Date

CAUTION

The Inspector shall IMMEDIATELY notify the Post-Closure Manager and Environmental Compliance Authority if there has been a breach or compromise of the institutional controls of this waste unit. This notification shall be in accordance with Savannah River Site post-closure inspection procedures.

NOTE

1. Manual C3, ER-SOP-019, *Waste Unit Inspection and Maintenance*, shall be referred to for inspection details.
2. Steps in this checklist may be completed concurrently or in any order.

 SCHEDULED
 UNSCHEDULED

A = Satisfactory X = Unsatisfactory (Explanation required)		A or X	Observation/Corrective Action Taken
1.	Verify roads are accessible. (<i>Corrective Measures Implementation Report (CMIR)/Remedial Action Completion Report (RACR)</i> , Section 7, Note 1, may be referenced) SRNS-RP-2010-01524, 1B, and 1C Operable Unit (U).	X	Several standing dead pine trees adjacent to the access trail needs to be cut down. Some small saplings leaning over trail needs cutting and removing as well as some light overhanging limbs need to be cut back. See Map Note: 1 Reference Maintenance Register: PC-2019-00096
2.	Verify waste unit warning signs (6) are in acceptable condition, have correct information, and are legible from a distance of 25 feet.	A	
3.	Check survey boundary monuments for damage and visibility.	A	

L-Area Early Construction and Operational Disposal Site (ECODS) L-1 Operable Unit Field
 Inspection Checklist

Manual: C3
 Procedure: ER-IDS-019-053
 Revision: 2
 Page: 2 of 3

SCHEDULED

UNSCHEDULED

A = Satisfactory X = Unsatisfactory (Explanation required)		A or X	Observation/Corrective Action Taken
4.	Verify there are no unauthorized excavations, digging, or construction activities within the ECOD L-1 boundaries.	A	
5.	Verify signs of erosion or depression (subsidence) is not present. (CMIR/RACR, Section 7, Item 5) SRNS-RP-2010-01524.	A	
6.	Verify signs of burrowing or mounding animals are not present. (CMIR/RACR, Section 7, Item 4) SRNS-RP-2010-01524.	A	
7.	Other	NO FURTHER ENTRIES	

CPC 10/14/2019

Inspected By		
Charles P. Carter <i>(Print Name)</i>	<i>Charles P. Carter</i> <i>(Signature)</i>	10/14/2019 <i>(Date)</i>

Review By Post-Closure Manager		
George W. Joyner <i>(Print Name)</i>	<i>George W. Joyner</i> <i>(Signature)</i>	10/14/19 <i>(Date)</i>

L-Area ECODS L-1 Operable Unit

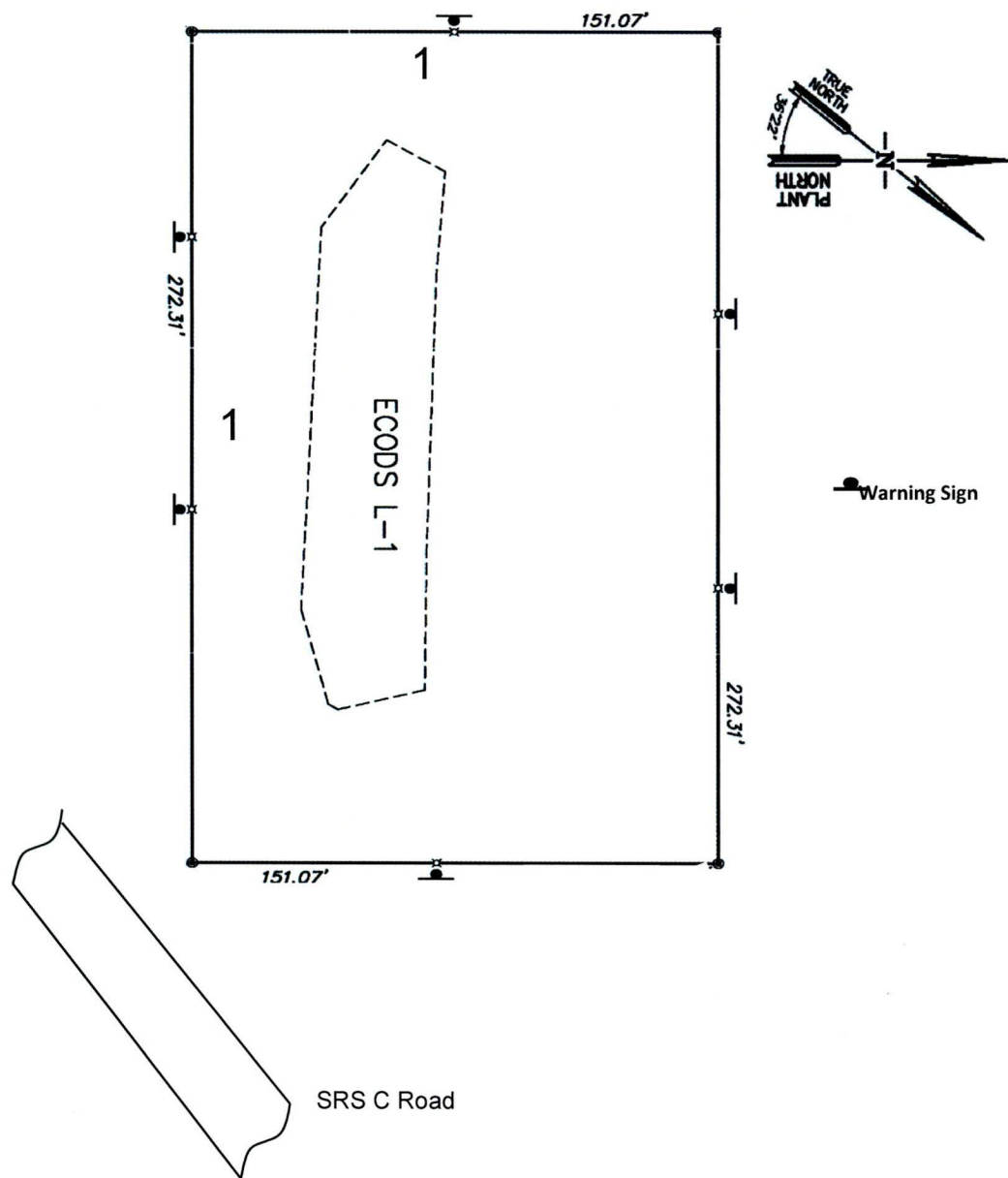

NOTES: 1=Several standing dead pine trees adjacent to the access trail needs to be cut down.
Some small saplings leaning over trail needs cutting and removing as well as some light overhanging
limbs need to be cut back. USFS will cut trees, saplings and remove limbs.

NO FURTHER ENTRIES

POST CLOSURE MAINTENANCE REGISTER

Index Number

Unit Name

535 L AREA ECODS L-1 OPERABLE UNIT

Watershed STEEL CREEK

AHA # NA
Work Order # N/A
Work Group USFS
Priority Medium
RCRA NO

Maintenance Number PC-2019-00096 **Maintenance Status** Complete
Inspection Date 10/14/2019 **Chemical Type** NA
Completion Date 3/23/2020 **Chemical Name**
Amount Used

Description Of Maintenance Item

Several standing dead pine trees adjacent to the access trail needs to be cut down. Some small saplings leaning over trail needs cutting and removing as well as some light overhanging limbs need to be cut back.

Maintenance Item Corrected

USFS cut down trees, removed saplings and trimmed overhanging limbs

Notes New observation

Approved by : George Joyner - ACP Post Closure Manager

Signature

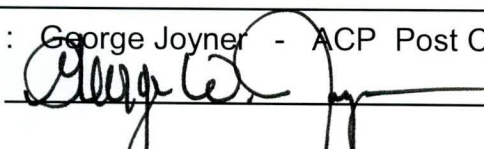

Approval date :

3/23/2020