

**ENVIRONMENTAL COMPLIANCE & AREA COMPLETION PROJECTS (EC&ACP) STANDARD OPERATING PROCEDURES, VOL. I**

**Manual:** C3  
**Procedure:** ER-IDS-019-028  
**Revision:** 4  
**Effective Date:** 08/13/2018  
**Type-Class:** Checklist  
**Page:** 1 of 4

**SANITARY LANDFILL (BLDG. 740-G) FIELD INSPECTION CHECKLIST**

**WORKING COPY**

This document is a Working Copy. Prior to start of work, verify this is the latest revision per the Procedure Index.

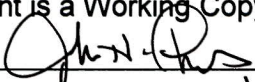
  
 \_\_\_\_\_ 11/12/2021  
 Verified By Date

**CAUTION**

The Inspector shall IMMEDIATELY notify the Post Closure Manager and Environmental Compliance Authority if there has been a breach or compromise of the institutional controls of this waste unit. This notification shall be in accordance with Savannah River Site post closure inspection procedures.

**NOTE**

1. Manual C3, ER-SOP-019, Waste Unit Inspection and Maintenance, shall be referred to for inspection details.
2. Monitoring wells associated with this waste unit are maintained in accordance with EC&ACP monitoring well procedures.
3. Steps in this checklist may be completed concurrently or in any order.
4. Unsatisfactory conditions found during the inspection may be listed on the detailed map of the inspected area.

**SCHEDULED**
                         
  **UNSCHEDULED**

	A = Satisfactory X = Unsatisfactory (Explanation required)	A or X	Observation/Corrective Action Taken
1.	Verify roads to waste unit are accessible.	A	
2.	Verify gates and fence are in Good condition and all unattended gates are locked.	X	The Southeast perimeter gate was not closing properly. See Map Note: 1 Reference Maintenance Register PC-2021-00107
3.	Inspect for excessive vegetative growth which may obstruct warning signs and visibility of inspection areas.	A	

**Sanitary Landfill (Bldg. 740-G) Field Inspection Checklist**

Manual: C3  
 Procedure: ER-IDS-019-028  
 Revision: 4  
 Page: 2 of 4

SCHEDULED                       UNSCHEDULED

<b>A = Satisfactory</b> <b>X = Unsatisfactory (Explanation required)</b>		A or X	Observation/Corrective Action Taken
4.	Verify waste unit signs (12) are in Acceptable condition, have correct information, and are legible from a distance of 25 feet.	A	
5.	Inspect soil cover for signs of erosion, abnormal soil cracks, ponding, or depressions (subsidence).	A	
6.	Inspect for signs of burrowing animals.	X	Active Ant Mounds on soil cover. See Map Note:2 Reference Maintenance Register: PC-2021-00108
7.	Visually inspect vegetative cover for grass density, with no bare spots more than 3 feet by 3 feet in the area. The height of vegetative cover should not impair visual inspection of soil cover. This will be determined by the Inspector.	A	
8.	Inspect integrity of drainage system for presence of excessive erosion, sediment build-ups, slumping of banks, and any debris restricting water flow.	A	
9.	Inspect integrity of catch basins, including inlet/outlet drainage structures. Basins shall be cleaned every 2 years or when Inspector or Post Closure Manager determines capacity of basin has been reduced by greater than 50 percent.	A	
10.	Inspect gas vents for signs of damage or obstructions.	A	
11.	Inspect subsidence monitors annually for damage and visibility.	A	

Sanitary Landfill (Bldg. 740-G) Field Inspection Checklist

Manual: C3  
 Procedure: ER-IDS-019-028  
 Revision: 4  
 Page: 3 of 4

SCHEDULED                       UNSCHEDULED

A = Satisfactory X = Unsatisfactory (Explanation required)		A or X	Observation/Corrective Action Taken
12.	Inspect benchmarks to ensure each is visible and free of damage.	A	
13.	Survey subsidence monitors every 5 years. The next topographical survey is due November 2022 and every 5 years thereafter. Verify copies of the latest survey results are in EC&ACP Document Control Center.	A	Completed 10/31/2017 SRNS-IM-2021-00121
14.	Other	<b>NO FURTHER ENTRIES</b>	
			JHT 11/12/2021

Inspected By:		
John H. Thomas		11/12/2021
Print Name	Signature	Date

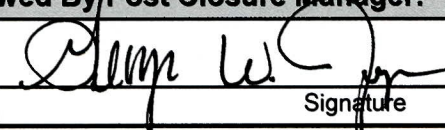
Reviewed By Post Closure Manager:		
George W. Joyner		11/16/21
Print Name	Signature	Date

Map of Sanitary Landfill (Bldg. 740-G)

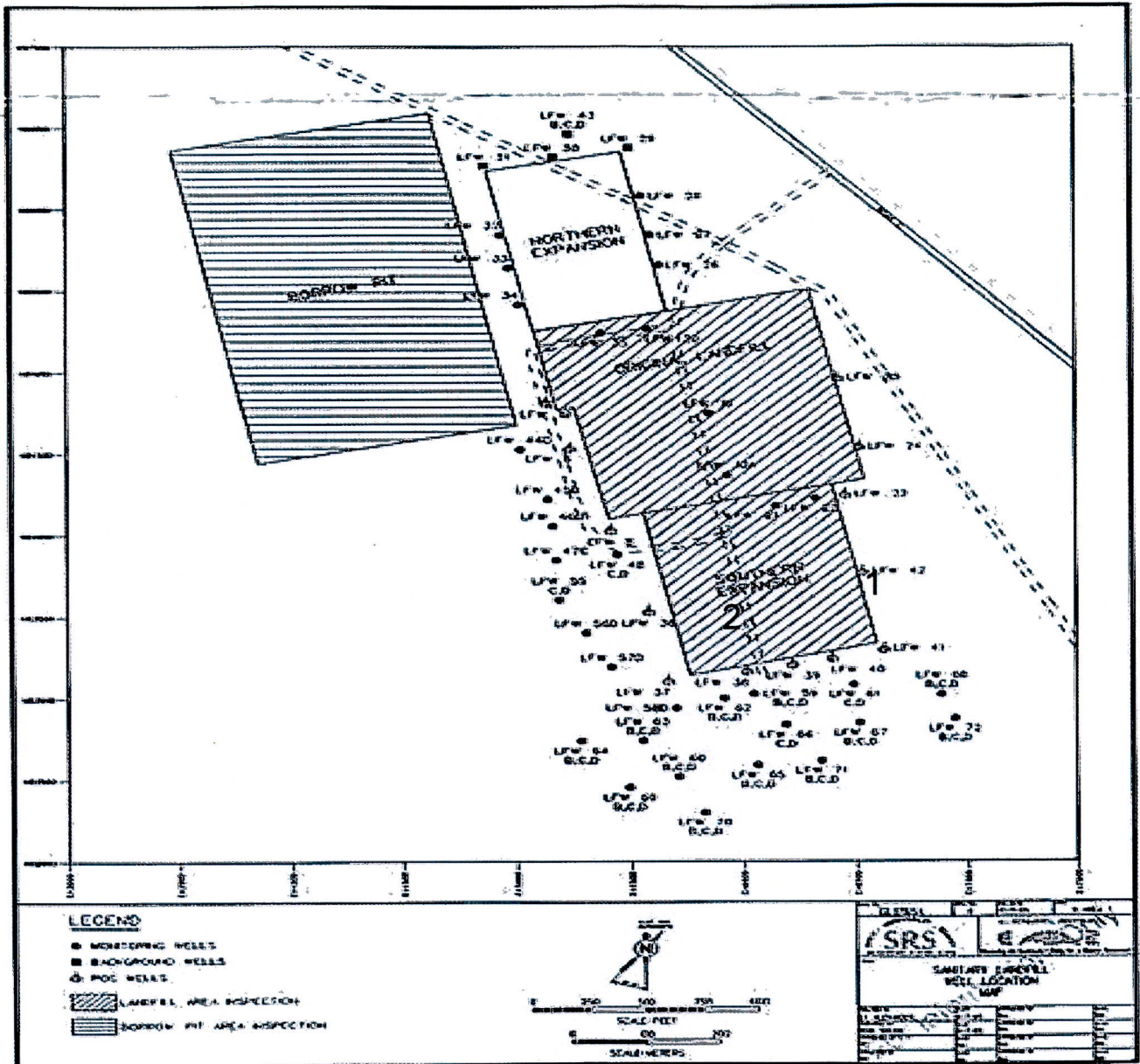

**NOTES:** 1=The Southeast perimeter gate was not closing properly. Post Closure Maintenance performed adjustments to the gate to allow for proper operation. 2=Active Ant Mounds on soil cover. Applied 0.5 lb. of extinguish ant bait.

**NO FURTHER ENTRIES**

JHT 11/12/2021

# POST CLOSURE MAINTENANCE REGISTER

**Index Number**

**Unit Name**

21 NON-RADIOACTIVE WASTE DISPOSAL FACILITY (AKA SANITARY LANDFILL RCRA PORTION)- 740-G

**Watershed** UPPER THREE RUNS

**AHA #** AHA-ER-5534

**Work Order #** N/A

**Work Group** POST CLOSURE MAINTENANCE

**Priority** Medium

**RCRA** YES

**Maintenance Number** PC-2021-00107

**Maintenance Status** Complete

**Inspection Date** 11/12/2021

**Chemical Type**

**Completion Date** 11/12/2021

**Chemical Name**

**Amount Used**

**Description Of Maintenance Item**

The Southeast perimeter gate was not closing properly

**Maintenance Item Corrected**

Post Closure Maintenance performed adjustments to the gate to allow for proper operation.

**Notes** New observation

---

Approved by : George Joyner - ACP Post Closure Manager

Signature

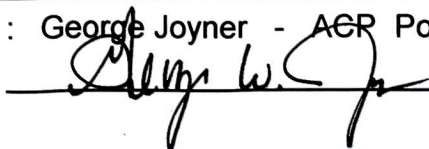

Approval date :

11/16/21

# POST CLOSURE MAINTENANCE REGISTER

**Index Number**

**Unit Name**

21 NON-RADIOACTIVE WASTE DISPOSAL FACILITY (AKA SANITARY LANDFILL RCRA PORTION)- 740-G

**Watershed** UPPER THREE RUNS

**AHA #** AHA-ER-5534

**Work Order #** N/A

**Work Group** POST CLOSURE MAINTENANCE

**Priority** Medium

**RCRA** YES

**Maintenance Number** PC-2021-00108

**Maintenance Status** Complete

**Inspection Date** 11/12/2021

**Chemical Type** Pesticide

**Completion Date** 11/12/2021

**Chemical Name** Extinguish

**Amount Used** 0.5 Pounds

**Description Of Maintenance Item**

Active ant mounds on waste unit

**Maintenance Item Corrected**

Applied Extinguish pesticide.

**Notes** New observation

---

Approved by : George Joyner - ACP Post Closure Manager

Signature

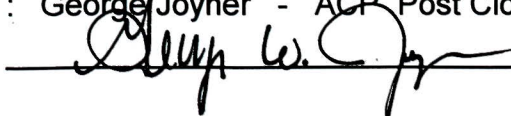

Approval date :

11/16/21