

**ENVIRONMENTAL COMPLIANCE & AREA COMPLETION PROJECTS (EC&ACP) STANDARD
OPERATING PROCEDURES, VOL. I**
Manual: C3
Procedure: ER-IDS-019-006
Revision: 5
Effective Date: 06/01/2016
Type-Class: Form
Page: 1 of 3
P-AREA BINGHAM PUMP OUTAGE PIT (BLDG. 643-4G) FIELD INSPECTION CHECKLIST
WORKING COPY

This document is a Working Copy. Prior to start of work, verify this is the latest revision per the Procedure Index.

Charles P. Carter
 Verified By

8-3-18
 Date

CAUTION

The Inspector shall IMMEDIATELY notify the Post-Closure Manager and Environmental Compliance Authority if there has been a breach or compromise of the institutional controls of this waste unit. This notification shall be in accordance with Savannah River Site post-closure inspection procedures.

NOTE

1. Manual C3, ER-SOP-019, *Waste Unit Inspection and Maintenance*, may be referred to for inspection details.
2. Monitoring wells associated with this waste unit are maintained in accordance with EC&ACP monitoring well procedures.
3. Steps in this checklist may be completed concurrently or in any order.

 SCHEDULED
 UNSCHEDULED

A = Satisfactory X = Unsatisfactory (Explanation required)		A or X	Observation/Corrective Action Taken
1.	Verify roads to waste unit are accessible.	A	
2.	Verify waste unit signs (2) are in acceptable condition, have the correct information and are legible from a distance of 25 feet. REFER TO Manual C1, ER-AP-127, <i>ACP Waste Unit Field Inspection and Maintenance</i> .	X	REPLACED WASTE UNIT SIGNS. SIGNS WERE FADED. SEE MAP NOTE: ① REF. MAINT. REGISTER TCL - 2018-00080

P-Area Bingham Pump Outage Pit (Bldg. 643-4G) Field Inspection Checklist

Manual: C3
 Procedure: ER-IDS-019-006
 Revision: 5
 Page: 2 of 3

SCHEDULED

UNSCHEDULED

A = Satisfactory		A or X	Observation/Corrective Action Taken
X = Unsatisfactory (Explanation required)			
3.	Verify there is no excavating, digging or construction activity on the soil cover.	A	
4.	Verify no woody vegetation is growing on the soil cover. Remove or identify as needed.	A	
5.	Visually check vegetative cover for grass density with no bare spots more than 3 feet by 3 feet in area. The height of the vegetative cover should not impair the visual inspection of the soil cover. This will be determined by the Inspector.	A	
6.	Check soil cover for signs of erosion or depressions (subsidence).	A	
7.	Check for signs of burrowing animals.	A	
8.	Other <i>NO FURTHER ENTRIES</i>		<i>CPL 8-3-18</i>

Inspected By

<i>Charles P. Carter</i> (Print Name)	<i>Charles P. Carter</i> (Signature)	<i>8-3-18</i> (Date)
--	---	-------------------------

Review By Post-Closure Manager

<i>George W. Joyner</i> (Print Name)	<i>George W. Joyner</i> (Signature)	<i>9/6/18</i> (Date)
---	--	-------------------------

P-Area Bingham Pump Outage Pit (Bldg. 643-4G) Field Inspection Checklist

Manual: C3
Procedure: ER-IDS-019-006
Revision: 5
Page: 3 of 3

Map of P-Area Bingham Pump Outage Pit (Bldg. 643-4G)

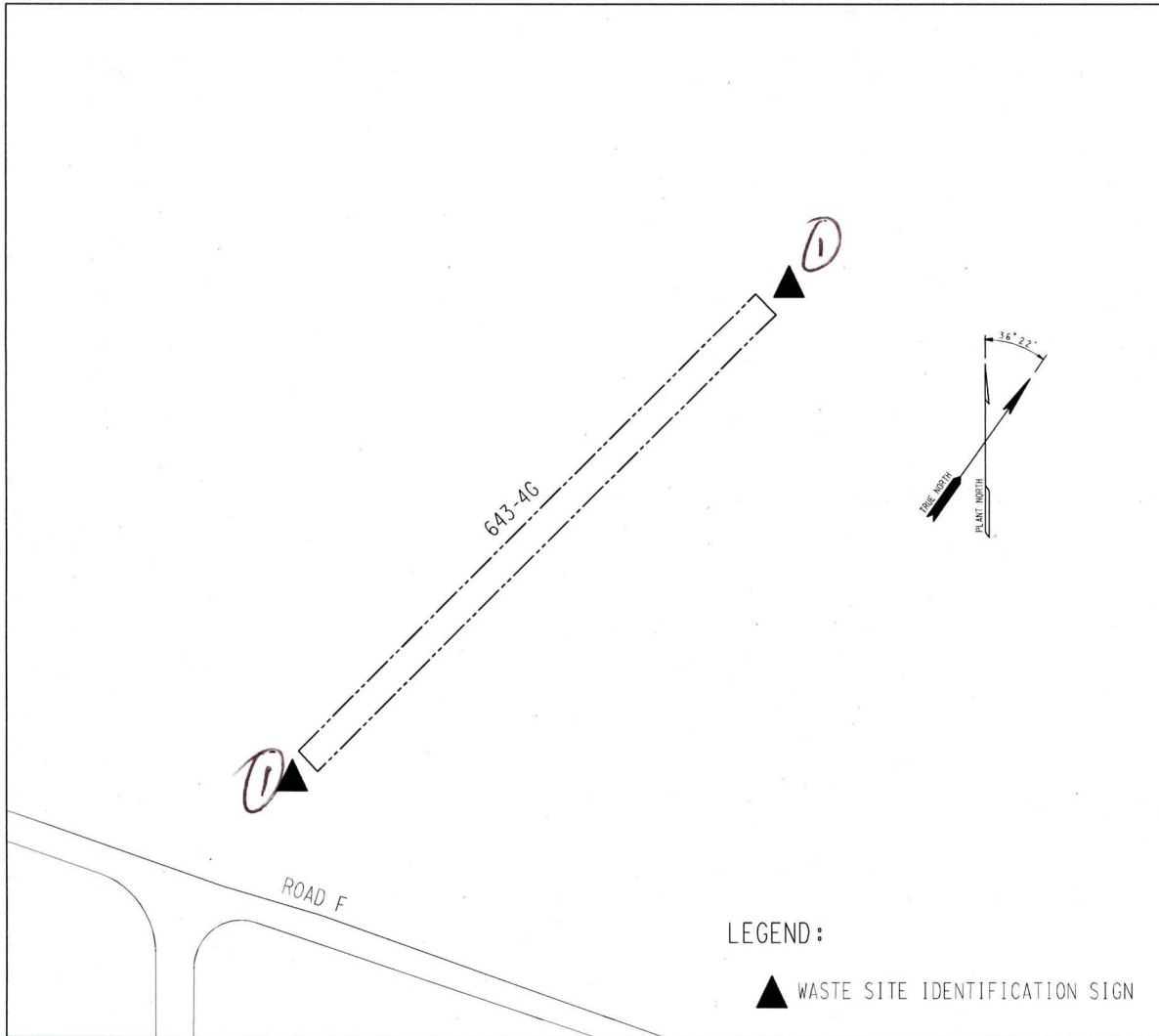

NOTES: ①: REPLACED WASTE UNIT SIGNS. SIGNS WERE
FADED. POST CLOSURE MAINT. REPLACED SIGNS.

~~NO FURTHER ENTRIES~~

CPL 8-3-18

POST CLOSURE MAINTENANCE REGISTER

Index Number
Unit Name

107 P-AREA BINGHAM PUMP OUTAGE PIT - 643-4G

Watershed LOWER THREE RUNS

AHA # NA
 Work Order # NA
 Work Group POST CLOSURE MAINTENANCE
 Priority Medium
 RCRA NO

Maintenance Number PC-2018-00080 Maintenance Status Complete
 Inspection Date 8/3/2018 Chemical Type NA
 Completion Date 8/3/2018 Chemical Name
 Amount Used

Description Of Maintenance Item

Waste Unit Signs are faded and need replacing.

Maintenance Item Corrected

Replaced Waste Unit Signs

Notes New observation

Approved by : George Joyner - ACP Post Closure Manager

Signature

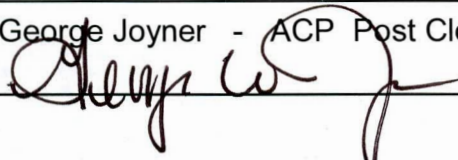

Approval date :

9/6/18