

**ENVIRONMENTAL COMPLIANCE & AREA COMPLETION PROJECTS (EC&ACP) STANDARD
OPERATING PROCEDURES, VOL. I**

Manual: C3
Procedure: ER-IDS-019-053
Revision: 3
Effective Date: 09/02/2021
Type-Class: Checklist
Page: 1 of 3

**L-AREA EARLY CONSTRUCTION AND OPERATIONAL DISPOSAL SITE (ECODS) L-1 OPERABLE
UNIT FIELD INSPECTION CHECKLIST**

WORKING COPY

This document is a Working Copy. Prior to start of work, verify this is the latest revision per the Procedure Index.

Dylan Price Verified B 5-16-25 Date

CAUTION

The Inspector will IMMEDIATELY notify the Post-Closure Manager and Environmental Compliance Authority if there has been a breach or compromise of the institutional controls of this waste unit. This notification will be made in accordance with Savannah River Site post-closure inspection procedures.

NOTE

1. Manual C3, Volume 1, Procedure ER-SOP-019, Waste Unit and IOU Inspection and Maintenance, will be referenced for inspection details.
2. Steps in this checklist may be completed concurrently or in any order.

SCHEDULED

UNSCHEDULED

A = Satisfactory X = Unsatisfactory (Explanation required)		A or X	Observation/Corrective Action Taken
1.	VERIFY roads are accessible, AND REFER TO SRNS-RP-2010-01524, Corrective Measures Implementation Report (CMIR)/Remedial Action Completion Report (RACR), Section 7, Note 1.	A	
2.	VERIFY waste unit warning signs (6) are in acceptable condition, have correct information, and are legible from a distance of 25 feet.	A	
3.	CHECK survey boundary monuments for damage and visibility.	A	

**L-Area Early Construction and Operational Disposal Site (ECODS) L-1 Operable Unit Field
Inspection Checklist**

Manual: C3
Procedure: ER-IDS-019-053
Revision: 3
Page: 2 of 3

SCHEDULED

UNSCHEDULED

A = Satisfactory		A or X	Observation/Corrective Action Taken
X = Unsatisfactory (Explanation required)			
4.	VERIFY there are no unauthorized excavations, digging, or construction activities within the Early Construction and Operational Disposal Site L-1 boundaries.	A	
5.	VERIFY signs of erosion or depression (subsidence) is not present. SRNS-RP-2010-01524 (CMIR/RACR, Section 7, Item 5).	A	
6.	VERIFY signs of burrowing or mounding animals are not present. SRNS-RP-2010-01524 (CMIR/RACR, Section 7, Item 4).	A	
7.	Other <i>None</i>	A	

Inspected By		
<i>Dylan Price</i> (Print Name)	<i>Dylan Price</i> (Signature)	<i>5-16-25</i> (Date)

Reviewed by Post-Closure Manager		
<i>BRIAN HANSHAW</i> (Print Name)	<i>[Signature]</i> (Signature)	<i>5-28-25</i> (Date)

**L-Area Early Construction and Operational Disposal Site
(ECODS) L-1 Operable Unit Field Inspection Checklist**

Manual: C3
Procedure: ER-IDS-019-053
Revision: 3
Page: 3 of 3

L-Area ECODS L-1 Operable Unit

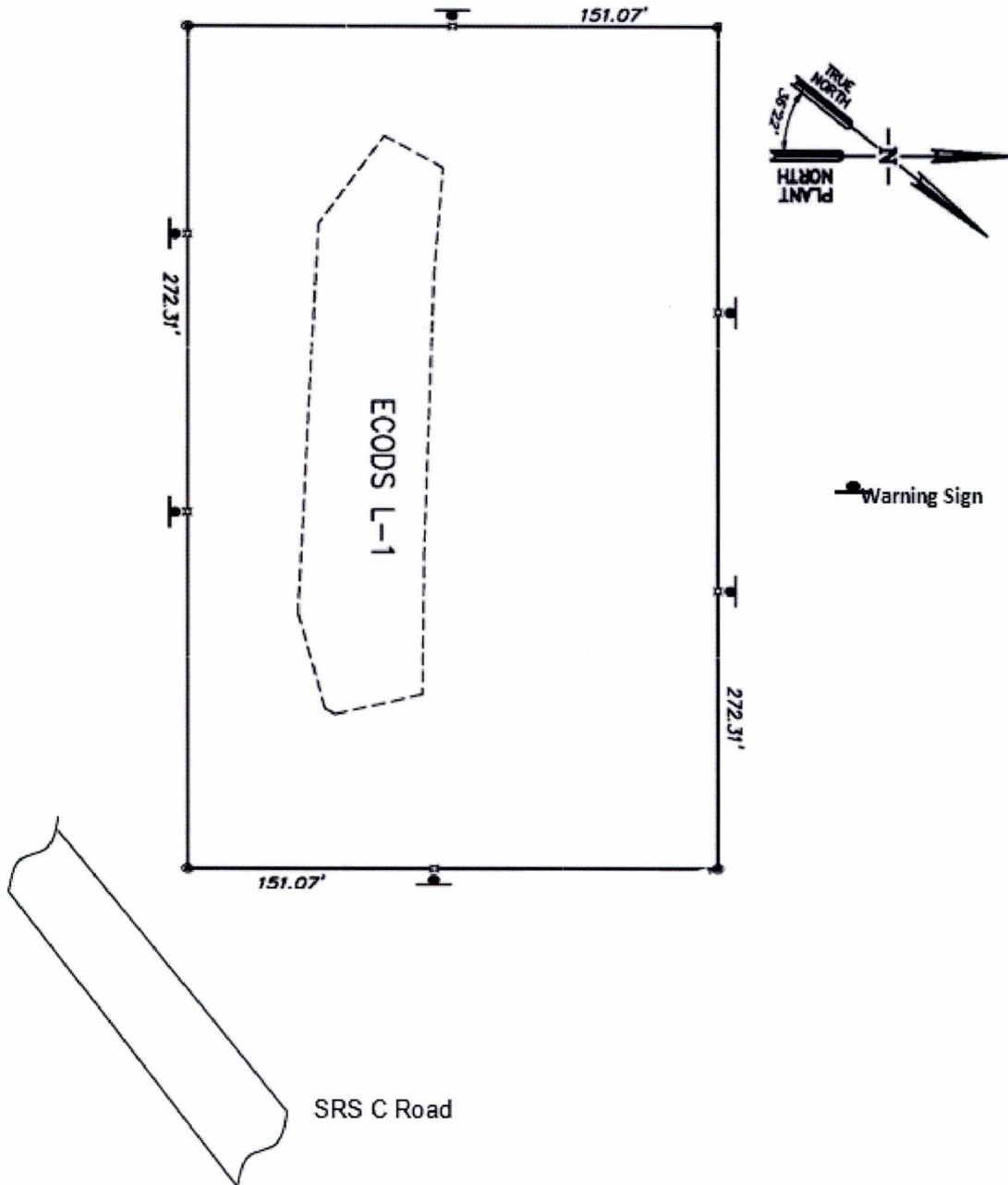

NOTES: *None*
