

**ENVIRONMENTAL COMPLIANCE & AREA COMPLETION PROJECTS (EC&ACP) STANDARD
OPERATING PROCEDURES, VOL. I**

Manual: C3
Procedure: ER-IDS-019-062
Revision: 2
Effective Date: 06/01/2016
Type-Class: Form
Page: 1 of 3

CHEMICAL, METAL, AND PESTICIDE PITS (CMPP) FIELD INSPECTION CHECKLIST

WORKING COPY

This document is a Working Copy. Prior to start of work, verify this is the latest revision per the Procedure Index.

Charles P. Carter _____ 05/27/2020 _____
 Verified By Date

CAUTION

The Inspector shall IMMEDIATELY notify the Post-Closure Manager and Environmental Compliance Authority if there has been a breach or compromise of the institutional controls of this waste unit. This notification shall be in accordance with Savannah River Site post-closure inspection procedures.

NOTE

1. Monitoring wells associated with this waste unit are maintained in accordance with EC&ACP monitoring well procedures.
2. Manual C3, ER-SOP-019, *Waste Unit Inspection and Maintenance*, shall be referred to for inspection details.
3. Steps in this checklist may be completed concurrently or in any order.

SCHEDULED **UNSCHEDULED**

A = Satisfactory		A or X	Observation/Corrective Action Taken
X = Unsatisfactory (Explanation required)			
1.	Verify roads are accessible.	A	
2.	Verify six waste unit warning signs are in acceptable condition, have correct information, and are legible from a distance of 25 feet.	A	

Chemical, Metal, and Pesticide Pits (CMPP) Field Inspection Checklist

Manual: C3
 Procedure: ER-IDS-019-062
 Revision: 2
 Page: 2 of 3

 SCHEDULED

 UNSCHEDULED

A = Satisfactory	A or X	Observation/Corrective Action Taken
X = Unsatisfactory (Explanation required)		
3. Verify there are no unauthorized excavation, digging, or construction activities within land use control area.	A	
4. Verify integrity of any drainage ditches, sediment basins, and required land grading for proper drainage is maintained, are free of excessive erosion, sediment build-up, and any debris restricting water flow.	A	
5. Verify no woody vegetation is growing on the soil cover. Remove or identify as needed.	A	
6. Verify grass density on soil cover has no bare spots more than 3 by 3 feet in area. The height of vegetative cover should not impair visual inspection of soil cover.	A	
7. Verify soil cover has no signs of unacceptable erosion or depressions (subsidence).	A	
8. Verify signs of burrowing or mounding animals are not present at CMPP soil cover.	X	Active ant mounds on soil cover See map note:1 Ref. Maint. Register: PC-2020-00034

Inspected By

Charles P. Carter
(Print Name)

Charles P. Carter
(Signature)

05/27/2020
(Date)

Review By Post-Closure Manager

George W. Joyner
(Print Name)

George W. Joyner
(Signature)

6/11/2020
(Date)

Chemical, Metal, and Pesticide Pits (CMPP) Field Inspection Checklist

Manual: ER-IDS-019-062
Procedure: 2
Revision: 3 of 3
Page:

Map of Chemical, Metal, and Pesticides Pits

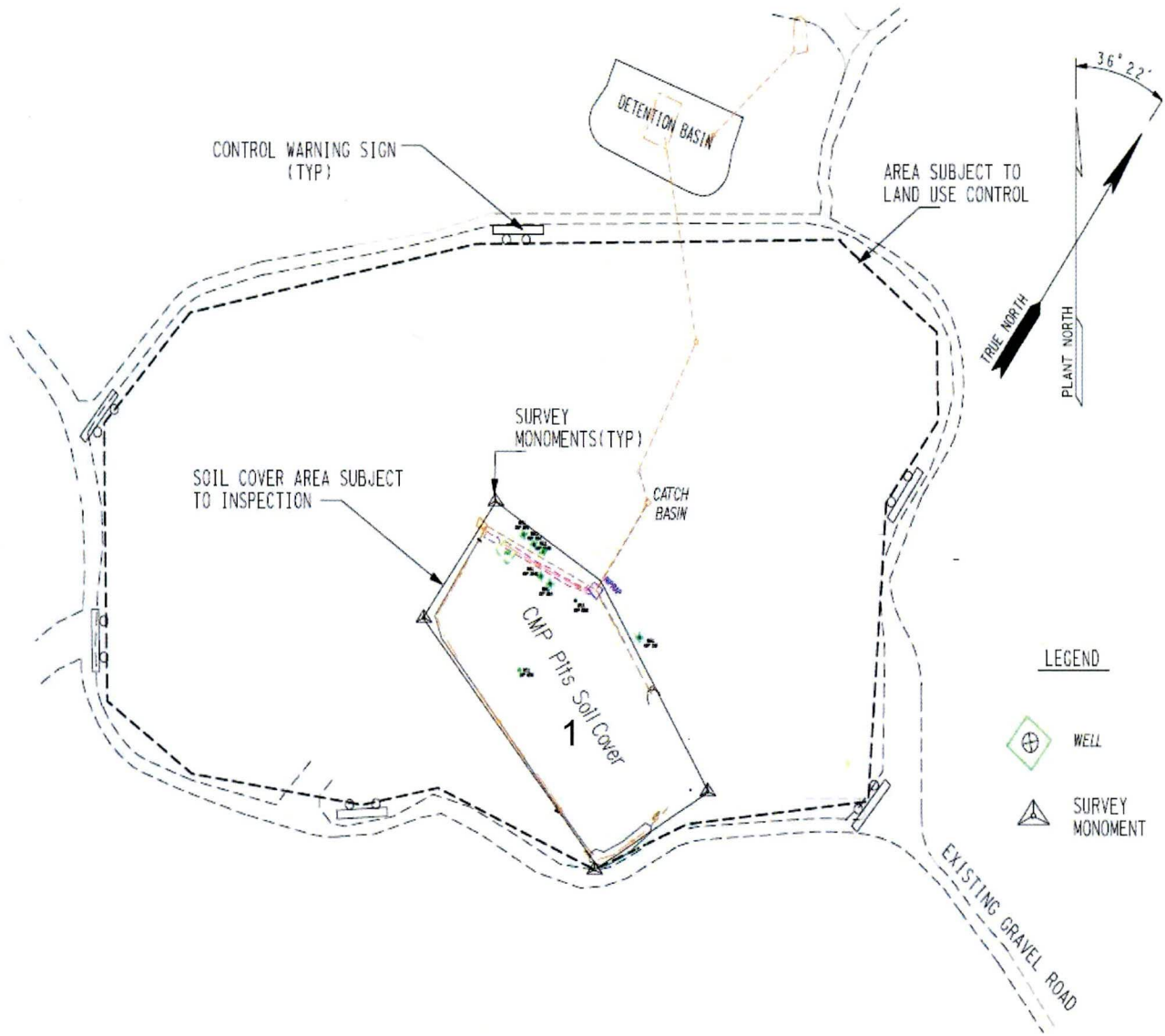

NOTES: 1=Active ant mounds on soil cover. Applied 1.0 lbs of extinguish ant bait.

NO FURTHER ENTRIES

POST CLOSURE MAINTENANCE REGISTER

Index Number
Unit Name

61 CHEMICAL, METAL AND PESTICIDES PITS (CMP)

Watershed PEN BRANCH

AHA # NA
 Work Order # NA
 Work Group POST CLOSURE MAINTENANCE
 Priority Medium
 RCRA NO

Maintenance Number PC-2020-00034

Maintenance Status Complete

Inspection Date 5/27/2020

Chemical Type Pesticide

Completion Date 5/27/2020

Chemical Name Extinguish

Amount Used 1.0 Pounds

Description Of Maintenance Item

Active ant mounds on waste unit

Maintenance Item Corrected

Applied Extinguish pesticide

Notes New observation.

Approved by : George Joyner - ACP Post Closure Manager

Signature

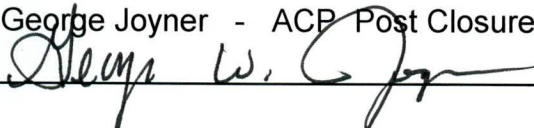

Approval date : 6/1/2020