

ENVIRONMENTAL COMPLIANCE & AREA COMPLETION PROJECTS (EC&ACP) STANDARD OPERATING PROCEDURES, VOL. I

Manual: C3
 Procedure: ER-IDS-019-020
 Revision: 6
 Effective Date: 11/23/2020
 Type-Class: Checklist
 Page: 1 of 4

METALLURGICAL LABORATORY HAZARDOUS WASTE MANAGEMENT FACILITY (HWMF) POST CLOSURE FIELD INSPECTION CHECKLIST

WORKING COPY

This document is a Working Copy. Prior to start of work, verify this is the latest revision per the Procedure Index.

Dylan Paine Verified By 11/6/2024 Date

CAUTION

The Inspector will IMMEDIATELY notify the Post-Closure Manager and Environmental Compliance Authority if there has been a breach or compromise of the institutional controls of this waste unit. This notification will be in accordance with Savannah River Site post-closure inspection procedures.

NOTE

1. Manual C3, Volume 1, Procedure ER-SOP-019, Waste Unit and IOU Inspection and Maintenance, will be referred to for inspection details.
2. Monitoring wells associated with this waste unit are maintained in accordance with EC&ACP monitoring well procedures located at ACP Homepage.
3. Steps in this checklist may be completed concurrently or in any order.

SCHEDULED **UNSCHEDULED**

A = Satisfactory X = Unsatisfactory (Explanation required)	A or X	Observation/Corrective Action Taken
1. VERIFY roads to waste unit are accessible.	A	
2. VERIFY signs on the fence are in acceptable condition and are legible from a distance of 25 feet. Signs must include "Danger Unauthorized Personnel Keep Out" and include Post Closure Manager and Savannah River Site Operations Center contact information.	X	New signs have been ordered with Post Closure Manager info on them. SEE Map note 1: Reference Maintenance Register: PC-2024-00030

Metallurgical Laboratory Hazardous Waste Management Facility (HWMF) Post Closure Field Inspection Checklist

Manual: C3
 Procedure: ER-IDS-019-020
 Revision: 6
 Page: 2 of 4

SCHEDULED UNSCHEDULED

A = Satisfactory X = Unsatisfactory (Explanation required)	A or X	Observation/Corrective Action Taken
3. VERIFY fence is in good condition (e.g., shows no signs of serious wear, no vegetative growth) and unattended gates are locked.	A	
4. CHECK the soil cover and side slopes for signs of erosion, depression (subsidence) and evidence of burrowing animals.	A	
5. CHECK the integrity of drainage ditches for the presence of excessive erosion, sediment buildup, and any debris restricting water flow.	A	
6. VERIFY that no woody vegetation is growing on the soil cover, AND REMOVE OR IDENTIFY as needed.	A	
7. VISUALLY CHECK vegetative cover for grass density with no bare spots more than 3 feet by 3 feet in area. The height of the vegetation should not impair visual inspection of the soil cover. This will be determined by the Inspector.	A	
8. VISUALLY PERFORM a condition check of the survey benchmarks for damage and visibility.	A	
9. VERIFY annual topographic/subsidence survey has been performed by end of June for current year, AND VERIFY copies of survey results are in EC&ACP Document Control Center.	A	<p style="text-align: center;">Completed 06/11/2024</p> <p style="text-align: center;">SRNS-J2000-2024-00657</p>

Metallurgical Laboratory Hazardous Waste Management Facility (HWMF) Post Closure Field Inspection Checklist

Manual: C3
 Procedure: ER-IDS-019-020
 Revision: 6
 Page: 3 of 4

SCHEDULED UNSCHEDULED

A = Satisfactory X = Unsatisfactory (Explanation required)		A or X	Observation/Corrective Action Taken
10.	INSPECT A-08 Outfall Diversion Ditch for the presence of erosion and debris restricting water flow.	X	Vegetation needs herbicide applied in A-008 Diversion Ditch. See map note:2 reference maintenance register:PC-2024-00083
11.	Other None	A	

Inspected By		
Dylan Price (Print Name)	<i>Dylan Price</i> (Signature)	11/6/2024 (Date)

Reviewed By Post-Closure Manager		
Brian Hanshew (Print Name)	<i>BH</i> (Signature)	11/26/2024 (Date)

Map of Metallurgical Laboratory HWMF

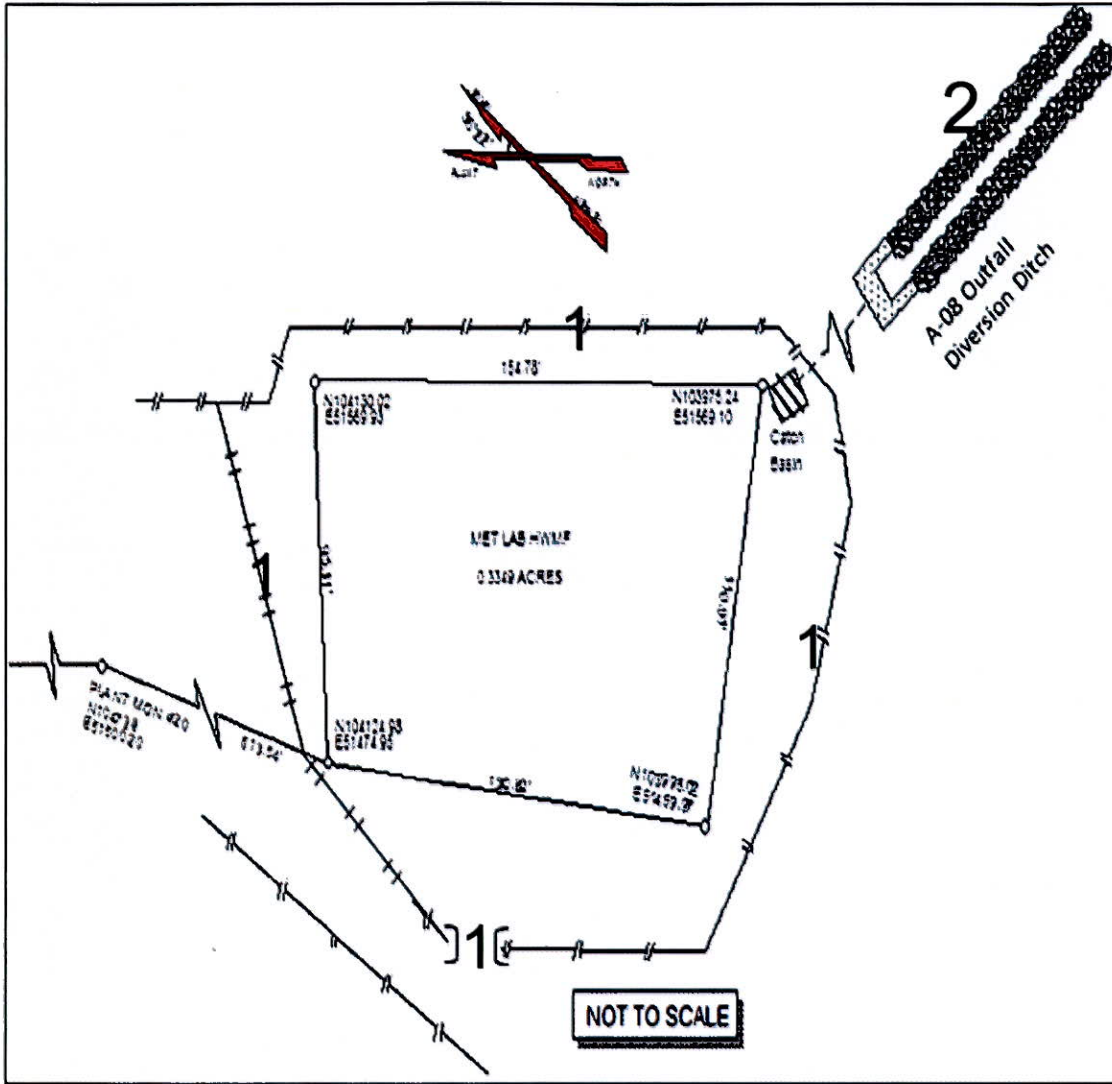

NOTES: NOTE 1: Ordered new Waste site signs with proper info on it. Maintenance register PC-2024-00030

Note 2: Vegetation needs herbicide applied in A-008 Diversion Ditch. Maintenance register: PC-2024-00083

No Further Entries

*TTP
11-6-24*