

**ENVIRONMENTAL COMPLIANCE & AREA COMPLETION PROJECTS (EC&ACP) STANDARD  
OPERATING PROCEDURES, VOL. I**
**Manual:** C3  
**Procedure:** ER-IDS-019-042  
**Revision:** 3  
**Effective Date:** 06/01/2016  
**Type-Class:** Form  
**Page:** 1 of 3

**H-AREA RETENTION BASIN FIELD INSPECTION CHECKLIST**
**WORKING COPY**

This document is a Working Copy. Prior to start of work, verify this is the latest revision per the Procedure Index.

*Charles P. Carter*

Verified By

01/19/2021

Date

**CAUTION**

The Inspector shall IMMEDIATELY notify the Post-Closure Manager and Environmental Compliance Authority if there has been a breach or compromise of the institutional controls of this waste unit. This notification shall be in accordance with Savannah River Site post-closure inspection procedures.

**NOTE**

1. Manual C3, ER-SOP-019, *Waste Unit Inspection and Maintenance*, shall be referred to for inspection details.
2. Monitoring wells associated with this waste unit are maintained in accordance with EC&ACP monitoring well procedures.
3. Steps in this checklist may be completed concurrently or in any order.

**SCHEDULED**

**UNSCHEDULED**

A = Satisfactory X = Unsatisfactory (Explanation required)		A or X	Observation/Corrective Action Taken
1.	Verify roads are accessible.	A	
2.	Verify waste unit signs (9) are in acceptable condition, have correct information, and are legible from a distance of 25 feet.	A	

H-Area Retention Basin Field Inspection Checklist

Manual: C3  
 Procedure: ER-IDS-019-042  
 Revision: 3  
 Page: 2 of 3

SCHEDULED  UNSCHEDULED

A = Satisfactory X = Unsatisfactory (Explanation required)		A or X	Observation/Corrective Action Taken
3.	Verify there are no excavation, digging, or construction activities on soil cover.	A	
4.	Check integrity of drainage ditches for presence of excessive erosion, sediment buildup, and any debris restricting water flow.	A	
5.	Verify no woody vegetating is growing on soil cover. Remove or identify as needed.	A	
6.	Visually check vegetative cover for grass density with no bare spots more than 3-feet by 3-feet in area. The height of vegetative cover should not impair visual inspection of soil cover. This will be determined by the Inspector.	A	
7.	Verify monuments have not been damaged.	A	
8.	Check soil cover for signs of erosion or depressions (subsidence).	A	
9.	Check for signs of burrowing animals.	X	Active ant mounds on soil cover See map note:2 Reference Miantenance Register: PC-2021-00006
10.	Other	<b>NO FURTHER ENTRIES</b>	

CPC 01/19/2021

Inspected By		
Charles P. Carter (Print Name)	<i>Charles P. Carter</i> (Signature)	01/19/2021 (Date)

Review By Post-Closure Manager		
George W. Joyner (Print Name)	<i>George W. Joyner</i> (Signature)	1/20/2021 (Date)

H-Area Retention Basin (281-3H) Operable Unit

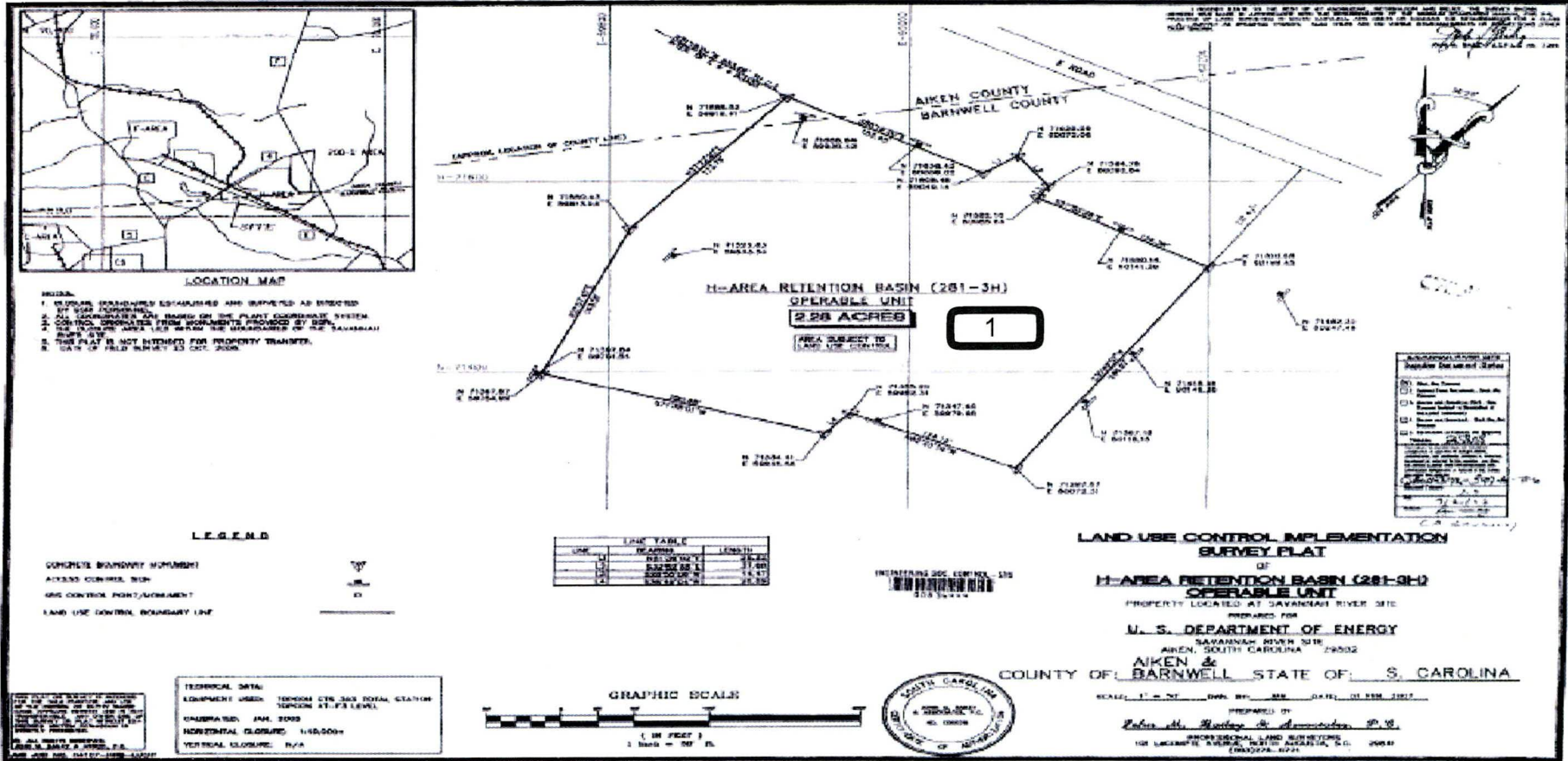

NOTES: 1=Active ant mounds on soil cover. Applied 1.0 lb.of Extinguish Ant Bait.

NO FURTHER ENTRIES

# POST CLOSURE MAINTENANCE REGISTER

**Index Number**

**Unit Name**

28 H-AREA RETENTION BASIN, 281-3H

**Watershed** FOURMILE BRANCH

AHA # AHA-ER-5534

Work Order # N/A

Work Group POST CLOSURE MAINTENANCE

Priority Medium

RCRA NO

**Maintenance Number** PC-2021-00006

**Maintenance Status** Complete

Inspection Date 1/19/2021

**Chemical Type** Pesticide

Completion Date 1/19/2021

**Chemical Name** Extinguish

**Amount Used** 1.0 Pounds

**Description Of Maintenance Item**

Active ant mounds on waste unit

**Maintenance Item Corrected**

Applied Extinguish pesticide

**Notes** New observation.

---

Approved by : George Joyner - ACP Post Closure Manager

Signature

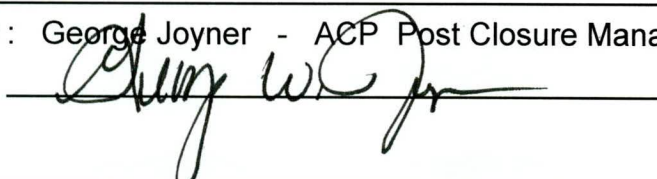

Approval date :

1/20/2021