

DPSP-83-1008

WASTE SITES ON THE
SAVANNAH RIVER PLANT

D. I. Ross - Health Protection
J. L. Green - Special Programs

January 5, 1983

**BEST AVAILABLE COPY
FOR ENTIRE DOCUMENT**

CONTENTS

INTRODUCTION & SUMMARY.....	1
DISCUSSION.....	1
WASTE SITES	
Radioactive - Basins.....	3
Nonradioactive - Basins.....	6
- Pits.....	11
- Piles.....	22
Mixed - Basins.....	25
- Pits.....	28
APPENDIX A	
Reference Maps showing locations of sites.....	31
APPENDIX B	
Reference Plant Maps available.....	44
INDEX	
List of waste Sites.....	49

INTRODUCTION & SUMMARY

This report lists all known waste disposal sites on the Savannah River Plant. The report describes the contents and identifies the location of 131 waste sites. Some of the sites contain radioactive waste. The other sites contain or may contain nonradioactive hazardous waste. In the context of this report, nonradioactive hazardous waste contains substances that may be harmful to man or may degrade the quality of ground water.

Health Protection began a compilation of waste disposal sites in 1972. As part of this program an extensive search has been made of plant records. Current and retired employees who have or had waste disposal responsibilities were interviewed. Health Protection personnel during their environmental monitoring activities traveled through the plant to locate the sites.

DISCUSSION

The terminology used in this compilation of waste sites is explained below:

Three waste categories, are used in this report:

- 1) Radioactive Waste Sites: Known to contain radioactive waste only. Examples are the 100-C seepage basins.
- 2) Non-radioactive Waste Sites: Known to contain or may contain hazardous waste. Examples are the area acid/caustic retention basins.
- 3) Mixed Waste Sites: Known to contain radioactivity and contain or have a potential for nonradioactive hazardous waste. Examples are the 200-H seepage basins and 643-G Burial Ground.

In each category waste may be stored¹ or disposed of in:

- 1) Pits: Excavated and designed for dry waste. An example is the 643-G Burial Ground.
- 2) Basins: Excavated and designed for the disposal of liquids. Examples are the 100-R seepage basins for radioactive waste, now backfilled.
- 3) Piles: Dry waste on the ground surface. An example is the non-radioactive waste at Military Gunsite # 72. If the waste is covered with soil, the site is classified in this report as a pit.

¹Temporary waste storage Buildings 710-U and 709-G are not included in this report.

Building Number: To ensure a file record, a building number was assigned for each un-numbered basin/pit. Numbering of sites was coordinated with the Master Building List Custodian. Piles of waste were not assigned building numbers.

Content: Describes the content of the basin, pit or pile. Additional evidence of content is offered through the representative reference photographs listed under this heading. Photographs can be obtained from PRD. Additional Health Protection photographs are in the indexed file in the Environmental Collections office in 735-9A. More recent photographs of many permanent sites are available from Special Programs, 703-34A, which maintains a full catalog of EG&G aerial photographs.

Location And Coordinates: A brief description of the waste site location. Also given is a reference map number for a map located in Appendix A. The map shows all waste sites within the map's area. Specific location is shown under coordinates which identifies the exact location on larger Plant maps.

Where a basin/pit was backfilled, and no print coordinates were available, coordinates were estimated which include the location of the basin/pit within the marked area. Therefore, the size of site as indicated by coordinates may sometimes be slightly larger than the basin/pit.

Size: Usually indicates the site ground surface dimensions (length by width). However, where the size is irregular, the dimension of all sides are given. Sometimes acreage or volume is given.

Open/Closed: An open pit or basin is open to the atmosphere or uncovered. Closed indicates that it is covered with soil.

DIR:JLG:ace

RADIOACTIVE WASTE

Stored in Basins

BLDG NO.	CONTENT	LOCATION	SIZE	OPEN	CLOSED	COORDINATES	
						N	E
RP ↓ 904-57G (100-R S.B.#3) ²	Aqueous Waste ¹ from 105-R sumps, tanks, and drums. Ref. photo: 17469-19	North of Bldg. 105-R, outside perimeter fence. Ref. map: U-19	30'x300'		X	58,387.73 58,385.63 58,084.44 58,085.90	74,872.60 74,903.09 74,873.38 74,904.64
904-58G (100-R S.B.#4)	Aqueous Waste ¹ from 105-R sumps, tanks, and drums. Ref. photo: 17469-20	North of Bldg. 105-R, outside perimeter fence. Ref. map: U-19	35'x308'		X	58,584.99 58,563.48 58,303.39 58,324.61	75,103.57 75,131.30 74,936.68 74,908.37
904-59G (100-R S. B.#5)	Aqueous Waste ¹ from 105-R sumps, tanks, and drums. Ref. photo: 17469-21	North of Bldg. 105-R, outside perimeter fence. Ref. map: U-19	40'x300'		X	58,508.15 58,460.20 58,461.21 58,502.19	75,486.39 75,486.94 75,115.86 75,114.91
904-60G (100-R S.B.#6)	Aqueous, Waste ¹ from 105-R sumps, tanks, and drums. Ref. photo: 17469-22	North of Bldg. 105-R, outside perimeter fence. Ref. map: U-19	45'x500'		X	58,146.13 58,093.38 58,096.94 58,147.84	75,586.80 75,588.86 75,001.58 75,002.52
904-103G (100-R S.B.#1)	Aqueous Waste ¹ from 105-R sumps, tanks, and drums. Ref. photo: 17469-17	North of Bldg. 105-R, outside perimeter fence. Ref. map: U-19	30'x400'		X	57,787.82 57,794.43 57,580.50 57,580.40 57,767.45 57,760.74	74,691.16 74,878.87 74,882.46 74,848.91 74,846.66 74,694.79
904-104G (100-R S.B.#2)	Aqueous Waste ¹ from 105-R sumps, tanks, and drums. Ref. photo: 17469-18	North of Bldg. 105-R, outside perimeter fence. Ref. map: U-19	45'x200'		X	58,020.04 58,022.69 57,796.43 57,797.65	74,839.98 74,889.46 74,898.79 74,852.29

¹Fission and activation products

²S.B. aboreviation for seepage basin

RADIOACTIVE WASTE, cont'd

Stored in Basins, cont'd

BLDG. NO.	CONTENT	LOCATION	SIZE	OPEN	CLOSED	COORDINATES	
						N	E
RP ↓ 904-61G (100-P S.B.#1)	Aqueous waste ¹ from 105-P sumps, tanks, and drums. Ref. photo: 17469-23	East of Bldg. 105-P, outside perimeter fence. Ref. map: U-19	35'x400' (5.1x10 ⁵ gal)	X		43,551	64,021
						43,556	64,274
						43,507	64,278
						43,511	64,060
						43,341	64,060
43,340	64,020						
904-62G (100-P S.B.#2)	Aqueous waste ¹ from 105-P sumps, tanks, and drums. Ref. photo: 17469-24	East of Bldg. 105-P, outside perimeter fence. Ref. map: U-19	70' x 209' (5.2x10 ⁵ gal)	X		43,564	63,792
						43,571	64,003
						43,502	64,005
						43,494	63,798
904-63G (100-P S.B.#3)	Aqueous waste ¹ from 105-P sumps, tanks, and drums. Ref. photo: 17469-25	East of Bldg. 105-P, outside perimeter fence. Ref. map: U-19	66' x 333' (1.5x10 ⁶ gal)	X		43,561	63,407
						43,568	63,743
						43,493	63,748
						43,495	63,410
904-64G (100-L S.B.)	Aqueous waste ¹ from 105-L sumps, tanks, and drums. Ref. photo: 17471-24,-25	South of Bldg. 105-L, outside perimeter fence. Ref. map: T-18	35'x400' (5.3x10 ⁵ gal)	X		45,410	50,565
						45,410	50,600
						45,225	50,600
						45,225	50,765
						45,210	50,765
45,210	50,565						
904-65G (100-K S.B.)	Aqueous waste ¹ from 105-K sumps, tanks, and drums. Ref. photo: 17471-15	West of Bldg. 105-K, outside perimeter fence. Ref. map: S-17	69' x 134' (3.8x10 ⁵ gal)	X ²		54,100	39,716
						(Northernmost corner)	
904-88G (100-K Con- tainment)	Receives purge water that previously went to 100-K seepage basin. Ref. photo: 17471-14	North side of 100-K, outside perimeter fence. Ref. map: T-18	559' x 616' (50x10 ⁶ gal)	X		55,016	40,728 (Southeast corner)

¹Fission and activation products

²Inactive

RADIOACTIVE WASTE, cont'd

Stored in Basins, cont'd

BLDG NO.	CONTENT	LOCATION	SIZE	OPEN	CLOSED	COORDINATES	
						N	E
RP ↓ 904-66G (100-C S.B.#1)	Aqueous Waste ¹ from 105-C sumps, tanks, and drums. Ref. photo: 17551-20,-21	Northwest of 100-C effluent canal, south of Road A-7. Ref. map: M-12	35'x394' (4.6x10 ⁵ gal.)	X		67,765	44,730
						67,765	44,940
						67,550	44,940
						67,550	44,890
						67,715	44,890
67,715	44,730						
904-67G (100-C S.B.#2)	Aqueous Waste ¹ from 105-C sumps, tanks, and drums. Ref. photo: 17551-18	Northwest of 100-C effluent canal, south of Road A-7. Ref. map: M-12	55'x300' (9.3x10 ⁵ gal.)	X		67,392	44,717
						67,692	44,171
						67,692	44,772
						67,392	44,772
904-68G (100-C S.B.#3)	Aqueous Waste ¹ from 105-C sumps, tanks, and drums. Ref. photo: 17551-19	Northwest of 100-C effluent canal, south of Road A-7. Ref. map: M-12	80'x150' (7.0x10 ⁵ gal.)	X		67,347	44,792
						67,427	44,792
						67,427	44,942
						67,347	44,942
65 ↓	281-3F	Contaminated return water to retention basin. Ref. photo: 17469-13; 17736-11	Outside and south of area perimeter fence, east of Bldg 281-8F. Ref. map: M-12	120'x200'	X ²	76,322 (Northernmost Corner)	53,703
↓	281-3H	Contaminated return water to retention basin. Ref. photo: 17469-11; 17736-48	On southwest side of Road E, near inter- section with Road 4. Ref. map: N-13	120'x200'	X ³	71,490.09 71,387.51 71,491.28 71,595.86	60,119.19 60,056.93 59,885.96 59,948.23

¹Fission and activation products

²Contaminated soil moved to Burial Ground and basin backfilled.

³Inactive

NONRADIOACTIVE WASTE

Stored in Basins, cont'd

SW

BLDG NO.	CONTENT	LOCATION	SIZE	OPEN	CLOSED	COORDINATES	
						N	E
188-2C (Ash basin)	Ashes from 100-C powerhouse. Ref. photo: 35199-5	East of 100-C, just outside perimeter fence. Ref. map: M-12	422'x1322'x 238'x419'x 950'	X		68,343.7 (Northeast Corner)	47,437.5
188-K (Ash Basin)	Ashes from 100-K powerhouse. Ref. photo: 17357-13, -14,-15	Between Road B and southwest corner of area perimeter fence. Ref. map: S-17	522'x800'x 275'x575'x 688'	X		53,121.8 52,801.2 52,000.0 52,000.0 52,462.5	39,687.5 40,100.0 40,100.0 39,828.1 39,490.0
188-L (Ash basin)	Ashes from 100-L powerhouse. Re. photo: 17471-19,20	North of 100-L. Between Road 7 and road C-6. Ref. map: T-18	775'x950'x 550'x525'x 663'	X ¹		49,630.0 49,630.0 48,680.0 48,515.0 49,970.0	51,280.0 52,060.0 52,060.0 51,540.0 51,280.0
188-P (Ash Basin)	Ashes from 100-P powerhouse. Ref. photo: 17357-9,-10, -11,-12	South of 100-P. Ref. map: U-19	700'x800'	X		41,100.0 (Northeast Corner)	65,800.0
188-R (Ash Basin)	Ashes from 100-R powerhouse. Ref. photo: 17355-9,-10	South of Road G, opposite southwest corner of perimeter fence. Ref. map: U-19	485'x710'x 875'x413'x 700'	X ¹		55,115.6 (Northeast Corner)	74,000.0
288-F (Ash Basin)	Ashes from 200-F powerhouse. Ref. photo: 17357-3,-4,-5	East of 200-F, opposite Bldg. 284-F. Ref. map: M-12	300'x1013'	X		78,095.69 77,465.69 77,230.0 77,860.0	55,565.61 56,365.61 56,180.0 55,380.0

¹Inactive

NONRADIOACTIVE WASTE, cont'd

7

Stored in Basins, cont'd

BLDG NO.	CONTENT	LOCATION	SIZE	OPEN	CLOSED	COORDINATES	
						N	E
sw ↓ 288-1F (Ash Basin)	Ashes from 200-F powerhouse. Ref. photo: 35199-1	East of 200-F, opposite southeast corner of coal pile. Ref. map: M-12	300'x500'	X		77,700 77,700 77,200 77,200	55,100 54,800 55,100 54,800
288-H (Ash Basin)	Ashes from 200-H powerhouse. Ref. photo: 34701-5;17357- 6,-7,-8; 17736-50,-51	On southwest side of Road E, opposite waste tanks 50 and 51. Ref. map: N-13	569'x663'x 570'x1163'x 256'	X		70,156.2 (Westernmost Corner)	61,318.7
488-D (Ash Basin)	Ashes from 400-D powerhouse. Ref. photo: 17355-37,-38,-39; 35199-16,-17	Outside the perimeter fence, on the west side of 400-D, opposite the coal pile. Ref. map: K-10	1040'x1850'	X ¹		63,800 (Southeast Corner)	19,240
488-1D (Ash Basin)	Ashes from 400-D powerhouse. Ref. photo: 35199-18	Southwest of the 400-D perimeter fence, south of Bldg. 488-2D. Ref. map: K-10	1050'x1425'	X		62,280.0 (Southwest Corner)	17,650.0
488-2D (Ash Basin)	Ashes from 400-D powerhouse. Ref. photo: 35199-19	West of the 400-D perimeter fence, opposite the south end of the coal pile. Ref. map: K-10	410'x1530'	X		63,800 (Southwest Corner)	17,660
788-2A (Ash Basin)	Ashes from 700-A powerhouse. Ref. photo: 35199-22	On the northwest side of Road C-1 between 300-M and Road C. Ref. map: F-6	179'x328'	X ²		98,733.6 98,646.6 98,929.3 98,010.8	44,478.2 44,675.6 44,801.3 44,685.4

¹Inactive²This active basin is located on top of two backfilled rubble pits, designated as 731-A.

NONRADIOACTIVE WASTE, cont'd

8

Stored in Basins, cont'd

BLDG NO.	CONTENT	LOCATION	SIZE	OPEN	CLOSED	COORDINATES	
						N	E
189-C (CSRCB) ¹	Coal storage rainwater runoff. Ref. photo: 34701-9,-10	South of 100-C, opposite southeast corner of perimeter fence. Ref. map: M-12	169'x169'	X		65,400.0 (Northeast Corner)	47,087.5
189-K (CSRCB)	Coal storage rainwater runoff. Ref. photo: 34701-11,-12	Between Road B-3 and west side of 100-K perimeter fence. Ref. map: S-17	294'x294'	X		53,300.0 (Northeast Corner)	39,490.6
189-P (CSRCB)	Coal storage rainwater runoff. Ref. photo: 34701-6,-7	Outside south end of 100-P perimeter fence, opposite Bldg. 185-P. Ref. map: U-19	291'x291'	X		42,106.2 (Northeast Corner)	65,112.5
289-F (CSRCB)	Coal storage rainwater runoff. Ref. photo: 34701-4	East of 200-F and north of railroad track into area. Ref. map: M-12	220'x220'	X		76,769 76,769 76,549 76,549	54,988 54,768 54,988 54,768
289-H (CSRCB)	Coal storage rainwater runoff. Ref. photo: 35199-2	East of 200-H and north of railroad track into area. Ref. map: N-13	225'x180'	X		71,155 71,155 71,380 71,380	64,013 63,833 64,013 64,833
489-D (CSRCB)	Coal storage rainwater runoff. Ref. photo: 34701-13,-14	Outside perimeter fence at southwest corner of 400-D. Ref. map: L-11	2.9 Acres	X		63,200 (Near Center)	20,500
788-3A (CSRCB)	Coal storage rainwater runoff. Ref. photo: 34701-2,-3	Southeast of Bldg. 716-A, outside perimeter fence. Ref. map: B-2	410'x410'	X		102,190 (Southeast Corner)	51,530

¹Coal Storage Runoff Containment Basin.

NONRADIOACTIVE WASTE, cont'd

9

Stored in Basins, cont'd

BLDG. NO.	CONTENT	LOCATION	SIZE	OPEN	CLOSED	COORDINATES	
						N	E
GS 904-74G	Acid-caustic solutions from 284-F. Ref. photo: 17355-6	East of 200-F, outside perimeter fence, and near Bldg. 288-F. Ref. map: M-12	60' x 60'	X		78,109.4 (Northernmost corner)	55,346.8
GS 904-75G	Acid-caustic solutions from 284-H. Ref. photo: 17355-8	West of Bldg. 244-H (RBOF). Ref. map: N-13	50' x 50'	X		72,201.2 (Northwest corner)	61,331.2
RP 904-77G	Acid-caustic solutions from 184-R. Ref. photo: 17355-19	South of Road G, opposite southwest corner of Bldg. 183-1R. Ref. map: U-19	50' x 50'	X ¹		55,112 (Northernmost corner)	74,584
RP 904-78G	Acid-caustic solutions from 184-P. Ref. photo: 17355-26	East of 100-P, on east side of Road F. Ref. map: U-19	60' x 60'	X		43,540.6 (Northwest corner)	66,843.7
RP 904-79G	Acid-caustic solutions from 184-L. Ref. photo: 17471-27	Southeast of Bldg. 105-L, outside perimeter fence. Ref. map: T-18	60' x 60'	X		45,300 (Northeast corner)	51,234
RP 904-80G	Acid-caustic solutions from 184-K. Ref. photo: 17355-27	East of Road 6-4.21, north of railroad track entering through 100-K perimeter fence Ref. map: T-18	60' x 60'	X		53,185 (Northwest corner)	42,647

¹Inactive

NONRADIOACTIVE WASTE, cont'd

10

Stored in Basins, cont'd

BLDG NO.	CONTENT	LOCATION	SIZE	OPEN	CLOSED	COORDINATES	
						N	E
<i>WAAH</i> 731-5A	Miscellaneous chemicals. Ref. photo: 17931-10	On northwest side of Road C-1, between 300-M and Road C. Ref. map: F-6	400' sq.		X ¹		
<i>WAAH</i> 631-G (400-D Oil Basin)	Process seal oil. Ref. photo: 17355-40	South side of Road A-4.4, near 400-D. Ref. map: L-11	54'x383'	X ²		68,543.83 68,610.82 68,576.34 68,507.28	23,769.22 23,598.66 23,593.49 23,763.57
<i>WAAH</i> 904-101G (716-A S.B.)	Grease, oil, water, degreasers. Ref. photo: 34701-1	South of Bldg. 716-A, below railroad track. Ref. map: b-2	35'x207'	X		102,018	50,531 (Southernmost Corner)
<i>W6H</i> 904-110G (723-A S.B.)	Chemicals from 723-A metallurgical laboratory. Ref. photo: 34772-11	West of Bldg. 745-A, outside area perimeter fence. Ref. map: b-2	68'x128'	X		104,114.0	51,556.0 (Northeast Corner)
<i>JCL</i> 904-113G	Burnable waste oils. Ref. photo: 35199-28 <i>Burnable Pit 1st</i>	In Central Shops, northeast of Bldg. 690-G (Ford Bldg.). Ref. map: M-12	30'x50'	X		61,100	52,490 (Estimated Center)

¹The coordinates of this shallow basin are unknown but lie within the boundary coordinates of Bldg. 731-4A, metals burning site, listed on page 17.

²Inactive

NONRADIOACTIVE WASTE, cont'd

11

Stored in Pits

BLDG NO.	CONTENT	LOCATION	SIZE	OPEN	CLOSED	COORDINATES	
						N	E
RP ↓ 131-C	Rubble: paper, lumber, cans, barrels, miscellaneous scrap/trash. Originally a burning pit. Ref. photo: 17355-20; 17493-20; 18796-54	Near 100-C, north of Road A-7 and near containment basin berm. Ref. map: M-12	175 X 390'		X	68,612.0	44,335.0
						68,651.2	44,342.7
						68,660.0	44,090.0
						69,699.2	44,097.7
131-K	Rubble: paper, lumber, cans, barrels. Originally a burning pit. Ref: photo: 17355-28; 17704-11	East of 100-K, between Road 6-4.21 and Road 6-4.2. Ref. map: T-18	34' X 232'		X	54,503.9	42,550.7
						54,478.4	42,532.7
						54,329.1	42,706.6
						54,354.2	42,726.3
131-L (Pit#1)	Rubble: paper, lumber, cans, barrels, batteries. Originally a burning pit. Ref. photo: 17471-21,-22	Northwest of 100-L, east of Road 7-1. Ref. map: T-18	29' X 230'		X	48,492.1	49,050.5
						48,481.1	49,025.9
						48,271.4	49,116.7
						48,282.2	49,141.2
131-1L (Pit#2)	Rubble: metal, lumber, poles, concrete, transite (originally on ground surface). Ref. photo: 17471-28,-29,-30	East of 100-L, adjacent to the RBOF cask storage pad. Ref. map: T-18	50'x220'		X	46,350	52,630 (Estimated Center)
131-3L (Pit#3)	Rubble: miscellaneous. Ref. photo: 35199-7,-8	East of the intersection of Road 7-1 and Pen Branch (near steam line). Ref. map: T-18	140'X 320'		X	50,766.39	47,188.86
						50,476.70	47,694.99
						50,673.26	47,112.50
						50,161.72	47,664.03
RP 131-4L (Pit #4)	Rubble: concrete and metal from power house stack and silo. Ref. photo: 17551-8	Northeast of 100-L, between Road C-7 and the railroad. Ref. map: T-18	55'x56'		X	47,612.5	52,730.0
						47,612.5	52,785.0
						47,556.5	57,730.0
						47,556.5	52,785.0

NONRADIOACTIVE WASTE, cont'd

12

Stored in Pits, cont'd

BLDG NO.	CONTENT	LOCATION	SIZE	OPEN	CLOSED	COORDINATES	
						N	E
RP ↓ 131-P	Rubble: paper, lumber, cans, barrels, etc. Originally a burning pit. Ref. photo: 17355-23	Northwest of 100-P, between effluent canal to Steel Creek and Road C-7. Ref. map: U-19	219'x319'		X	45,512 45,365 45,211 45,258	63,440 63,738 63,697 63,400
131-R (Pit #1)	Rubble: paper, lumber, cans, barrels, etc. Originally a burning pit. Ref. photo 17533-18,-33	South of 100-R and Road G; southeast of Road F-8. Ref. map: U-19	21'x238'		X ¹	54,557.1 54,541.2 54,370.7 54,351.7	75,718.9 75,694.4 75,851.2 75,825.5
131-1R (Pit #2)	Rubble: paper, lumber, cans, barrels, etc. May have been used for burning. Ref. photo: 17533-18,-31,-32	South of 100-R and Road G; southeast of Road F-8. Ref. map: U-19	33'x236'		X ²	54,534.2 54,525.2 54,344.3 54,327.9	75,685.3 75,664.4 75,812.3 75,795.7
131-2R (Pit #3)	Rubble: metal, concrete, lumber, poles, etc. Originally on ground surface. Ref. photo: 17355-11	North of 100-R perimeter fence and west of 100-R seepage basin #1 (904-57G). Ref. map: U-19	115'x184'		X	57,742.8 57,643.1 57,613.1 57,724.5	74,274.6 74,296.9 74,111.4 74,091.8

¹Permanently marked with pylons. Trench was outlined by drilling. Soil samples showed no radioactive contamination.

²Inactive

NONRADIOACTIVE WASTE, cont'd

13

Stored in Pits, cont'd

BLDG NO.	CONTENT	LOCATION	SIZE	OPEN	CLOSED	COORDINATES	
						N	E
65 ↓ 231-F (Pit #1)	Rubble: metals, concrete, lumber, poles etc. Originally a burning pit. Ref. photo: 17355-4	End of dirt road, north of the 200-F entrance road. Ref. map: M-12	74'x275'		X	79,332.2 79,328.6 79,618.9 79,647.1	50,723.7 50,802.7 50,716.5 50,800.1
231-1F (Pit #2)	Rubble: metal, concrete, lumber, poles, etc. Originally a burning pit. Ref. photo: 17355-4	End of dirt road, north of 200-F entrance road. Ref. map: M-12	68'x275'		X	79,335.4 79,332.2 79,597.8 79,618.9	50,662.8 50,723.7 50,645.9 50,716.5
231-2F 321-#3 (Pit #3)	Rubble: concrete, lumber cement, fence and telephone poles, rip rap, brick, tile, wall board, paneling, metal scrap and shavings, drums, electrical conduit, furniture, firehose. Part of area is now used for burning and is designated as 231-3F. Ref. photo: 17355-5; 18796-16, -18, -19, -20, -39, -40, -41, -42, -43, -45, -46, -49	End of dirt road, north of 200-F entrance road. Ref. map: M-12	261'x509'		X	79,122.9 79,144.9 79,405.8 79,733.3 79,781.9	51,088.9 51,159.4 51,115.6 51,162.1 50,921.7
JCL 231-4F (Burma Road)	Rubble: metal, concrete, lumber, poles, fluorescent light fixtures, glass, etc. Ref. photo: 35199-14	West of Road C, south of Burma Road. Ref. map: M-12	160'x500'	X		77,367 77,467 77,163 77,312	50,573 50,520 50,083 50,036

NONRADIOACTIVE WASTE, cont'd

14

Stored in Pits, cont'd

BLDG NO.	CONTENT	LOCATION	SIZE	OPEN	CLOSED	COORDINATES	
						N	E
<i>SW</i> 431-D (Pit #1)	Rubble: metal, concrete, lumber, poles, etc. Originally a burning pit. Ref. photo: 17355-36	North side of ash paved road connecting Road A-4 with Road A-4.7. Ref. map: K-10	51'x222'		X	66,504.4 66,558.3 66,660.4 66,693.4	18,578.7 18,594.9 18,349.1 18,370.1
<i>SW</i> 431-1D (Pit #2)	Rubble: metal, concrete, lumber, poles, etc. Originally a burning pit. Ref. photo: 17355-36	North side of ash paved road connecting Road A-4 with Road A-4.7. Ref. map: K-10	38'x242'		X	66,544.2 66,646.4 66,711.6 66,751.3	18,562.0 18,625.7 18,398.5 18,429.5
<i>SW</i> 431-2D (Pit #3)	Rubble: metal, concrete, lumber, poles, etc. Originally on ground surface. Ref. photo: 17355-35	South side of ash paved road connecting Road A-4 with Road A-4.7. Ref. map: K-10	232'x388'		X	66,393.0 66,345.7 66,221.9 66,163.6 66,672.0 66,787.0	18,598.8 18,854.9 19,040.5 18,712.6 18,646.8 18,542.1

NONRADIOACTIVE WASTE, cont'd

Stored in Pits, cont'd

15

BLDG NO.	CONTENT	LOCATION	SIZE	OPEN	CLOSED	COORDINATES	
						N	E
631-1G <i>JCL</i>	Rubble: paper, cans, lumber, barrels etc. Originally a burning pit. Ref. photo: 18796-51,53	Northeast of Central Shops, between Road C and Road 5. Ref. map: M-12	30'x200'		X	64,600 (Estimated Center)	52,790 ¹
631-3G <i>JCL</i>	Rubble: paper, cans, lumber, barrels, metal pipe and shavings electrical switchgear, etc. Ref. photo: 35199-12	Northeast of Central Shops, area between Road C and Road 5. Ref. map: M-12	50'x400'	X		65,095.25 65,156.68 64,728.77 64,712.54	53,160.61 53,250.56 53,441.19 53,377.11
631-5G <i>JCL</i>	Rubble: paper, lumber, cans, barrels, etc. Originally a burning pit. Ref. photo: None	Northeast of Central Shops, south of the intersection of Road 5 and Road A-6. Ref. map: M-12	35'x385'		X	64,968 (Northeast Corner)	52,102
631-6G <i>JCL</i>	Rubble: paper, cans, lumber barrels, etc. Originally a burning pit. Ref. photo: None	Southeast of Bldg. 690-G (Ford Bldg.) just north of railroad track. Ref. map: M-12	30'x290'		X	60,365 (Northeast Corner)	52,912
631-7G <i>JCL</i>	Rubble: miscellaneous materials. Ref. photo: 35199-29,-30	Shantytown area, south of Central Shops. Ref. map: M-12	This site occupies same general area as 080-16G.		X	61,922 (Northernmost corner)	49,372
631-8G <i>MAH</i>	Rubble: concrete, asphalt, tree trunks, poles. Ref. photo: 35199-20,-21	West of Road A-4.7, northeast of Bldg. 681-3G (River Pump house 3G). Ref. map K-10	379'x311'x110' x143'	X		67,500 (Estimated Center)	17,100

¹ This is an estimated coordinate; the pit is to the left and at the end of the entrance road, nearly parallel to the drainage ditch.

NONRADIOACTIVE WASTE, cont'd

16

Stored in Pits, cont'd

*garage
road
landfill*

BLDG. NO.	CONTENT	LOCATION	SIZE	OPEN	CLOSED	COORDINATES	
						N	E
<i>MAA</i> 731-A (Pit #1)	<i>garage road</i> Rubble: paper, lumber, cans, barrels, etc. Originally a burning pit. Ref. photo: 17355-3; 17493-1; 18796-15	On northwest side of Road C-1, between 300-M and Road C. Ref. map: F-6	179' x 328'		X ¹	98,733.6 98,646.6 98,929.3 99,010.8	44,478.2 44,675.6 44,801.3 44,685.4
<i>MAA</i> 731-1A (Pit #2)	Rubble: paper, lumber, cans, barrels, etc. Originally a burning pit. Ref. photo: 17355-2; 18796-1,-6	On northwest side of Road C-1, between 300-M and Road C. Ref. map: F-6	31' x 572'		X	99,129.9 99,147.3 98,677.6 98,665.2	44,672.2 44,646.9 44,352.4 44,380.4
<i>MAA</i> 731-2A (Pit #3)	Rubble: paper, wooden pallets, cans, drums, glass, etc. Ref. photo: None	On northwest side of Road C-1, between 300-M and Road C. Ref. map: F-6	38' x 647'	X		99,208.8 99,232.3 98,677.7 98,662.7	44,629.9 44,600.1 44,253.9 44,284.8
<i>DG</i> 731-3A (Silverton Road)	Rubble: lumber, cans, barrels, tires, brick, concrete, asbestos, etc. Ref. photo: 17493-4,-5, -6,-7; 17736-53,-54,-55; 17872-3; 34772-3,-4	On southwest side of Road C-1.1, near Road 1. Ref. map: B-2	203' x 695'		X	103,415.85 103,225.73 103,790.19 103,602.47	41,875.80 41,210.48 41,249.42 41,795.25

¹There are two closed pits, both designated by 731-A, located under the 788-2A ash basin. The center of each of the two pits is marked by posts. The size and coordinates shown here are actually the corners of the ash basin.

NONRADIOACTIVE WASTE, cont'd

Stored in Pits, cont'd

17

BLDG NO.	CONTENT	LOCATION	SIZE	OPEN	CLOSED	COORDINATES	
						N	E
080-16G (SRL Test Site) ¹ JCU	Biodegraded oil. Ref. Photo: 35199-29,-30; 18076-2,-3,-4	West of Central Shops. Ref. map: M-12	500'x600'		X	61,922 (Northernmost	49,372 Corner)
080-17G (CMP Pit) ² DG	Pesticide containers(some with pesticides). Ref. Photo: 17435-9; 34772-12	West of Road C, north of Road 7. Ref. map: T-18	15x55'		X	51,638.8 51,599.9 51,589.2 51,628.1	53,864.6 53,904.1 53,893.6 53,854.1
080-17.1G (CMP Pit) ² DG	Pesticide containers (some with pesticides), fluorescent light ballasts, PCB cleanup materials. Ref. Photo: 18802-3; 34772-12	West of Road C, north of Road 7. Ref. map: T-18	10'x44'		X	51,573.0 51,541.4 51,534.4 51,566.0	53,830.0 53,860.8 53,853.6 53,822.8
080-18G (CMP Pit) ² DG	Miscellaneous oils and chemicals. Ref. Photo: 34772-12	West of Road C, north of Road 7. Ref. map: T-18	10'x60'		X	51,590.7 51,546.9 51,540.1 51,583.9	53,917.5 53,957.8 53,950.4 53,910.1
080-18.1G (CMP Pit) ² DG	Miscellaneous oils and chemicals. Ref. Photo: 34772-12	West of Road C, north of Road 7. Ref. map: T-18	12'x45'		X	51,621.0 51,589.0 51,580.5 51,612.5	53,785.8 53,816.8 53,808.2 53,777.2

¹This test site was used for biodegrading waste oil. The Fire Department oil basin, located near 709-F and use for training, was dug up (including contaminated soil) and deposited here. This is also true of several spills that have occurred in recent years.

²There are other CMP Pits containing metals and miscellaneous organics on pages 18 and 19.

NONRADIOACTIVE WASTE, cont'd

18

Stored in Pits, cont'd

BLDG NO.	CONTENT	LOCATION	SIZE	OPEN	CLOSED	COORDINATES	
						N	E
080-18.2G (CMP Pit) ¹ <i>DG</i>	Miscellaneous oils and chemicals including chlorinated organics. Ref. Photo: 34772-12	West of Road C, north of Road 7. Ref. map: T-18	10'x45'		X	51,667.7 51,635.4 51,628.5 51,660.7	53,740.6 53,771.9 53,764.7 53,733.4
080-18.3G (CMP Pit) ¹ <i>DG</i>	Miscellaneous oils and chemicals including chlorinated organics. Ref. Photo: 34772-12	West of Road C, north of Road 7. Ref. map: T-18	15'x110'		X	51,723.9 51,650.1 51,639.5 51,717.3	53,775.5 53,855.5 53,842.7 53,764.9
631-4G <i>JCC</i>	Hydrofluoric acid. Ref. photo: 17551-13; 18802-1	West of cement plant in Central Shops, south of Road 3. Ref. map: M-12	30'x30'		X	61,749.0 61,779.5 61,782.8 61,752.7	50,198.2 50,200.6 50,171.8 50,167.9

¹There are other CMP Pits containing metals, miscellaneous organics, and pesticides on pages 17 and 19.

²Miscellaneous oils and chemicals stored at 080-15G (concrete pad) in Central Shops were removed to this pit in 1978-79. 080-15G is not listed in this report because this site, beyond the curbed pad, is not considered a problem. T&T is also in the process of removing the building designation.

NONRADIOACTIVE WASTE, cont'd

Stored in Pits, cont'd

19

BLDG NO.	CONTENT	LOCATION	SIZE	OPEN	CLOSED	COORDINATES	
						N	E
08U-19G (CMP Pit) ¹	<i>DG</i> Hazardous metals. Ref. photo: 34772-12	West of Road C, north of Road 7. Ref. map: T-18	10'x48'		X	51,539.0 51,503.7 51,496.3 51,531.6	53,864.0 53,896.1 53,889.4 53,857.3
731-4A	<i>MAH</i> Hazardous metals (scrap). Originally a metal burning pit. Ref. photo: 17493-8;-9; 17736-1; 17872-7,-8	On northwest side of Road C-1, between 300-M and Road C. Ref. map: F-6	124'x378'		X	97,440.47 97,687.27 97,761.78 97,741.08 97,814.70 97,693.58	44,338.64 43,967.04 44,150.11 44,212.71 44,366.54 44,505.24
131-2L	<i>RP</i> Empty compressed gas cylinders. Ref. photo: 35199-9	Adjacent to 131-L, inside fenced area; separately chained Ref. map: T-18	14'x27'		X	48,459.77 48,451.82 48,461.91 48,470.53	49,004.30 48,980.79 48,977.94 49,000.15

¹There are other CMP Pits containing pesticides and miscellaneous organics on pages 17 and 18.

NONRADIOACTIVE WASTE, cont'd

Stored in Pits, cont'd

20

BLDG NO.	CONTENT	LOCATION	SIZE	OPEN	CLOSED	COORDINATES	
						N	E
080-20G (400-D) <i>SW</i>	Asbestos, metal pipe, scrap from bubble towers. Ref. photo: 17355-34; 17919-14	North of Road A-4.61, near 400-D. Ref. map: L-11	556'x294'x 503'x160x 100'		X	66,747 (Northeast Corner)	21,797
080-21G (100-C#1) <i>RP?</i>	Asbestos, metal pipe, plastic bags, piping insulation. Ref. photo: 35199-4	Off Road A-6.2, north- east of 100-C. Ref. map: M-12	60'x300'		X	69,212 69,512 69,212 69,512	49,625 49,625 49,685 49,685
080-22G (100-C#2) <i>RP?</i>	Asbestos, metal pipe, plastic bags, piping insulation. Ref. photo: 35199-5	Off Road A-6.2 north- east of 100-C. Ref. map: M-12	60'x300'	X		69,212 69,512 69,212 69,512	49,685 49,685 49,745 49,745
080-1K (100-R) <i>RP</i>	Asbestos and metal pipe. Ref. photo: 35199-32	West of Bldg 105-R. Ref. map: U-19	70'x280'		X	57,120 (Northeast Corner)	74,700

NONRADIOACTIVE WASTE, cont'd

21

Stored in Pits, cont'd

BLDG NO.	CONTENT	LOCATION	SIZE	OPEN	CLOSED	COORDINATES	
						N	E
740-G (Sanitary Landfill)	Putrescible waste. Ref. photo: 17395-14,-16	West of Road C, between clover leaf and Upper Three Runs Creek. Ref. map: F-6	17 acres		X ¹	85,068	45,162
			15 acres			85,168	45,713
			+ 10 acres			85,161	45,923
						85,052	45,523

MAH

NE adj. to treatment

55-6-637

8.39 acres
6.94 acres

¹Active but waste is covered daily.

NONRADIOACTIVE WASTE, cont'd

22

Stored in Piles

BLDG NO.	CONTENT	LOCATION	SIZE	OPEN	CLOSED	COORDINATES	
						N	E
131-1C <i>RP</i>	Rubble: waste concrete and metal used for erosion control. Ref. photo: 35199-6	Eroded area, near West side of 100-C effluent canal. Ref. map: M-12	25'x1000'X 5' deep.	X		65,430.58 65,421.93 65,125.99 65,145.35	45,117.80 44,990.97 45,063.59 45,185.96
131-1P <i>RP</i>	Rubble: waste concrete used for erosion control. Ref. photo: 35199-31	Eroded area, on north side of 100-P effluent to Steel Creek. Ref. map: U-19	12'x75'x12' deep.	X		45,135	64,060 (Near Center)
<i>MAH</i> 231-3F (Burning Site)	Rubble: scrap lumber, poles, crates, pallets, unsalvageable wooden furniture, etc. Ref. photo: 35199-15	End of dirt road, north of 200-F entrance road. Ref. map: M-12	200'x400'	X		79,400	50,700 (Near Center)
631-2G <i>JCL</i> (Burning Site)	Rubble: scrap lumber, poles, crates, pallets, unsalvageable wooden furniture, etc. Ref. photo: 18796-51,-52	Northeast of Central Shops, between Road C and Road 5. Ref. map: M-12	300' X 300'	X		65,000	52,800 (Estimated Center)
<i>MAH</i> 731-6A	Rubble: asphalt, cans, lumber, brick, concrete, cement. Ref. photo: 35199-23,-24,-25	East of Bldg. 751-A and 716-A, outside perimeter fence. Ref. map: B-2	25'x700'	X ¹		102,200	50,800 (Estimated Center)
Near Forestry Head-quarters, 760-G <i>MAH</i>	Rubble: lumber, fluorescent light fixtures, concrete, metal, metal drums, wire, decaying animals, etc. Ref. photo: 1749-10,-11,-12,-13	North of Road 2-1, 0.65 mile from Road 2. Ref. map: G-7	30'x790'	X		99,300	70,000 (Near Center)

¹Inactive

NONRADIOACTIVE WASTE, cont'd

23

Stored in Piles, cont'd

BLDG NO.	CONTENT	LOCATION	SIZE	OPEN	CLOSED	COORDINATES	
						N	E
Gunsite 51	<i>WAAH</i> Rubble: concrete, brick, lumber, metal, asbestos, cement. Ref. photo: 17919-18,19	South of Road A-14 near Road A. Ref. map: S-17	4.1 acres		X	41,400	35,300 (Near Center)
Gunsite 72	<i>WAAH</i> Rubble: concrete, brick, lumber, metal, asbestos, cement. Ref. photo: 17919-6	West end of paved portion of Road A-2. Ref. map: E-5	6.4 acres		X	80,300	23,019 (Near Center)
Gunsite 102	<i>WAAH</i> Rubble: transite, lumber, metal, empty drums, glass. Ref. photo: 17931-11	South of Road 2-1 and east of Road E-2. Ref. map: P-14	6.4 acres		X	74,697	84,965 (Near Center)

ARETTIE

*WAAH
17919-18,19
17919-6
17931-11*

NONRADIOACTIVE WASTE, cont'd

Stored in Piles, cont'd

24

BLDG NO.	CONTENT	LOCATION	SIZE	OPEN	CLOSED	COORDINATES	
						N	E
788-A <i>SW</i> (Ash Pile)	Ashes from 784-A powerhouse. Ref. photo: 35199-22; 17357-21,-22,-23,-24	East of Road D, adjacent to Tims Branch. Ref. map: B-2	250'x330'	X		100,761.4 (Near Center)	50,622.9
188-C ¹ <i>SW</i> (Ash Pile)	Ashes from 184-C powerhouse. Ref. photo: 173357-19,-20; 17493-22	Northeast of retention containment basin. Ref. map: M-12	235'x90'x190' x150'x75'x115'	X ²		69,027 68,862 68,746 68,787 68,930 68,991	45,748 45,862 45,825 45,645 45,608 45,640
188-C ¹ <i>SW</i> (Ash Pile)	Ashes from powerhouse Building 184-C. Ref. photo: 17357-19,-20; 17493-22	Adjacent to Bldg. 188-C. Piles are separated by a ditch. Ref. map: M-12	Included in measurements shown under 188-C	X ²		Included in Coordinates shown for 188-C.	

¹At one time two ash piles designated as East and West were divided by a drainage ditch. When the piles were stabilized the two piles became one. Therefore, the size measurements and the coordinates enclose both piles.

²Inactive and stabilized to control erosion.

MIXED WASTE

Stored in Basins

BLDG NO.	CONTENT	LOCATION	SIZE	OPEN	CLOSED	COORDINATES	
						N	E
904-41G <i>DG</i> (200-F S.B.#1)	Aqueous Waste ¹ from 221-F overheads, and GP and 242-F evaporators. Ref. photo: 17435-20; 17736-2	West of Road C, opposite Road E. Ref. map: M-12	87' X 277' (1.0 X 10 ⁶ gals.)	X		75,778	51,498 (Northernmost corner)
904-42G <i>DG</i> (200-F S.B.#2)	Aqueous Waste ¹ from 221-F overheads, and GP and 242-F evaporators. Ref. photo: 17435-19; 17736-2	West of Road C, opposite Road E. Ref. map: M-12	87' X 527' (1.9 X 10 ⁶ gals.)	X		75,640.0	51,188.0 (Northernmost corner)
904-43G <i>DG</i> (200-F S.B.#3)	Aqueous Waste ¹ from 221-F overheads, and GP and 242-F evaporators. Ref. photo: 17435-18; 17736-2	West of Road C, opposite Road E. Ref. map: M-12	307' X 717' (1.4 X 10 ⁷ gals.)	X		75,485.0	50,663.0 (Easternmost corner)
904-49G <i>DG</i> (Old-F S.B.)	Aqueous Waste: Natural uranium and acid waste. Ref. photo: 17435-17; 17533-22	Northeast of Bldg. 221-F, outside perimeter fence. Ref. map: F-6	195' X 300'	X ²		80,519	54,216 (Northernmost corner)
904-44G <i>DG</i> (200-H S.B.#1)	Aqueous waste ¹ from 221-H overheads, and GP and 242-H evaporators, RBOF wastewater, and H-3 facilities cooling water. Ref. photo: 17469-5	Southwest of Road E, north of Road 4. Ref. map: M-12	93' X 245' (1.0 X 10 ⁶ gals.)	X		72,218.0	58,744 (Northeast corner)
904-45G <i>DG</i> (200-H S.B.#2)	Aqueous waste ¹ from 221-H overheads, and GP and 242-H evaporators, RBOF wastewater, and H-3 facilities cooling water. Ref. photo: 17469-6	Southwest of Road E, north of Road 4. Ref. map: M-12	113' X 463' (2.8 X 10 ⁶ gals.)	X		72,127.0	58,480 (Northeast corner)

¹Fission and activation products; inorganic chemicals and trace metals.

²Inactive

MIXED WASTE, cont'd

Stored in Basins, cont'd

26

BLDG NO.	CONTENT	LOCATION	SIZE	OPEN	CLOSED	COORDINATES	
						N	E
904-46G (200-H S.B.#3)	<i>D6</i> Aqueous waste ¹ from 221-H overheads, and GP and 242-H evaporators, RBOF waste-water, and H-3 facilities cooling water. Ref. photo: 17469-8,-9,-10	Southwest of Road E, north of Road 4. Ref. map: M-12	285' X 500' 435' X 485' (2.3 X 10 ⁷ gals.)	X		71,978.0 71,718.0 71,434.0 71,788.0	57,890.0 58,320.0 58,000.0 57,680.00
904-56G (200-H S.B.#4)	<i>D6</i> Aqueous waste ¹ from 221-H overheads, and GP and 242-H evaporators, RBOF waste-water, and H-3 facilities cooling water. Ref. photo: 17469-7	Southwest of Road E, north of Road 4. Ref. map: M-12	9.3 Acres (3.1 X 10 ⁷ gals.)	X		72,952 73,246 72,074 72,012	56,046 56,376 57,721 57,790 (Inner, lower and upper sides)
904-51G (300-M S.B.)	<i>HCM</i> Aqueous waste ² from fuel and target fabrication. Ref. photo: 17952-5; 34772-8, -9, -10	Southwest of 300-M, north of Road C-1. Ref. map: B-2	279' X 331' (1.4 X 10 ⁶ gal.)	X		102,151	48,684 (Northeast corner)
904-112G (Lost Lake)	<i>HCM</i> Aqueous waste ² from fuel and target fabrication. Ref. photo: 30986-5, -13; 34772-6, -7	North of Road C-1, near intersection of Road C-1.1. Ref. map: B-2	6.4 Acres	X		101,277.42	46,930.01 (Near center)
904-91G (H-X Repair S.B.)	<i>JU</i> Aqueous waste ³ from heat exchanger decontamination facility (Ford Bldg.). Ref. photo: 17551-9; 34701-8	Southeast of Ford Bldg. (690-G) in Central Shops. Ref. map: M-12	40' X 80'	X		60,685.0 60,605.0 60,685.0 60,605.0	52,560.0 52,560.0 52,520.0 52,520.0

¹Fission and activation products; inorganic chemicals and trace metals.

²Uranium; organic, inorganic chemicals and trace metals.

³Low level radioactivity and organics.

MIXED WASTE, cont'd

Stored in Basins, cont'd

BLDG. NO.	CONTENT	LOCATION	SIZE	OPEN	CLOSED	COORDINATES	
						N	E
904-53G (700-A S.B.#1)	W6H Aqueous waste ¹ from 735-A and 773-A. Ref. photo: 17435-11	South of Road A-1, west of Road D-1. Ref. map: B-2	129' x 196' (1x10 ⁶ gal)	X		105,510.0	52,687.0 (Southernmost corner)
904-54G (700-A S.B.#2)	W6H Aqueous waste ¹ from 735-A and 773-A. Ref. photo: 17435-13	South of Road A-1, west of Road D-1. Ref. map: B-2	125' x 175' (1.63x10 ⁶ gal)	X		105,840.13	52,852.84 (Northernmost corner)
904-55G (700-A S.B.#3)	W6H Aqueous waste ¹ from 735-A and 773-A. Ref. photo: 17435-12	South of Road A-1, west of Road D-1. Ref. map: B-2	150' x 300' (4.32x10 ⁶ gal)	X		105,635.5	53,074.9 (Southernmost corner)
904-76G (old TNX S.B.)	W6H Aqueous waste ² from CMX/TNX. Ref. photo: 17421-2	West of Bldg. 677-G, at CMX/TNX facility. Ref. map: K-10	75' x 165' (2.0x10 ⁵ gal)		X ⁴	71,128	16,939 (Northeast corner)
904-102G (new TNX S.B.)	W6H Aqueous waste ³ from CMX/TNX with some low level contamination. Ref. photo: 34701-15,-16	East of Road A-4.7, across from Bldg. 677-G at CMX/TNX. Ref. map: K-10	71' x 255' x 58' x 255' (5.7x10 ⁵ gal)	X		71,078.5	17,836.0 70,878.5 17,791.2 (Coordinates of inner eastern side)
904-111G	TKLH Miscellaneous aqueous waste -- both radioactive and chemical. Ref. photo: 17471-11,-12,-13	North of Baxley Road, west of west end of Road 6. Ref. map: S-17	159' x 158'		X ⁴	55,880.86	29,253.30 55,824.46 29,352.24 56,022.93 29,365.17 56,039.42 29,273.29
904-83G (100-L Chemical Waste Basin)	RP Decontamination solutions and oily wastes from 717-G. Ref. photo: 17471-26	Southeast of Bldg. 105-L, outside perimeter fence. Ref. map: T-18	120' x 80' (2.5x10 ⁵ gal)	X		45,290.6	51,000.0 (Northwest corner)

¹Fission and activation products; organic and inorganic chemicals and trace metals.
²Natural Uranium and Thorium; inorganic chemicals and trace metals(mercury).
³Natural Uranium and Thorium; inorganic chemicals.
⁴Inactive; now backfilled

57300

MIXED WASTE, cont'd

Stored in Pits¹

28

BLDG NO.	CONTENT	LOCATION	SIZE	OPEN	CLOSED	COORDINATES	
						N	E
643-1G <i>RP</i>	Rubble from 100-K Bingham pump outage. Ref. photo: 17355-32	East of Road 6-4.22 between Road B and 100-K perimeter fence. Ref. map: T-18	60'x403'		X	52,371.89 52,369.10 51,973.44 51,970.44	40,335.69 40,392.41 40,391.75 40,337.38
643-2G <i>RP</i>	Rubble from 100-L Bingham pump outage. Ref. photo: 17471-18	North of Road 7, east of Bldg. 188-L(ash basin). Ref. map: T-18	44'x333'		X	48,811.50 48,911.14 48,827.48 48,927.57	52,887.40 52,881.55 53,165.14 53,168.62
643-3G <i>RP</i>	Rubble from 100-L Bingham pump outage. Ref. photo: 17551-5	North of Road 7, east of Bldg. 188-L(ash basin). Ref. map: T-18	47'x488'		X	48,933.82 48,833.46 48,945.27 48,845.31	53,254.51 53,231.04 53,704.68 53,707.59
643-4G <i>RP</i>	Rubble from 100-P Bingham pump outage. Ref. photo: 17355-24	North of Road F, opposite P-Area parking lot. Ref. map: U-19	90'x435'		X	45,337.36 45,388.93 45,687.40 45,613.52	65,367.45 65,282.32 65,615.86 65,683.26

¹These sites are permanently marked and documented.

MIXED WASTE, cont'd

Stored in Pits, cont'd

29

BLDG NO.	CONTENT	LOCATION	SIZE	OPEN	CLOSED	COORDINATES	
						N	E
643-5G <i>W6H</i>	Rubble from CMX-TNX explosion of hydrate evaporator (A portion of this area has been cleared of radioactive contamination --natural uranium) ¹ . Ref. photo: 17471-4,-7	Northeast of Bldg. 677-G at CMX/TNX facility. Ref. map: K-10	290'x366'		X	71,493.7 (Northeast Corner)	17,515.6
643-8G <i>RP</i>	Rubble from 100-R Bingham pump outage ² . Ref. photo: 17355-15	Northeast of 100-R entrance Road G-1. Ref. map: U-19	20'x250'		X	56,959 (Northwest Corner)	77,243
643-9G <i>RP</i>	Rubble from 100-R Bingham pump outage ² . Ref. photo: 17355-15	Northeast of 100-R entrance Road G-1. Ref. map: U-19	15'x250'		X	56,959 (Northwest Corner)	77,328
643-10G <i>RP</i>	Rubble from 100-R Bingham pump outage ² . Ref. photo: 17355-15	Northeast of 100-R entrance Road G-1. Ref. map: U-19	25'x515'		X	57,224 (Northwest Corner)	77,408

¹Bldg. 675-G was located on cleared portion of site.
²These sites are permanently marked and documented.

MIXED WASTE, cont'a

Stored in Pits, cont'a

30

BLDG NO.	CONTENT	LOCATION	SIZE	OPEN	CLOSED	COORDINATES	
						N	E
643-G ¹ (Old Burial Ground)	Contaminated miscellaneous equipment and waste. Ref. photo: 17736-17	Burial Ground, northeast side of Road E, between 200-F and 200-H. Ref. map: M-12	76 Acres		X	73,897.54 73,345.95 75,277.26 76,151.28	58,017.03 57,586.54 54,411.28 55,080.81
643-7G ¹ (New Burial Ground)	Contaminated miscellaneous equipment and waste. Ref. photo: 17736-18, -19, -20, -44	Burial Ground, northeast side of railroad, between 200-F and 200-H. Ref. map: M-12	119 Acres		X ²	75,820.0 (Near Center)	57,800.0
643-11G	Contaminated chained area: One half marked with sign saying, "Cleans Pans Only" and one half is marked as "regulated area" and contains old clothing, lumber and metal. There was an oil leak near this area in the 1970's. ³ Ref. Photo: 35199-26, -27	North of Ford Bldg. in Central Shops. Ref. map: M-12	22'x169'		X	61,317.0 (Estimated Center)	52,201.6

¹These sites are permanently marked and documented.

²Active

³Because of oil leak, regulated area signs, and because of some uncertainty as to the history, this site was listed under mixed waste, pits.

APPENDIX A

This appendix shows locations of waste sites on 8 1/2" X 11" maps. Each site is represented by a numbered symbol. The numbers correspond to labels at the top of each map. One symbol may represent more than one site. In such a case the number of sites represented is shown at the end of the site label in parentheses. A legend is shown below.

-  - Basin containing radioactive waste

-  - Basin containing nonradioactive waste

-  - Basin containing mixed waste

-  - Pit containing nonradioactive waste

-  - Pit containing mixed waste

-  - Pile consisting of nonradioactive waste

- | | |
|--------------|-------------------------------|
| 1 - 788-3A | 6 - 788-A |
| 2 - 904-101G | 7 - 904-53G, 904-54G, 904-55G |
| 3 - 904-110G | 8 - 904-51G |
| 4 - 731-3A | 9 - 904-112G |
| 5 - 731-6A | |

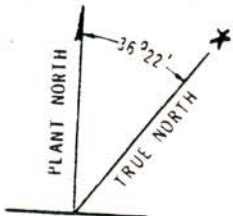
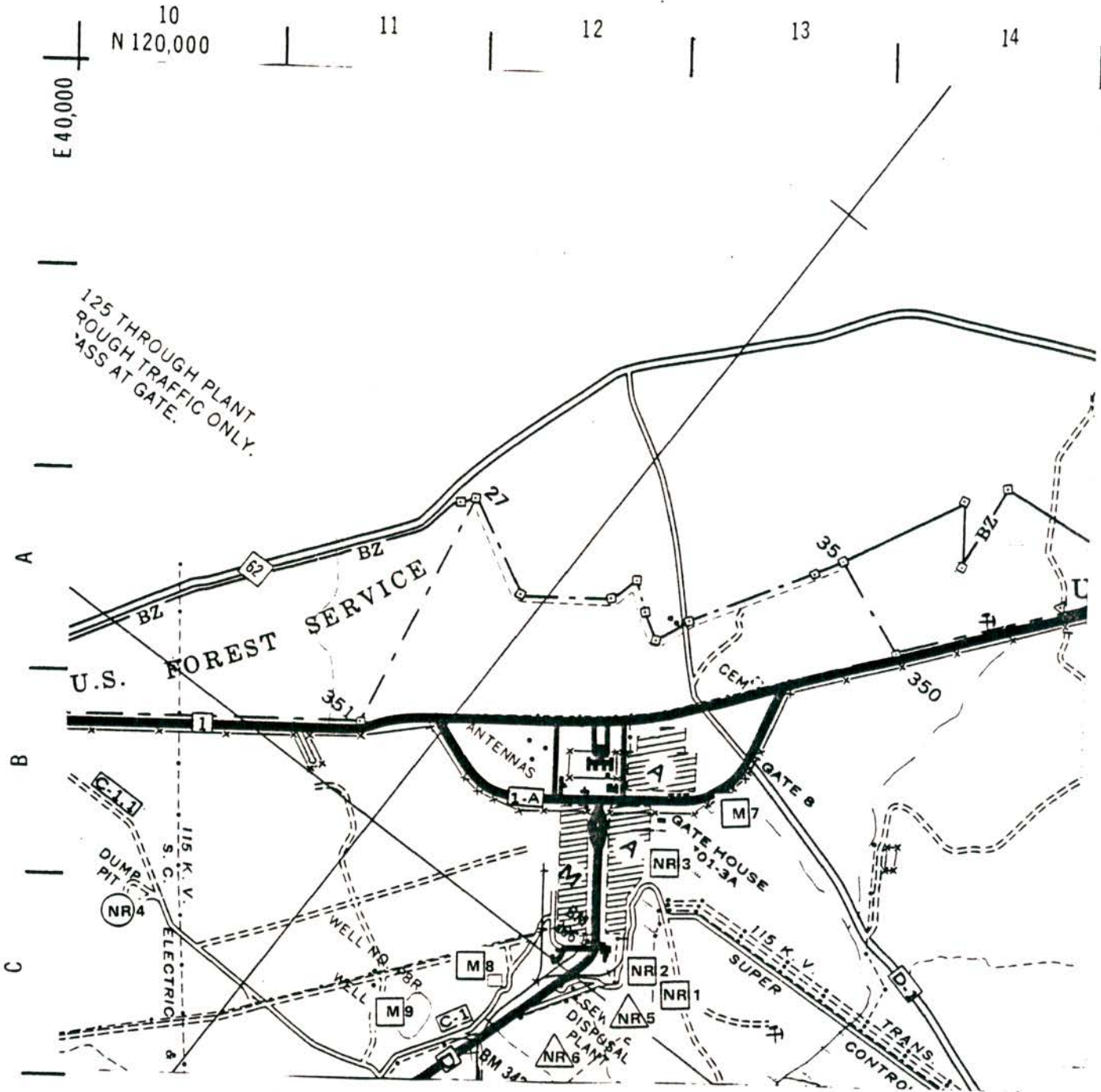

B-2

1 - Gunsite 72

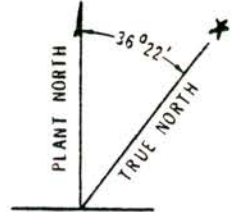
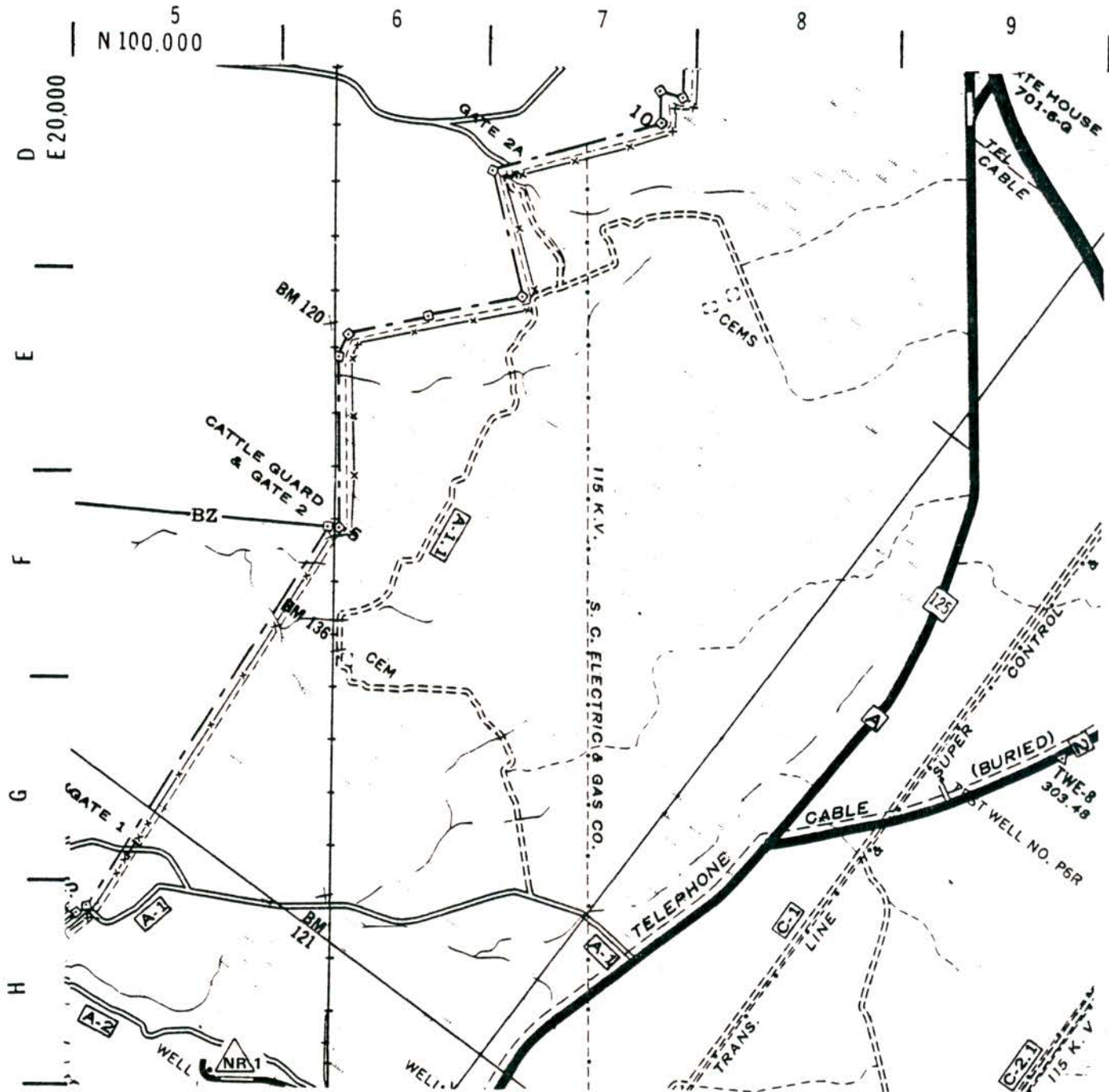

E-5

- 1 - 788-2A
- 2 - 731-5A
- 3 - 731-A, 731-1A, 731-2A

- 4 - 731-4A
- 5 - 740-G
- 6 - 904-49G

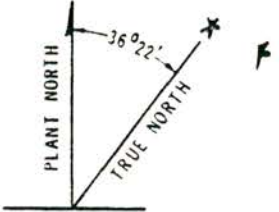
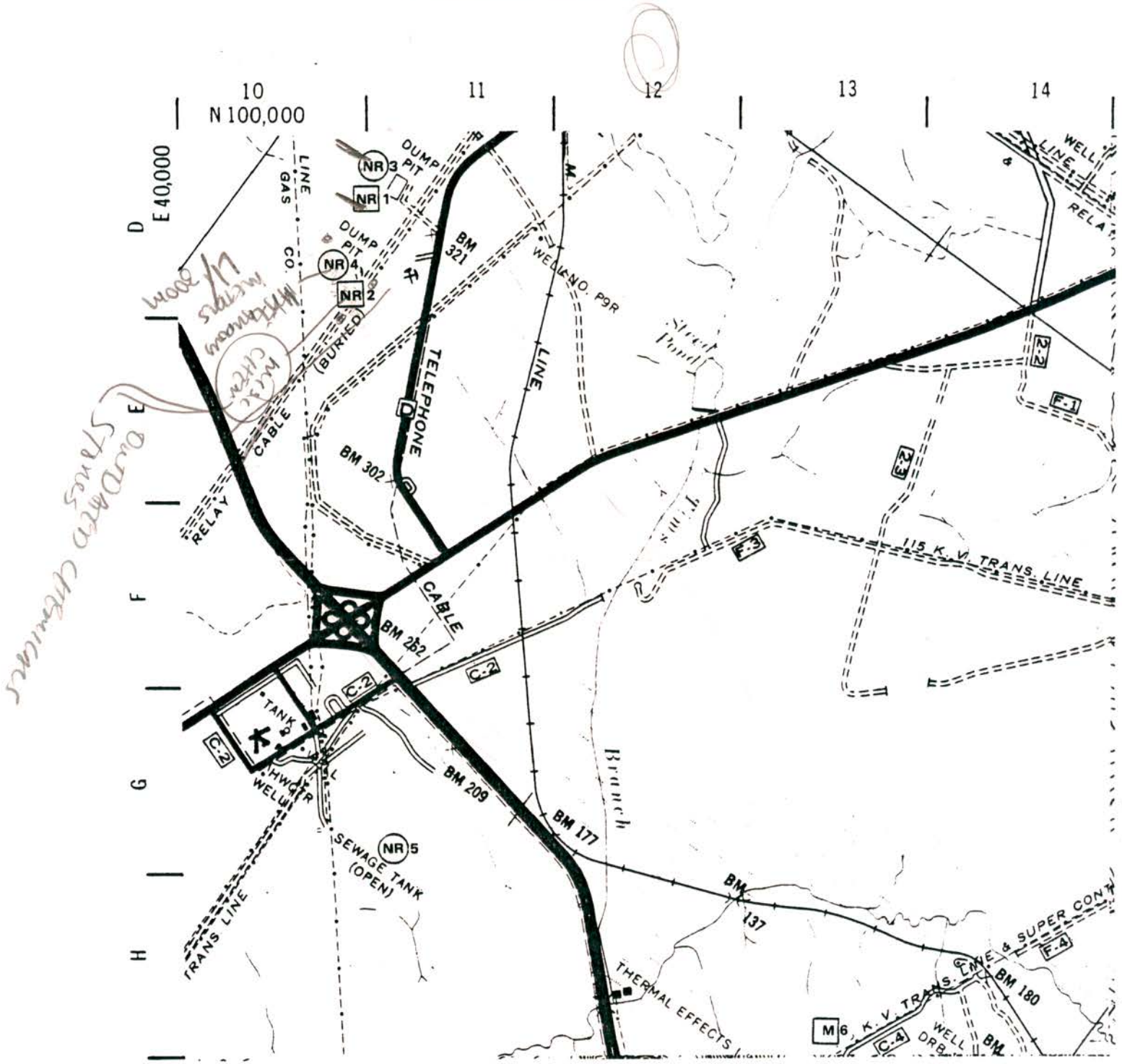

F-6

1 - Forestry Bone Yard

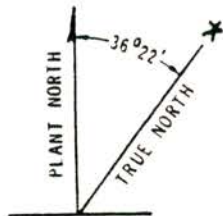
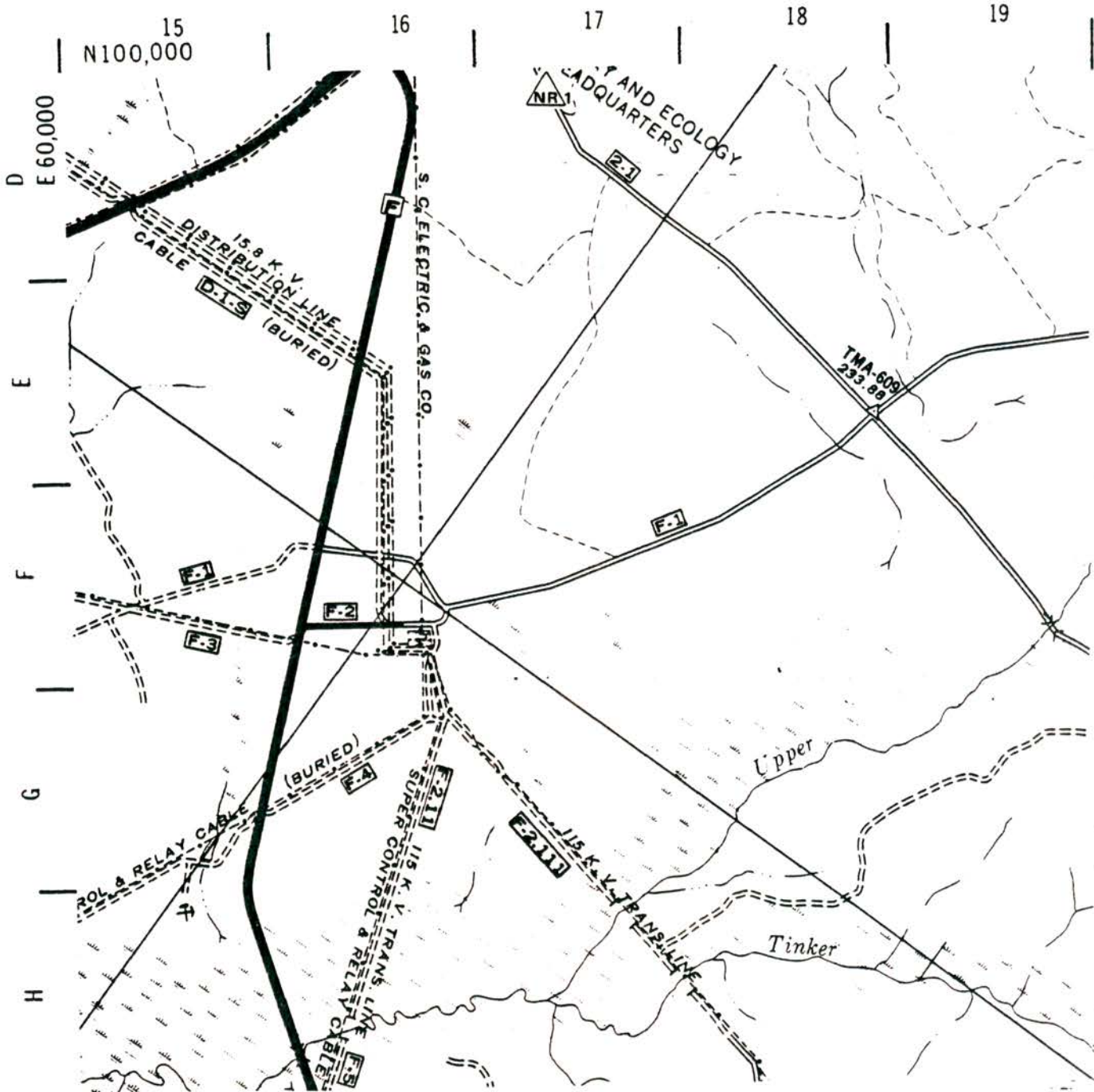

G-7

- 1 - 488-D
- 2 - 488-1D
- 3 - 488-2D
- 4 - 431-D, 431-1D
- 5 - 431-2D

- 6 - 631-8G
- 7 - 904-76G
- 8 - 904-102G
- 9 - 643-5G

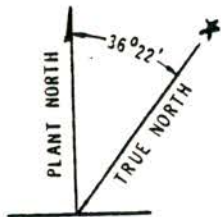
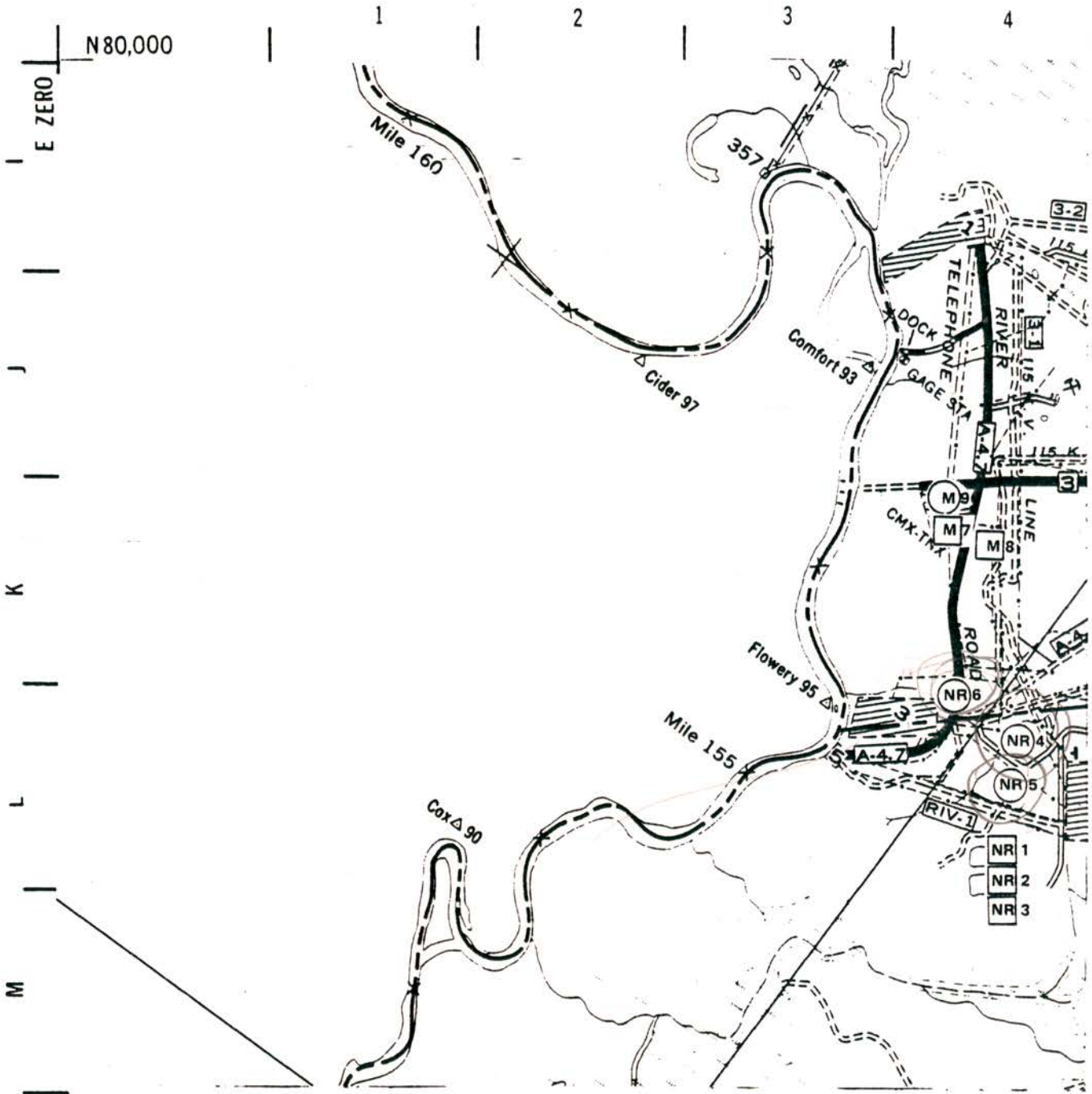

K-10

- 1 - 631-G
- 2 - 489-D
- 3 - 080-20G

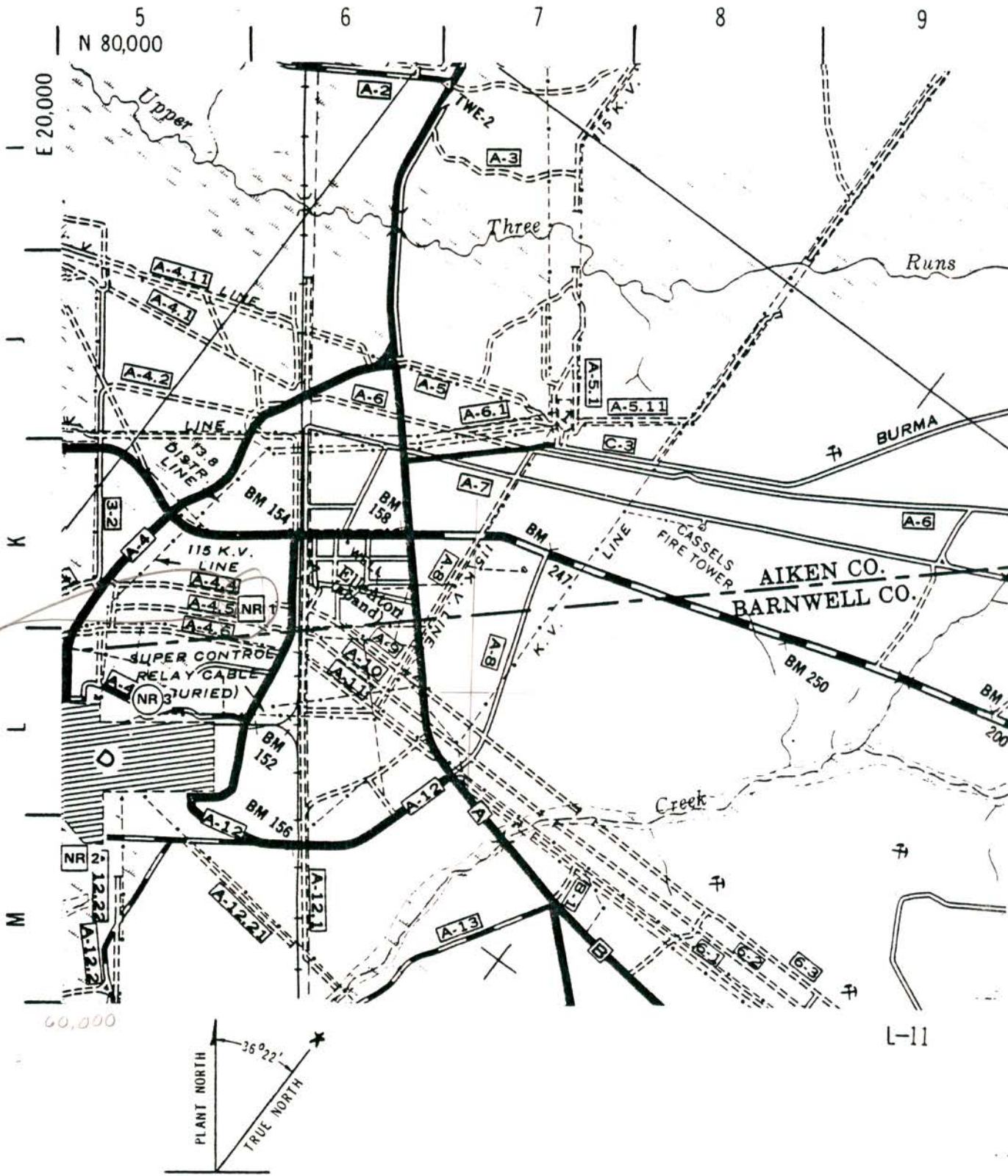

- | | | |
|-------------------------------|-----------------------|--------------------------------|
| 1 - 904-66G, 904-67G, 904-68G | 12 - 231-2F | 23 - 231-3F |
| 2 - 281-3F | 13 - 231-4F | 24 - 631-2G |
| 3 - 188-2C | 14 - 631-1G | 25 - 188-C, 188-1C |
| 4 - 288-F | 15 - 631-3G | 26 - 904-41G, 904-42G, 904-43G |
| 5 - 288-1F | 16 - 631-5G | 27 - 904-44G, 904-45G, 904-46G |
| 6 - 189-C | 17 - 631-6G | 28 - 904-56G |
| 7 - 289-F | 18 - 631-7G | 29 - 904-91G |
| 8 - 904-113G | 19 - 080-16G | 30 - 643-G |
| 9 - 904-74G | 20 - 631-4G | 31 - 643-7G |
| 10 - 131-C | 21 - 080-21G, 080-22G | 32 - 643-11G |
| 11 - 231-F, 231-1F | 22 - 131-1C | |

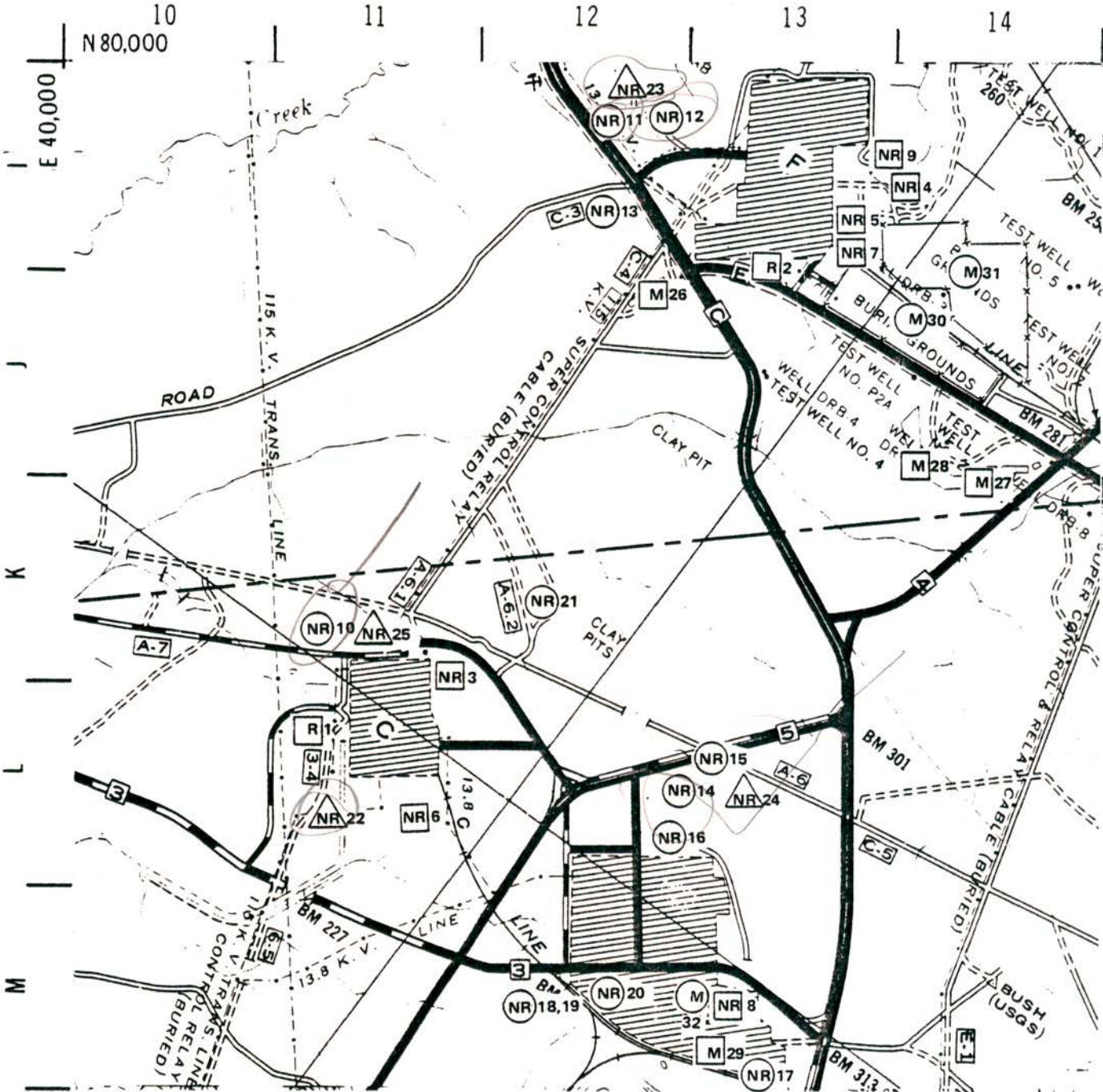

M-12

- 1 - 281-3H
- 2 - 288-H
- 3 - 289-H
- 4 - 904-75G

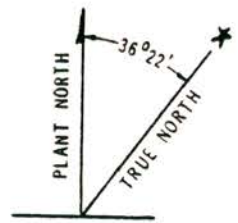
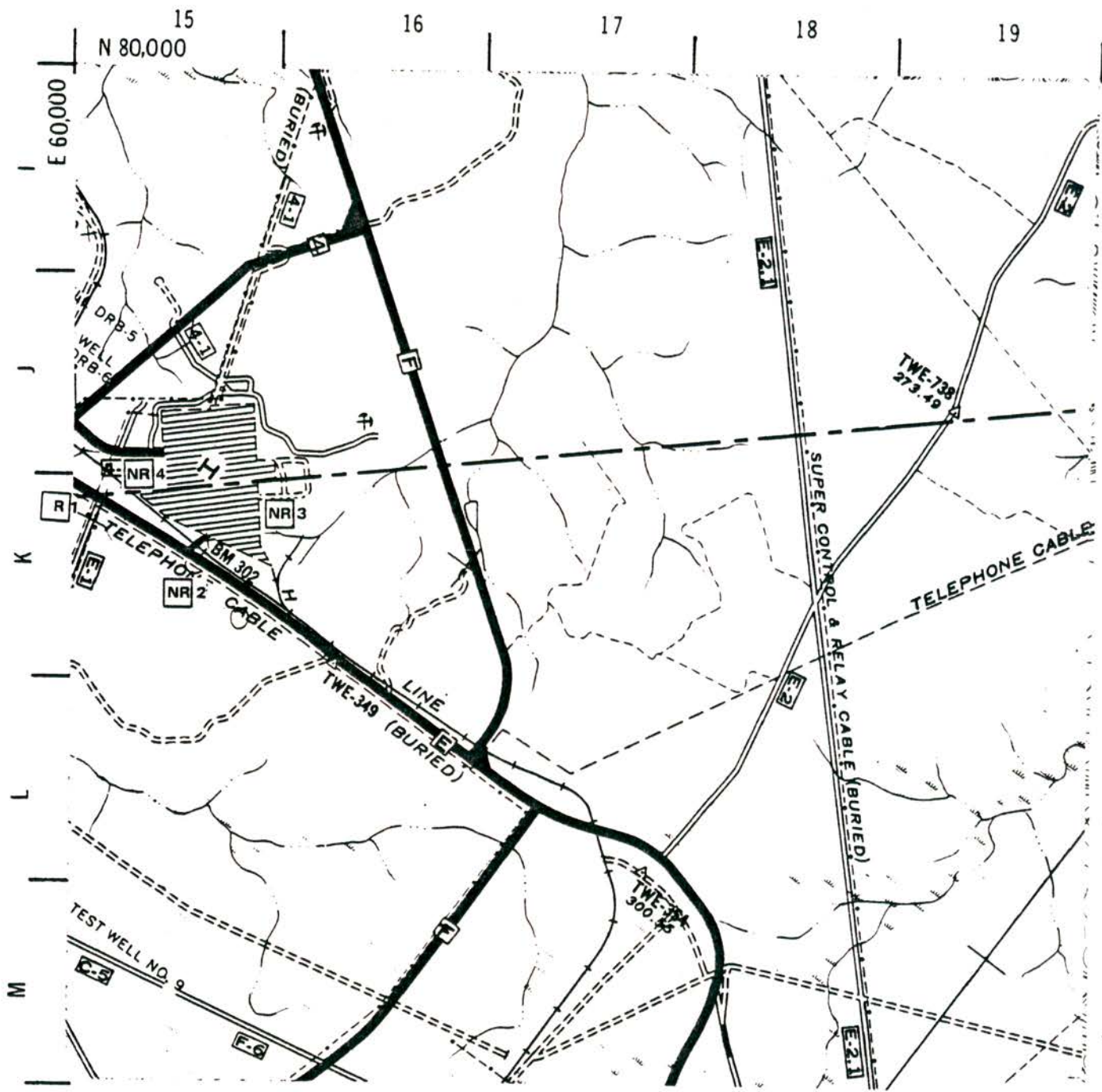

N-13

1 - Gunsite 102

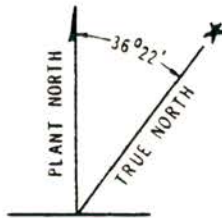
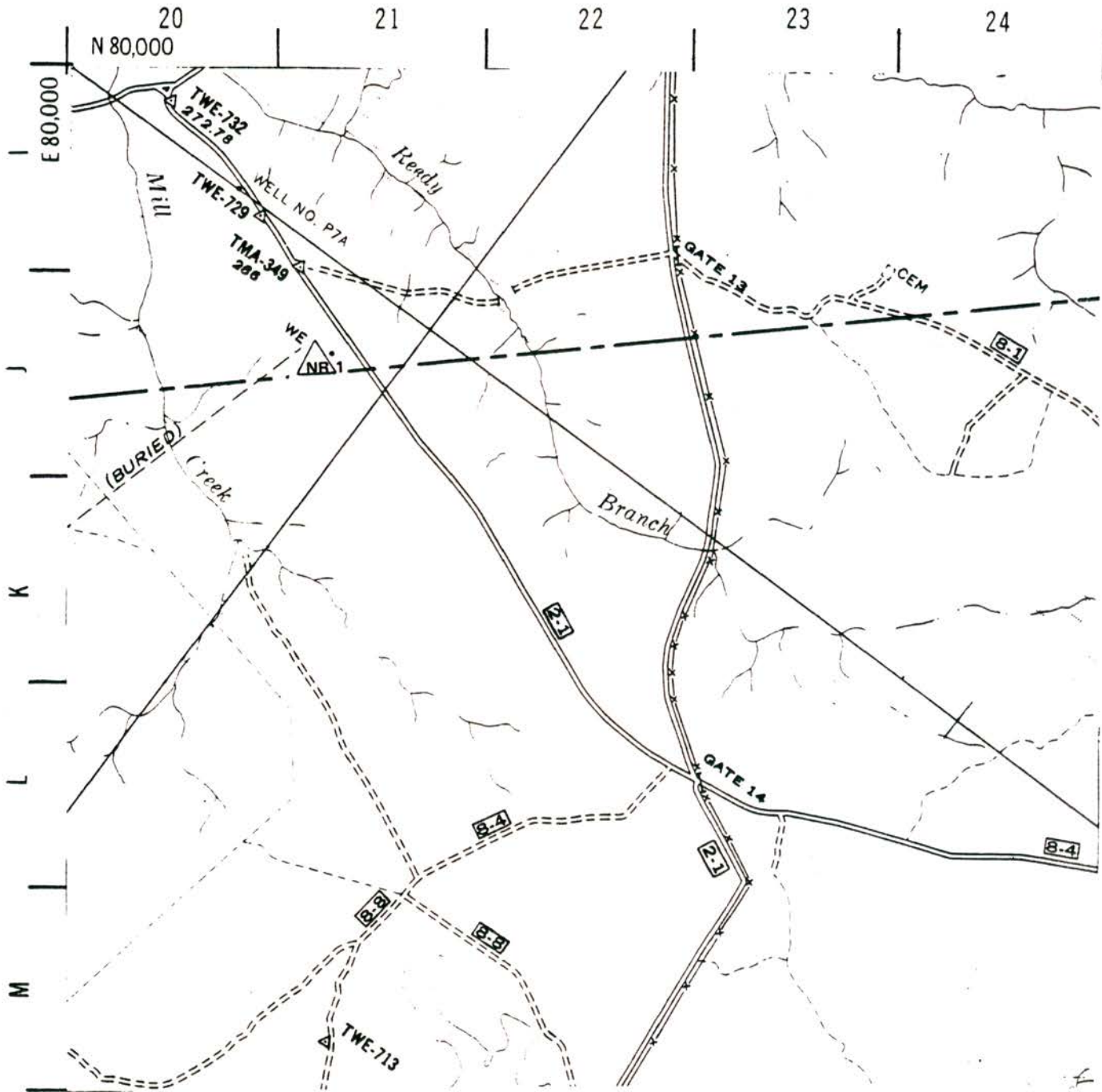

P-14

- 1 - 904-65G
- 2 - 188-K
- 3 - 189-K

- 4 - Gunsite 51
- 5 - 904-111G

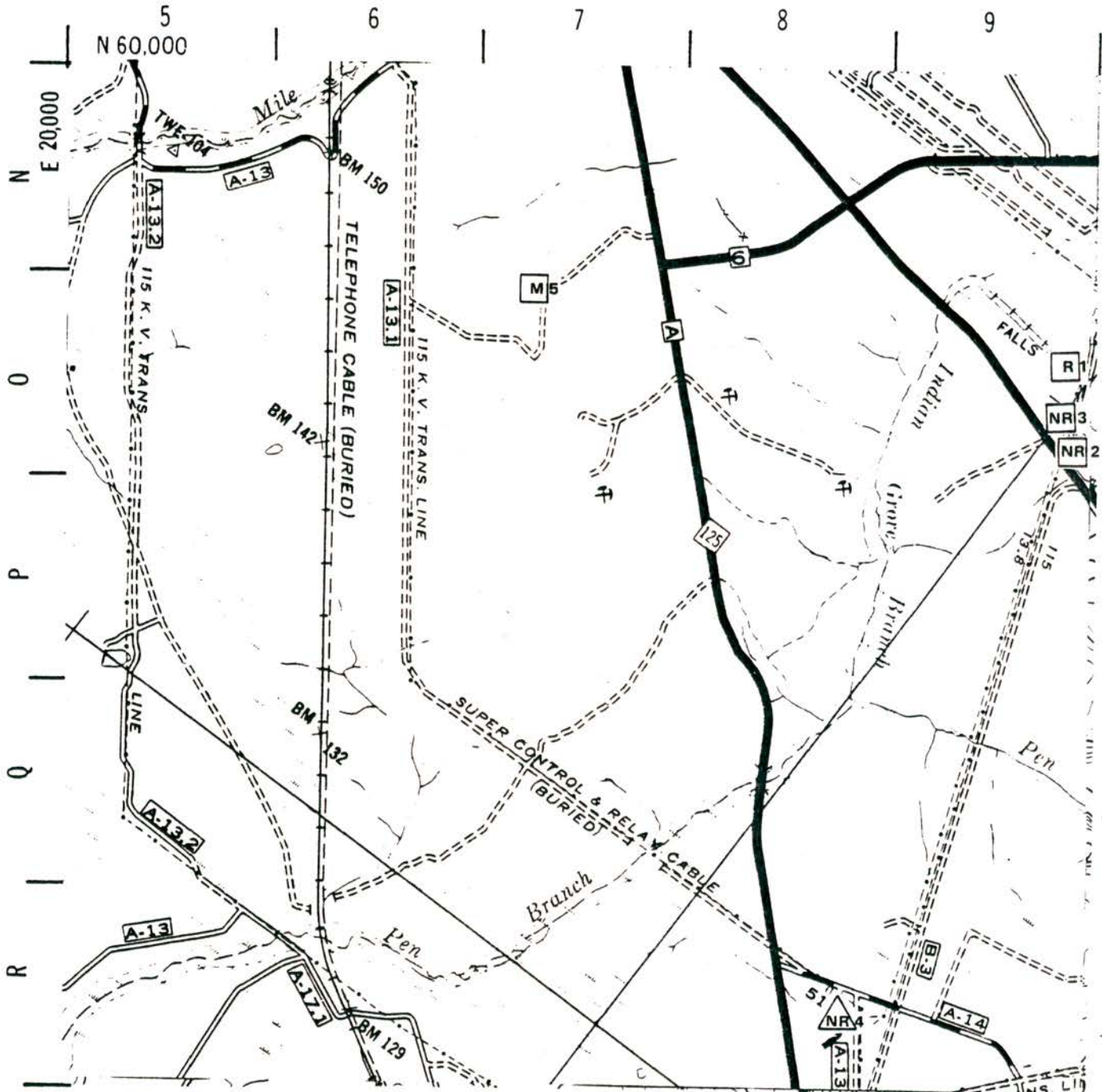

S-17

- | | | |
|-------------|--------------------------|--------------|
| 1 - 904-64G | 8 - 131-1L | 14 - 131-2L |
| 2 - 904-88G | 9 - 131-3L | 15 - 904-83G |
| 3 - 188-L | 10 - 131-4L | 16 - 643-1G |
| 4 - 904-79G | 11 - 080-19G | 17 - 643-2G |
| 5 - 904-80G | 12 - 080-17G, 080-17.1G | 18 - 643-3G |
| 6 - 131-K | 13 - 080-18G, 080-18.1G, | |
| 7 - 131-L | 080-18.2G, 080-18.3G | |

*O. 80 11G
Filler
T. Miller*

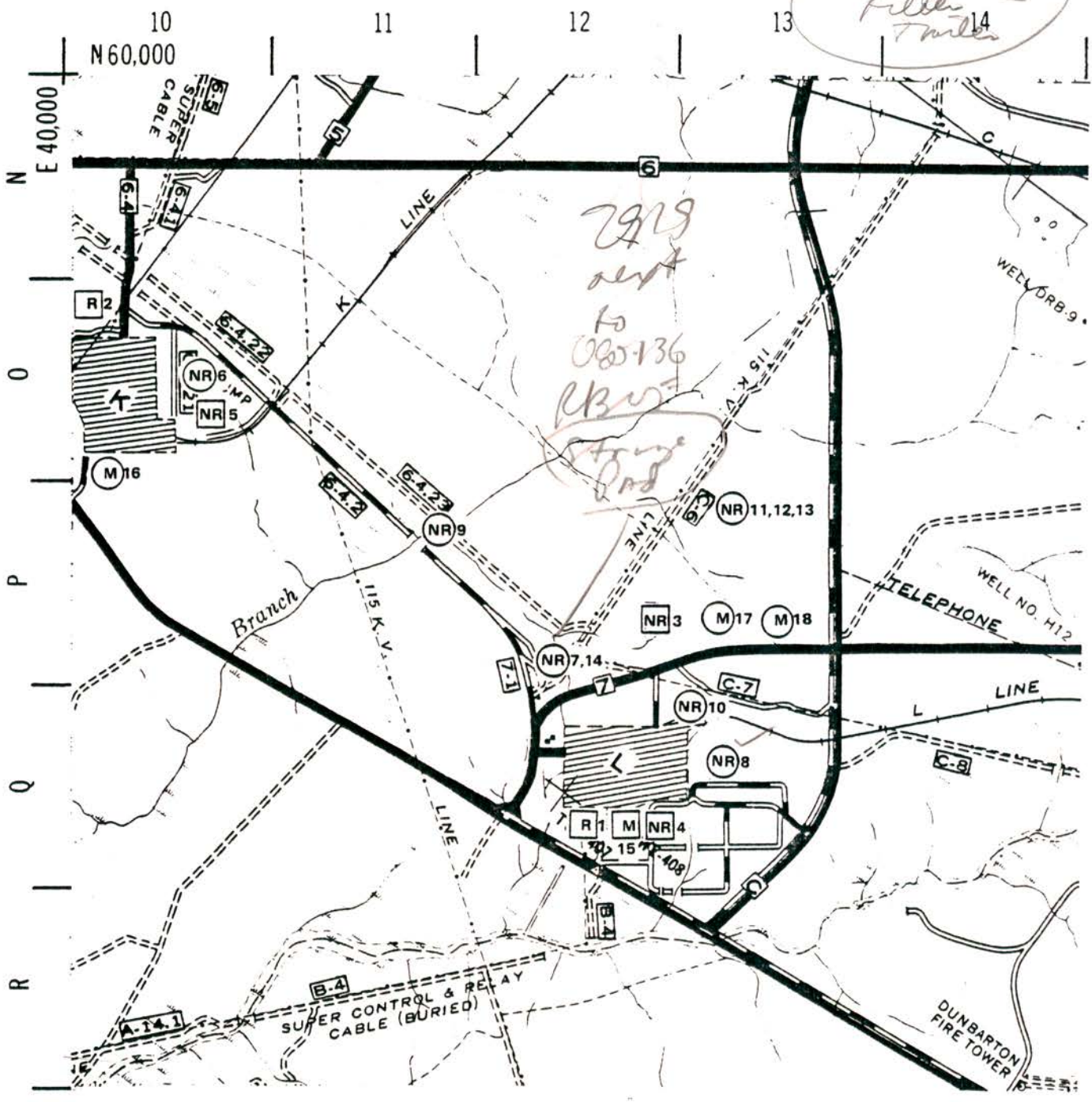

T-18

- | | |
|---------------------------------------------------------------|------------------------------|
| 1 - 904-57G, 904-58G, 904-59G, 904-60G,
904-103G, 904-104G | 8 - 131-P |
| 2 - 904-61G, 904-62G, 904-63G | 9 - 131-R, 131-1R |
| 3 - 188-P | 10 - 131-2R |
| 4 - 188-R | 11 - 080-1R |
| 5 - 189-P | 12 - 131-1P |
| 6 - 904-77G | 13 - 643-4G |
| 7 - 904-78G | 14 - 643-8G, 643-9G, 643-10G |

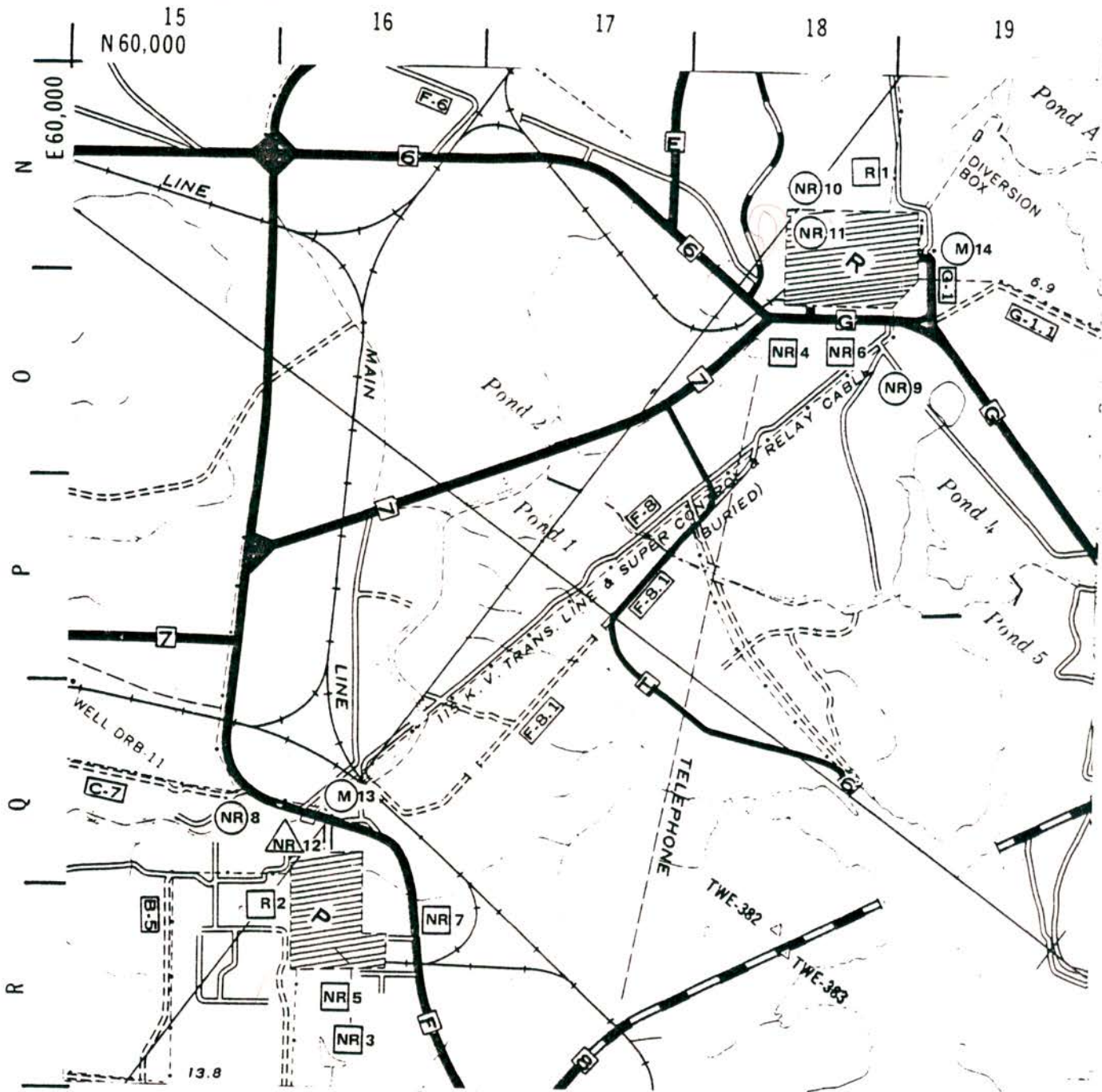

U-19

APPENDIX B

Plant reference drawings located during the creation of this document are listed below. Since no drawings were found on some sites, all sites will not have reference drawings listed here. Those with only a sheet (Sh.) number are series 3302 maps.

building No.	Name	Plant Reference
		Drawing
080-16G	Nonbournable Waste Oil Disposal Site	Sh. 673
080-17G	Pesticide Container Disposal Pit	Sh. 854
080-17.1G	Pesticide Container Disposal Pit	Sh. 854
080-18G	Toxic Chemicals Disposal Pit	Sh. 854
080-18.1G	Toxic Chemicals Disposal Pit	Sh. 854
080-18.2G	Toxic Chemicals Disposal Pit	Sh. 854
080-18.3G	Toxic Chemicals Disposal Pit	Sh. 854
080-19G	Hazardous Metals Disposal Pit	Sh. 854
080-20G	D-Area Asbestos Disposal Pit	Sh. 726
331-C	Rubble Pit No. 1	Sh. 761
131-K	Rubble Pit No. 1	Sh. 611
131-P	Rubble Pit No. 1	Sh. 526
188-C	C-Area Ash Disposal Pile, East	Sh. 762
188-1C	C-Area Ash Disposal Pile, West	Sh. 762
188-2C	C-Area Ash Containment Basin	Sh. 732, 762

		Plant Reference
building No.	Name	Drawing
188-K	K-Area Disposal Basin	Sh. 580
188-L	L-Area Disposal Basin	Sh. 553
188-P	P-Area Disposal Basin	Sh. 467
188-R	R-Area Disposal Basin	Sh. 619
189-C	C-Area Coal Storage Runoff Containment Basin	Sn. 732
189-K	K-Area Coal Storage Runoff Containment Basin	Sh. 580
189-P	P-Area Coal Storage Runoff Containment Basin	Sh. 466, 467
231-F	F-Area Rubble Pit No. 1	Sn. 883
231-1F	F-Area Rubble Pit No. 2	Sh. 883
231-2F	F-Area Rubble Pit No. 3	Sn. 883
231-3F	F-Area Burning Site	Sn. 883
281-3F	F-Area Return Water Retention Basin	Sn. 854
281-3H	H-Area Return Water Retention Basin	Sh. 795
288-F	F-Area Ash Disposal Basin	Sh. 854
288-1F	F-Area Alternate Ash Disposal Basin	Sh. 854
288-H	H-Area Ash Disposal Basin	Sh. 766
289-F	F-Area Coal Storage Runoff Containment Basin	Sn. 854
289-H	H-Area Coal Storage Runoff Containment Basin	Sh. 796
431-D	D-Area Rubble Pit No. 1	Sh. 725
431-1D	D-Area Rubble Pit No. 2	Sh. 725

Building No.	Name	Plant Reference
		Drawing
488-D	D-Area Ash Disposal Basin # 1	Sh. 695
488-1D	D-Area Ash Disposal Basin # 2	Sh. 695
488-2D	D-Area Ash Disposal Basin # 3	Sh. 695
489-D	D-Area Coal Storage Runoff Containment Basin	Sh. 695
631-2G	Central Shops Burning Site	C-8900-Z Sh. 1B
631-5G	Central Shops Burning Pit	C-8900-Z Sh. 1B
631-6G	Central Shops Burning Pit	w 447988
643-G	Burial Ground No. 1	Sh. 785
643-1G	K-Area Bingham Pump Outage Pit	Sh. 580
643-2G	L-Area Bingham Pump Outage Pit	Sh. 553, 554
643-3G	L-Area Bingham Pump Outage Pit	Sh. 554
643-4G	P-Area Bingham Pump Outage Pit	Sh. 527
643-5G	CMX/TNX Burying Ground	Sh. 785
643-7G	Burial Ground No. 2	Sh. 824, 825, 854, 855
643-8G	R-Area Bingham Pump Outage Pit No. 1	Sh. 650
643-9G	R-Area Bingham Pump Outage Pit No. 2	Sh. 650
643-10G	R-Area Bingham Pump Outage Pit No. 3	Sh. 650
731-A	A-Area Rubble Pit No. 1	Sh. 1091
731-1A	A-Area Rubble Pit No. 2	Sh. 1091
731-2A	A-Area Rubble Pit No. 3	Sh. 1091
740-G	Sanitary Landfill	S5-6-637
788-2A	A-Area Ash Containment Basin	Sh. 1091
788-3A	A-Area Coal Storage Runoff Containment Basin	Sh. 1123

Plant Reference

<u>Building No.</u>	<u>Name</u>	<u>Drawing</u>
904-41G	F-Area Seepage Basin No. 1	823
904-42G	F-Area Seepage Basin No. 2	823
904-43G	F-Area Seepage Basin No. 3	823
904-44G	H-Area Seepage Basin No. 1	795
904-45G	H-Area Seepage Basin No. 2	795
904-46G	H-Area Seepage Basin No. 3	795
904-49G	F-Area Seepage Basin (Inactive)	884
904-51G	M-Area Seepage Basin	1122
904-53G	SRL Seepage Basin No. 1	1153
904-54G	SRL Seepage Basin No. 2	1153
904-55G	SRL Seepage Basin No. 3	1153
904-56G	H-Area Seepage Basin No. 4	794, 795
904-57G	R-Area Seepage Basin No. 3	649
904-58G	R-Area Seepage Basin No. 4	649
904-59G	R-Area Seepage Basin No. 5	649
904-60G	R-Area Seepage Basin No. 6	649
904-61G	P-Area Seepage Basin No. 1	496
904-62G	P-Area Seepage Basin No. 2	496
904-63G	P-Area Seepage Basin No. 3	496
904-64G	L-Area Seepage Basin No. 1	523
904-65G	K-Area Seepage Basin No. 1	610
904-66G	C-Area Seepage Basin No. 1	731, 761
904-67G	C-Area Seepage Basin No. 2	731, 761
904-68G	C-Area Seepage Basin No. 3	731
904-74G	F-Area Acid/Caustic Retention Basin	Sh. 854

Plant Reference

<u>Building No.</u>	<u>Name</u>	<u>Drawing</u>
904-75G	H-Area Acid/Caustic Retention Basin	Sh. 796
904-76G	CMX/TNX Settling Basin	Sh. 784
904-77G	R-Area Acid/Caustic Retention Basin	Sh. 619
904-78G	P-Area Acid/Caustic Retention Basin	Sh. 497
904-79G	L-Area Acid/Caustic Retention Basin	Sh. 523
904-80G	K-Area Acid/Caustic Retention Basin	Sh. 581
904-85G	Disposal Pit for 717-G	Sh. 493, 523
904-88G	K-Area Containment Basin	Sh. 610
904-91G	CS Heat Exchanger Repair Facility Seepage Basin	SM5-6-131
904-101G	716-A Oil and Grease Seepage Basin	Sh. 1123
904-102G	TNX Seepage Basin	Sh. 785
904-103G	R-Area Seepage Basin No. 1	Sh. 649
904-104G	R-Area Seepage Basin No. 2	Sh. 649
904-110G	723-A Seepage Basin	Sh. 1153
Site 51	Military Gunsite # 51	Sh. 451
Site 72	Military Gunsite # 72	Sh. 876
Site 102	Navy Site # 102	Sh. 831, 8324

INDEX

Most sites outside fenced areas are designated as being in G-Area; however, we have tried to associate each site with an area from which it originated. Where sites represent waste from most of the plant (i.e. CMP pits) they are listed under a G-Area heading.

<u>Area</u>	<u>Building No.</u>	<u>Name</u>	<u>Page No.</u>
A/M	731-A	Rubble Pit No. 1	16,34,46
	731-1A	Rubble Pit No. 2	16,34,46
	731-2A	Rubble Pit No. 3	16,34,46
	731-3A	Silverton Road Waste Site	16,32
	731-4A	Rubble Pit	19,34
	731-5A	Chemical Waste Basin	10,34
	731-6A	Rubble Piles	22,32
	788-A	Asn Pile	24,32
	788-2A	Asn Containment Basin	7,34,46
	788-3A	Coal Storage Runoff Containment Basin	8,32,46
	904-51G	M-Area Seepage Basin	26,32,47
	904-53G	SRL Seepage Basin No. 1	27,32,47
	904-54G	SRL Seepage Basin No. 2	27,32,47
	904-55G	SRL Seepage Basin No. 3	27,32,47
	904-101G	Bldg. 716-A Oil and Grease Basin	10,32,47,48
	904-110G	Bldg. 723-A Metallurgical Lab. Seepage Basin	10,32,48
	904-112G	Lost Lake	26,32

Area	Building		Page
	No.	Name	No.
C	131-C	Rubble Pit No. 1	11,38,44
	131-1C	Erosion Control Rubble Pit	22,38
	188-C	Ash Disposal Pile, East	24,38,44
	188-1C	Ash Disposal Pile, West	24,38,44
	188-2C	Ash Containment Basin	6,38,44
	189-C	Coal Storage Runoff Containment Basin	8,38,45
	904-66G	Seepage Basin No. 1	5,38,47
	904-67G	Seepage Basin No. 2	5,38,47
	904-68G	Seepage Basin No. 3	5,38,47
CS	080-16G	Non-Burnable Waste Oil Disposal Area	17,38,44
	631-1G	Rubble Pit No. 1	15,38
	631-2G	Burning Site	22,38,46
	631-3G	Rubble Pit No. 2	15,38
	631-4G	Hydrofluoric Acid Site	18,38
	631-5G	Burning Pit	15,38,46
	631-6G	Burning Pit	15,38,46
	631-7G	Burning Pit	15,38
	643-11G		30,38
	904-91G	Heat Exchanger Repair Facility Seepage Basin	26,38,48
	904-113G	Central Shops Burnable Oil Basin	10,38
D	080-20G	Asbestos Disposal Pit	20,37,44
	431-D	Rubble Pit No. 1	14,36,45
	431-1D	Rubble Pit No. 2	14,36,45

Area	Building		Page
	No.	Name	No.
D cont'd	431-2D	Rubble Pit No. 3	14,36
	488-D	Ash Disposal Basin No. 1	7,36,46
	488-1D	Ash Disposal Basin No. 2	7,36,46
	488-2D	Ash Disposal Basin No. 3	7,36,46
	489-D	Coal Storage Runoff Containment Basin	8,37,46
	631-G	Oil Disposal Basin	10,37
F	231-F	Rubble Pit No. 1	13,38,45
	231-1F	Rubble Pit No. 2	13,38,45
	231-2F	Rubble Pit No. 3	13,38,45
	231-3F	Burning Site	22,38,45
	231-4F	Burma Road Rubble Pit	13,38
	281-3F	Return Water Retention Basin	5,38,45
	288-F	Ash Disposal Basin	6,38,45
	288-1F	Alternate Ash Disposal Basin	7,38,45
	289-F	Coal Storage Runoff Containment Basin	8,38,45
	904-41G	Seepage Basin No. 1	25,38,47
	904-42G	Seepage Basin No. 2	25,38,47
	904-43G	Seepage Basin No. 3	25,38,47
	904-49G	Seepage Basin northeast of 221-F	25,38,47
	904-74G	Acid/Caustic Retention Basin	9,38,47
G	080-17G	Pesticide Disposal Pit	17,42,44
	080-17.1G	Pesticide Disposal Pit	17,42,44
	080-18G	Toxic Chemical Disposal Pit	17,42,44

<u>Area</u>	<u>Building No.</u>	<u>Name</u>	<u>Page No.</u>
G cont'd	080-18.1G	Toxic Chemical Disposal Pit	17,42,44
	080-18.2G	Toxic Chemical Disposal Pit	18,42,44
	080-18.3G	Toxic Chemical Disposal Pit	18,42,44
	080.19G	Hazardous Metal Disposal Pit	19,42,44
	080-21G	Asbestos Disposal Pit No. 1	20,38
	080-22G	Asbestos Disposal Pit No. 2	20,38
	631-8G	River Road Rubble Pit	15,36
	643-G	Burial Ground No. 1	30,38,46
	643-7G	Burial Ground No. 2	30,38,46
	740-G	Sanitary Landfill	21,34,46
	904-111G	Chemical Waste Basin Near Road A	27,41
	Site 51	Gunsite 51	23,41,48
	Site 72	Gunsite 72	23,33,48
	Site 102	Navy Site	23,40,48
	Near Forestry Headquarters	Bone Yard	22,35
H	281-3H	Return Water Retention Basin	5,39,45
	288-H	Ash Disposal Basin	7,39,45
	289-H	Coal Storage Runoff Containment Basin	8,39,45
	904-44G	Seepage Basin No. 1	25,38,47
	904-45G	Seepage Basin No. 2	25,38,47
	904-46G	Seepage Basin No. 3	26,38,47
	904-56G	Seepage Basin No. 4	26,38,47
	904-75G	Acid/Caustic Retention Basin	9,39,48

Area	Building		Page
	NO.	Name	No.
K	131-K	Rubble Pit	11,42,44
	188-K	Ash Disposal Basin	6,41,45
	189-K	Coal Storage Runoff Containment Basin	8,41,45
	643-1G	Bingham Pump Outage Pit	28,42
	904-65G	Seepage Basin	4,41,47
	904-80G	Acid/Caustic Retention Basin	9,42,48
	904-88G	Containment Retention Basin	4,42,48
	L	131-L	Rubble Pit NO. 1
131-1L		Rubble Pit No. 2	11,42
131-2L		Compressed Gas Cylinder Pit	19,42
131-3L		Rubble Pit No. 3	11,42
131-4L		Rubble Pit No. 4	11,42
188-L		Ash Disposal Basin	6,42,45
643-2G		Bingham Pump Outage Pit No. 1	28,42
643-3G		Bingham Pump Outage Pit No. 2	28,42
904-64G		Seepage Basin	4,42,47
904-79G		Acid/Caustic Retention Basin	9,42,48
904-83G		Disposal Pit for 717-G	27,42,48
P		131-P	Rubble Pit No. 1
	131-1P	Erosion Control Rubble Pit	24,43
	188-P	Ash Disposal Basin	6,43,45
	189-P	Coal Storage Runoff Containment Basin	8,43,45