

**ENVIRONMENTAL COMPLIANCE & AREA COMPLETION PROJECTS (EC&ACP) STANDARD OPERATING PROCEDURES, VOL. I**

Manual: C3  
 Procedure: ER-IDS-019-053  
 Revision: 2  
 Effective Date: 06/01/2016  
 Type-Class: Form  
 Page: 1 of 3

**L-AREA EARLY CONSTRUCTION AND OPERATIONAL DISPOSAL SITE (ECODS) L-1 OPERABLE UNIT FIELD INSPECTION CHECKLIST**

**WORKING COPY**

This document is a Working Copy. Prior to start of work, verify this is the latest revision per the Procedure Index.

*Charles P. Carter*

Verified By

10-9-17

Date

**CAUTION**

The Inspector shall IMMEDIATELY notify the Post-Closure Manager and Environmental Compliance Authority if there has been a breach or compromise of the institutional controls of this waste unit. This notification shall be in accordance with Savannah River Site post-closure inspection procedures.

**NOTE**

1. Manual C3, ER-SOP-019, *Waste Unit Inspection and Maintenance*, shall be referred to for inspection details.
2. Steps in this checklist may be completed concurrently or in any order.

**SCHEDULED**

**UNSCHEDULED**

A = Satisfactory	A or X	Observation/Corrective Action Taken
X = Unsatisfactory (Explanation required)		
1. Verify roads are accessible. ( <i>Corrective Measures Implementation Report (CMIR)/Remedial Action Completion Report (RACR)</i> , Section 7, Note 1, may be referenced) SRNS-RP-2010-01524, 1B, and 1C Operable Unit (U).	A	
2. Verify waste unit warning signs (6) are in acceptable condition, have correct information, and are legible from a distance of 25 feet.	A	
3. Check survey boundary monuments for damage and visibility.	A	

L-Area Early Construction and Operational Disposal Site (ECODS) L-1 Operable Unit Field  
Inspection Checklist

Manual: C3  
Procedure: ER-IDS-019-053  
Revision: 2  
Page: 2 of 3

SCHEDULED

UNSCHEDULED

A = Satisfactory X = Unsatisfactory (Explanation required)	A or X	Observation/Corrective Action Taken
4. Verify there are no unauthorized excavations, digging, or construction activities within the ECOD L-1 boundaries.	A	
5. Verify signs of erosion or depression (subsidence) is not present. (CMIR/RACR, Section 7, Item 5) SRNS-RP-2010-01524.	A	
6. Verify signs of burrowing or mounding animals are not present. (CMIR/RACR, Section 7, Item 4) SRNS-RP-2010-01524.	A	
7. Other	NO FURTHER ENTRIES	CPC 10-9-17

Inspected By

CHARLES P. CARTER / Richard Feagly (Print Name)	Charles P. Carter / Feagly (Signature)	10-9-17 / 10-9-17 (Date)
--	---	-----------------------------

Review By Post-Closure Manager

George W Joyner (Print Name)	George W Joyner (Signature)	11/29/17 (Date)
---------------------------------	--------------------------------	--------------------

L-Area Early Construction and Operational Disposal Site (ECODS) L-1 Operable Unit Field Inspection Checklist

Manual: C3  
Procedure: ER-IDS-019-053  
Revision: 2  
Page: 3 of 3

L-Area ECODS L-1 Operable Unit

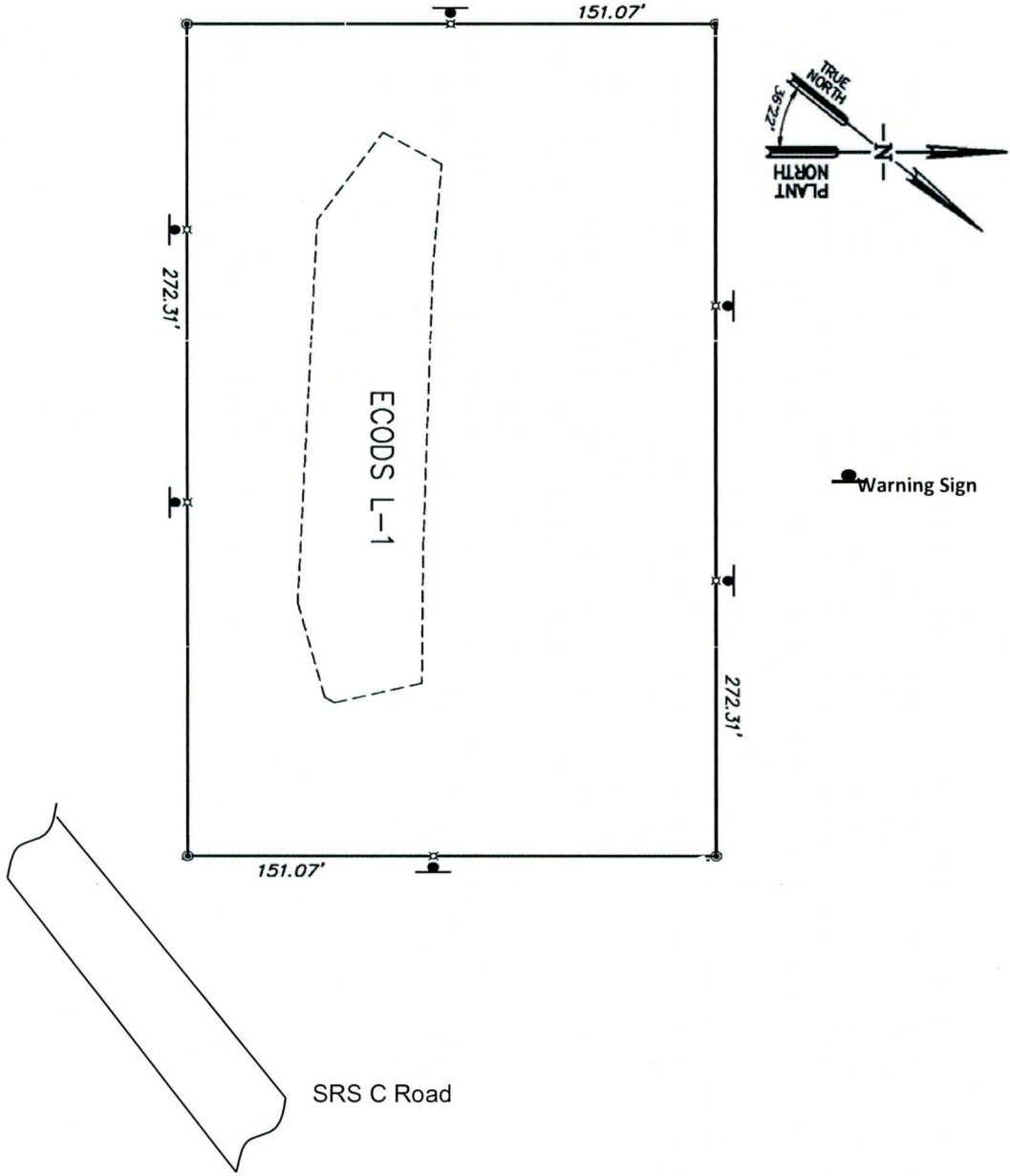

NOTES:

*NO ENTRANCES*

*CPL 10-9-17*