

**ENVIRONMENTAL COMPLIANCE & AREA COMPLETION PROJECTS (EC&ACP) STANDARD
OPERATING PROCEDURES, VOL. I**
Manual: C3
Procedure: ER-IDS-019-031
Revision: 7
Effective Date: 01/13/2022
Type-Class: Checklist
Page: 1 of 3
**CENTRAL SHOPS BURNING RUBBLE PITS OPERABLE UNITS (BLDGS. 631-1G AND 631-3G)
FIELD INSPECTION CHECKLIST**
WORKING COPY

This document is a Working Copy. Prior to start of work, verify this is the latest revision per the Procedure Index.

Dylan Price

 Verified By

10/16/2024

 Date

CAUTION

The Inspector is required to IMMEDIATELY notify the Post-Closure Manager and Environmental Compliance Authority if there has been a breach or compromise of the institutional controls of this waste unit. This notification is made in accordance with Savannah River Site post-closure inspection procedures.

NOTE

1. Manual C3, Volume 1, Procedure ER-SOP-019, Waste Unit and IOU Inspection and Maintenance, is referenced for inspection details.
2. Monitoring wells associated with this waste unit are maintained in accordance with Environmental Compliance & Area Completion Projects Monitoring Well Procedures.
3. Steps in this checklist may be completed concurrently or in any order.

 SCHEDULED
 UNSCHEDULED

A = Satisfactory		A or X	Observation/Corrective Action Taken
X = Unsatisfactory (Explanation required)			
1.	VERIFY roads to waste unit are accessible.	A	
2.	VERIFY that the waste unit signs (13) are in acceptable condition, have the correct information, and are legible from a distance of 25 feet.	A	

Central Shops Burning Rubble Pits Operable Units (Bldgs. 631-1G and 631-3G) Field Inspection Checklist

Manual: C3
 Procedure: ER-IDS-019-031
 Revision: 7
 Page: 2 of 3

SCHEDULED

UNSCHEDULED

A = Satisfactory X = Unsatisfactory (Explanation required)		A or X	Observation/Corrective Action Taken
3.	CHECK the survey benchmarks for damage and visibility.	A	
4.	VERIFY that there are no unauthorized excavations, digging, or construction activities on the soil cover.	A	
5.	CHECK the integrity of vegetative cover and drainage ditches for the presence of excessive erosion, sediment buildup, and any debris restricting water flow.	A	
6.	VERIFY that no woody vegetation is growing on the soil cover, AND REMOVE OR IDENTIFY as needed.	A	
7.	VISUALLY CHECK vegetative cover for grass density with no bare spots more than 3 feet by 3 feet in area. (The height of the vegetative cover should not impair the visual inspection of the soil cover. This will be determined by the Inspector.)	A	
8.	CHECK the soil cover for signs of erosion or depressions (subsidence).	A	
9.	CHECK for evidence of burrowing animals.	A	
10.	Other. none	A	

Inspected By

Dylan Price (Print Name)	<i>Dylan Price</i> (Signature)	10/16/2024 (Date)
-----------------------------	-----------------------------------	----------------------

Reviewed By Post-Closure Manager

Brian Hanshew (Print Name)	<i>BH</i> (Signature)	10/31/2024 (Date)
-------------------------------	--------------------------	----------------------

Central Shops Burning Rubble Pits Operable Units (Bldgs.
631-1G and 631-3G) Field Inspection Checklist

Manual: C3
Procedure: ER-IDS-019-031
Revision: 7
Page: 3 of 3

CENTRAL SHOPS BURNING RUBBLE PITS OPERABLE UNITS
(BLDGS. 631-1G & 631-3G)

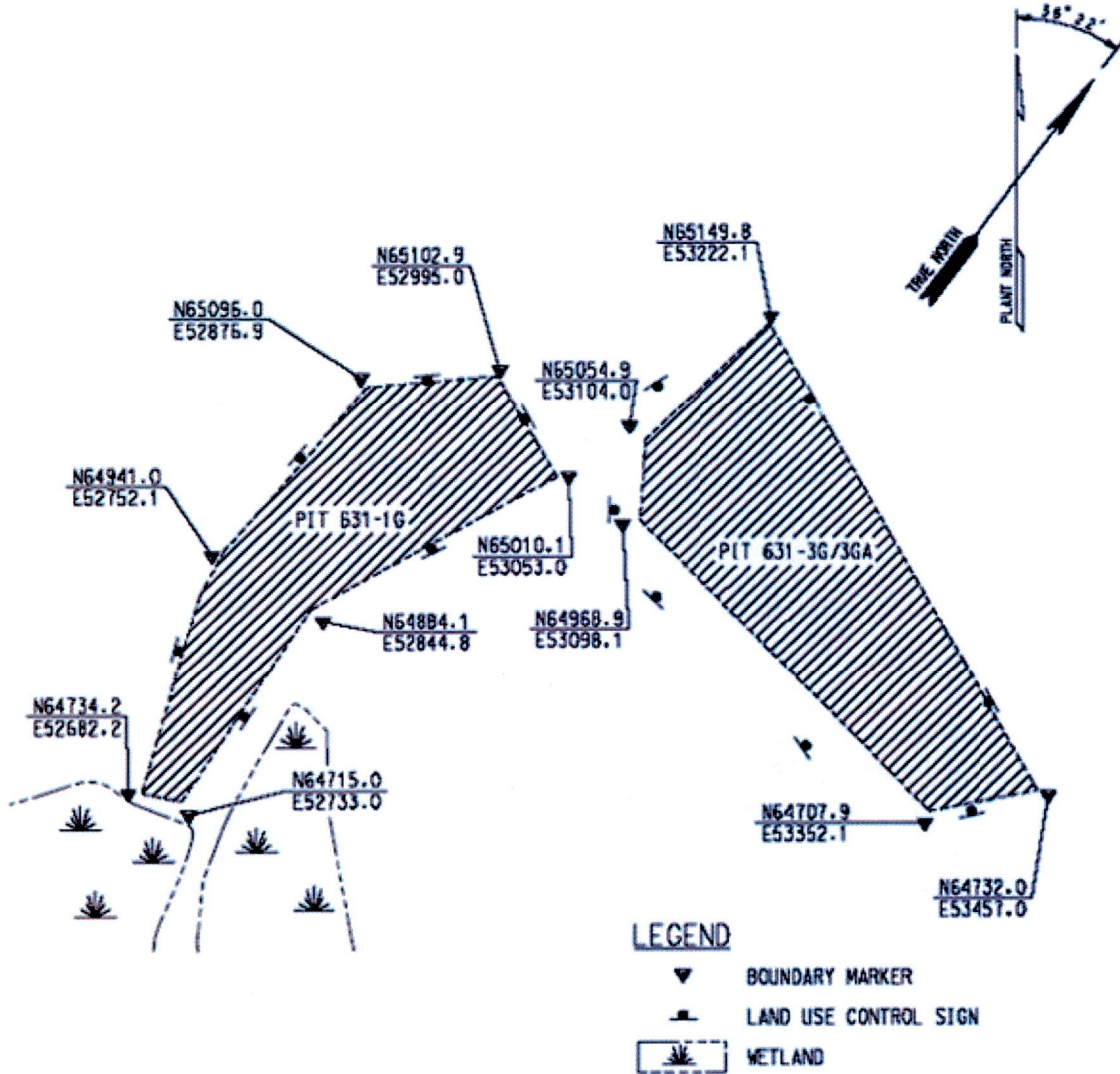

NOTES: None
