

**ENVIRONMENTAL COMPLIANCE & AREA COMPLETION PROJECTS (EC&ACP) STANDARD  
OPERATING PROCEDURES, VOL. I**
**Manual:** C3  
**Procedure:** ER-IDS-019-051  
**Revision:** 2  
**Effective Date:** 06/01/2016  
**Type-Class:** Form  
**Page:** 1 of 3

**R-AREA OPERABLE UNIT ASH BASIN 188-R FIELD INSPECTION CHECKLIST**
**WORKING COPY**

This document is a Working Copy. Prior to start of work, verify this is the latest revision per the Procedure Index.

*Charles P. Carter*  
 Verified By

*12-26-18*  
 Date

**CAUTION**

The Inspector shall IMMEDIATELY notify the Post-Closure Manager and Environmental Compliance Authority if there has been a breach or compromise of the institutional controls of this waste unit. This notification shall be in accordance with Savannah River Site post-closure inspection procedures.

**NOTE**

1. Manual C3, ER-SOP-019, *Waste Unit Inspection and Maintenance*, shall be referred to for inspection details.
2. Steps in this checklist may be completed concurrently or in any order.

 **SCHEDULED**
 **UNSCHEDULED**

A = Satisfactory X = Unsatisfactory (Explanation required)		A or X	Observation/Corrective Action Taken
1.	Verify roads are accessible.	A	
2.	Verify waste unit warning signs (10) are in acceptable condition, have correct information, and are legible from a distance of 25 feet.	A	
3.	Check survey boundary monuments for damage and visibility.	A	

## R-Area Operable Unit Ash Basin 188-R Field Inspection Checklist

Manual: C3  
 Procedure: ER-IDS-019-051  
 Revision: 2  
 Page: 2 of 3

 SCHEDULED

 UNSCHEDULED

A = Satisfactory X = Unsatisfactory (Explanation required)	A or X	Observation/Corrective Action Taken
4. Visually check vegetative cover for grass density with bare spots no more than 3 feet by 3 feet. No woody vegetation is growing on basin cover. Remove or identify as needed. The height of vegetation cover should not impair visual inspection of closure. This will be determined by the EC&ACP Post Closure Inspector.	A	
5. Verify R-Area Ash Basin soil cover has no signs of unacceptable erosion (subsidence).	A	
6. Check integrity of drainage ditches, catch basin, grating inlet for presence of excessive erosion, sediment build-up, and any debris restricting water flow.	X	HOG DAMAGE AROUND CATCH BASIN + GRATING INLET SEE MAP NOTE: ① REF. MAINT. REGISTER PL-2018-00145
7. Verify signs of burrowing or mounding animals are not present on basin cover.	X	ACTIVE ANT MOUNDS ON SOIL COVER. SEE MAP NOTE: ② REF. MAINT REGISTER PL-2018-00146
8. Verify there are no unauthorized excavations, digging, or construction activities within the R-Area Ash Basin boundaries.	A	
9. Other <u>NO FURTHER ENTRIES</u>		CPL 12-26-18

## Inspected By

CHARLES P. CARTER  
 (Print Name)

Charles P. Carter  
 (Signature)

12-26-18  
 (Date)

## Review By Post-Closure Manager

George W. Joyner  
 (Print Name)

George W. Joyner  
 (Signature)

1/3/19  
 (Date)

R-Area Operable Unit Ash Basin 188-R Field Inspection  
Checklist

Manual: C3  
Procedure: ER-IDS-019-051  
Revision: 2  
Page: 3 of 3

R-Area Operable Unit Ash Basin 188-R

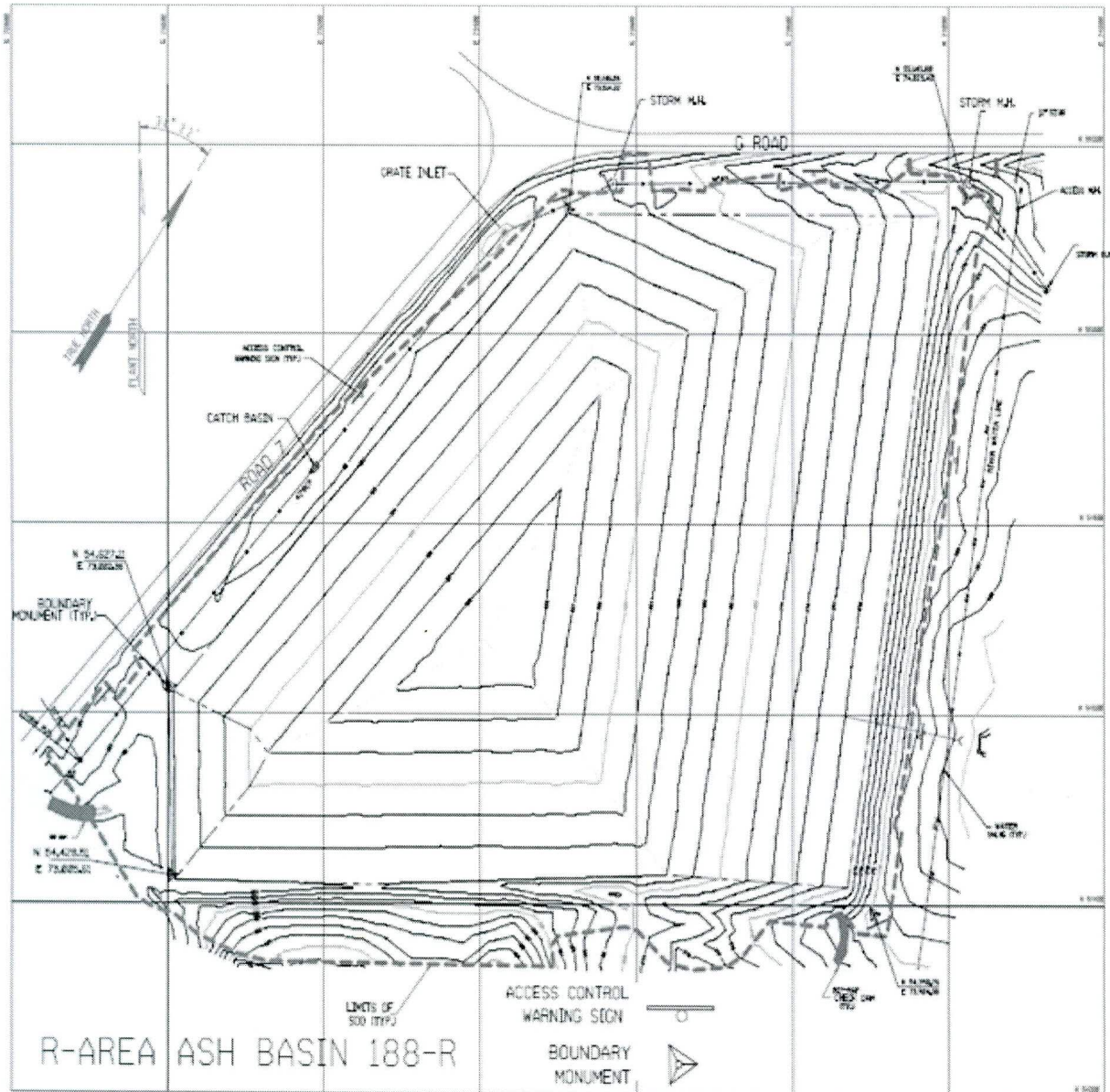

NOTES: (1) = HOLE DAMAGE AROUND CATCH BASIN + GRATING INLET.  
USERS WILL MAKE REPAIRS WITH TOP SOIL, GRASS SEED + STRAW.  
(2) ACTIVE ANT MOUNDS ON SOIL COVER. APPLIED 6 LBS. OF  
EXTINGUISH ANT BAIT.

~~NO FURTHER ENTRIES~~

C. PL 12-26-18

# POST CLOSURE MAINTENANCE REGISTER

**Index Number**

**Unit Name**

329 R AREA OPERABLE UNIT ASH BASIN 188-R

**Watershed** LOWER THREE RUNS

AHA # AHA-ER-5534

Work Order # N/A

Work Group POST CLOSURE MAINTENANCE

Priority Medium

RCRA NO

**Maintenance Number** PC-2018-00146

**Maintenance Status** Complete

Inspection Date 12/26/2018

**Chemical Type** Pesticide

Completion Date 12/26/2018

**Chemical Name** Extinguish

**Amount Used** 6.0 Pounds

**Description Of Maintenance Item**

Active ant mounds on waste unit

**Maintenance Item Corrected**

Applied Extinguish Ant Bait

**Notes** New observation.

Approved by : George Joyner - ACP Post Closure Manager

Signature

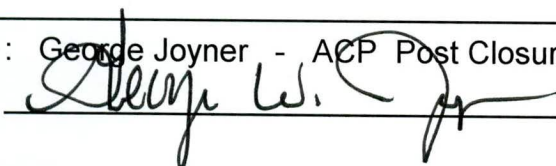

Approval date :

1/3/19