

ENVIRONMENTAL COMPLIANCE & AREA COMPLETION PROJECTS (EC&ACP) STANDARD OPERATING PROCEDURES, VOL. I

Manual: C3
 Procedure: ER-IDS-019-005
 Revision: 4
 Effective Date: 06/02/2016
 Type-Class: Form
 Page: 1 of 3

L-AREA BINGHAM PUMP OUTAGE PITS (BLDGS. 643-2G AND 643-3G) FIELD INSPECTION CHECKLIST

WORKING COPY

This document is a Working Copy. Prior to start of work, verify this is the latest revision per the Procedure Index.

Charles P. Carter
 Verified By

08/05/2019
 Date

CAUTION

The Inspector shall IMMEDIATELY notify the Post-Closure Manager and Environmental Compliance Authority if there has been a breach or compromise of the institutional controls of this waste unit. This notification shall be in accordance with Savannah River Site post-closure inspection procedures.

NOTE

1. Manual C3, ER-SOP-019, *Waste Unit Inspection and Maintenance*, shall be referred to for inspection details.
2. Monitoring wells associated with this waste unit are maintained in accordance with EC&ACP Monitoring Well Procedures.
3. Steps in this checklist may be completed concurrently or in any order.

SCHEDULED

UNSCHEDULED

A = Satisfactory X = Unsatisfactory (Explanation required)		A or X	Observation/Corrective Action Taken
1.	Verify roads to waste unit are accessible.	A	
2.	Verify that the waste unit signs (3) are in acceptable condition, have the correct information and are legible from a distance of 25 feet. Refer to Manual C1, Procedure ER-AP-127, <i>ACP Waste Unit Field Inspection and Maintenance</i> .	A	

L-Area Bingham Pump Outage Pits (Bldgs. 643-2G And 643-3G) Field Inspection Checklist

Manual: C3
 Procedure: ER-IDS-019-005
 Revision: 4
 Page: 2 of 3

SCHEDULED UNSCHEDULED

A = Satisfactory X = Unsatisfactory (Explanation required)	A or X	Observation/Corrective Action Taken
3. Verify that there is no excavating, digging or construction activity on the soil cover.	A	
4. Verify that no woody vegetation is growing on the soil cover. Remove or identify as needed.	A	
5. Visually check vegetative cover for grass density with no bare spots more than 3 feet by 3 feet in area. The height of the vegetation should not impair the visual inspection of the soil cover. This will be determined by the Inspector.	A	
6. Check the soil cover for signs of erosion or depressions (subsidence).	A	
7. Check for signs of burrowing animals.	A	
8. Other	NO FURTHER ENTRIES	

CPC 08/05/2019

Inspected By		
Charles P. Carter <i>(Print Name)</i>	 <i>(Signature)</i>	08/05/2019 <i>(Date)</i>

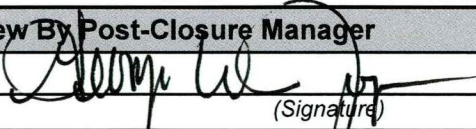
Review By Post-Closure Manager		
George W. Joyner <i>(Print Name)</i>	 <i>(Signature)</i>	8/5/19 <i>(Date)</i>

MAP L-AREA BINGHAM PUMP OUTAGE PITS (BLDG. 643-2G & 643-3G)

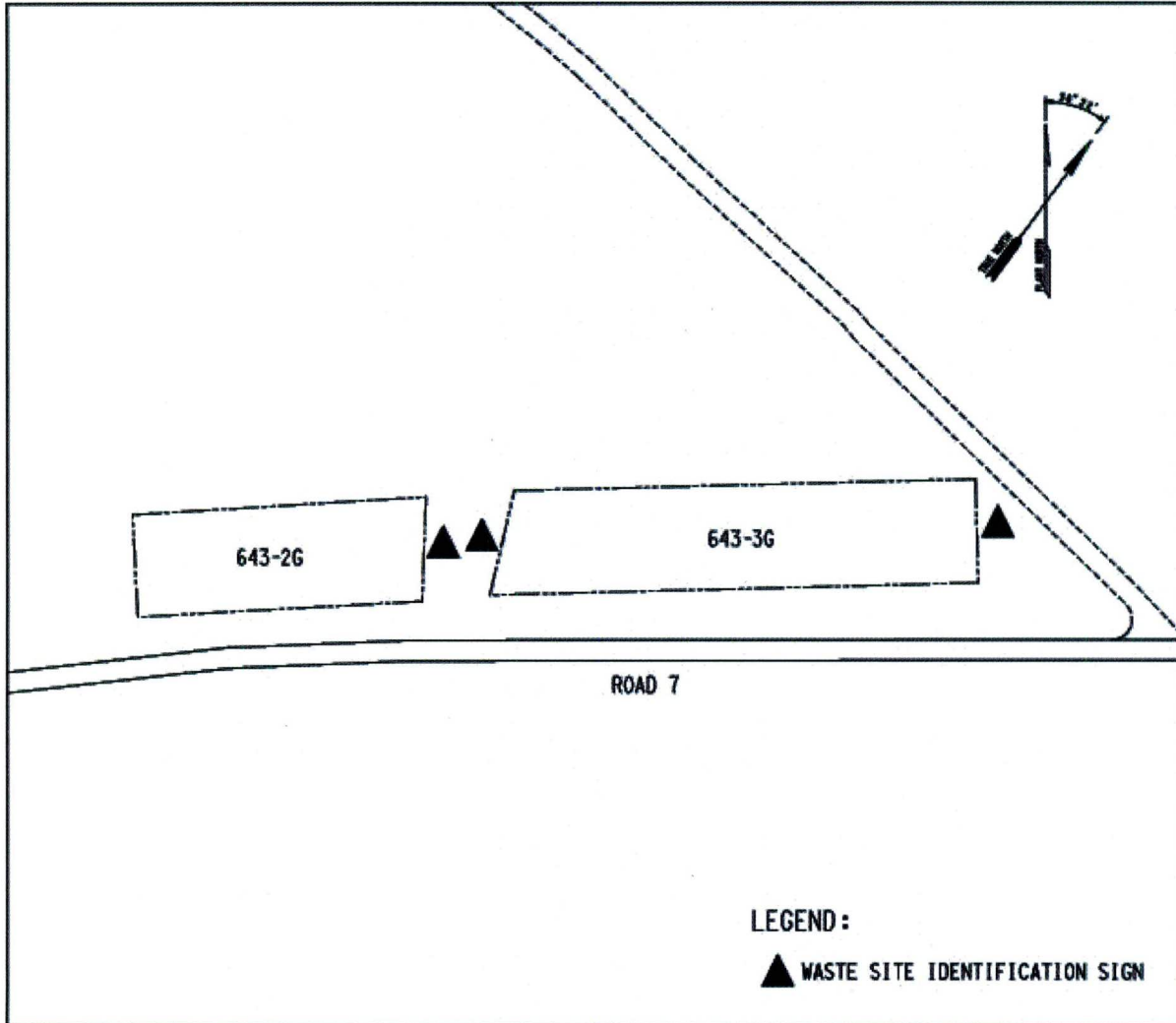

NOTES: _____

~~NO FURTHER ENTRIES~~

CPC 08/05/2019

Interactive Help is also available by placing your cursor over any [Blue-Underline Text](#) and clicking your mouse button.

Instructions FAQ		Request for Information Review and Release			Proc. Ref. 1B, 1.05 1B, 3.11 1B, 3.25	
Document Number (R) SRNS-J2000-2019-00602	Rev 0	Doc. Date (R) 08/05/2019	Requested Approval (R) 08/05/2019	Speed Chart Number (R) 07YXBPMDOC		
Title (R) VARIOUS FIELD INSPECTION CHECKLIST TO BE ENTERED INTO ARF (ADMINISTRATIVE RECORDS FILE)						
Change Author User ID	Primary Author/Contact Dexter Mcdaniel	Location 730-4B Rm 135	Phone Number (803) 952-7401	Organization Code F4113	Organization Archival & Acp Records Process	
Additional Authors		Additional Authors ' User IDs		Additional Authors ' Names:		
Invention Disclosure /Patent/Copyright Information						
Has an invention disclosure , patent application , or copyright application been submitted related to this information ? (R)		<input type="radio"/> Yes <input checked="" type="radio"/> No				
Do you intend to submit one ? (R)		<input type="radio"/> Yes <input checked="" type="radio"/> No				
Is this Scientific and Technical Information ? (R) (abstracts and slides are not STI) <input type="radio"/> Yes <input checked="" type="radio"/> No						
<input checked="" type="checkbox"/> - Administrative/Financial/Management/Environmental Report (Non - Scientific and Technical Information Reports only) Examples						
<input type="checkbox"/> - Engineering Drawing/Engineering Calculations						
<input type="checkbox"/> - Slide Presentation (includes STI Slide Presentations) / Marketing/Public Relations Materials Examples						
<input type="checkbox"/> - Multimedia/Video Examples						
<input type="checkbox"/> - Procedure/User Guide						
<input type="checkbox"/> - Abstract Examples						
<input type="checkbox"/> - Web Site/Page (External Only) URL						
Who is this information being released to and for what purpose? (R) THIS INFORMATION WILL BE INCLUDED IN THE ADMINISTRATIVE RECORD				Is release of information to a Foreign National planned? (R) <input type="radio"/> Yes <input checked="" type="radio"/> No		

FILE FOR PUBLIC VIEWING.

Document to be Reviewed		Other Attachments	Click to add comments for the reviewers	
Add Document (PDF ONLY) View Document (name the file the document number) Viewable by Submitter , Author & Approvers Only)		<i>No Attachment</i>		
Approval Section *NA indicates that the approval is not applicable to this request				
Approver Title	Approver	Approver Title	Approver	
Classification	Daniel Campbell	SRNS-PAD	NA	
Export Control	Daniel Campbell	SRR-PAD	NA	
OPSEC	Daniel Campbell	STI Reviewer	NA	
Web External	NA	DOE-OEA	NA	
SRNL-PAD	NA	DOE-TIO	NA	

Comments

Submitted By

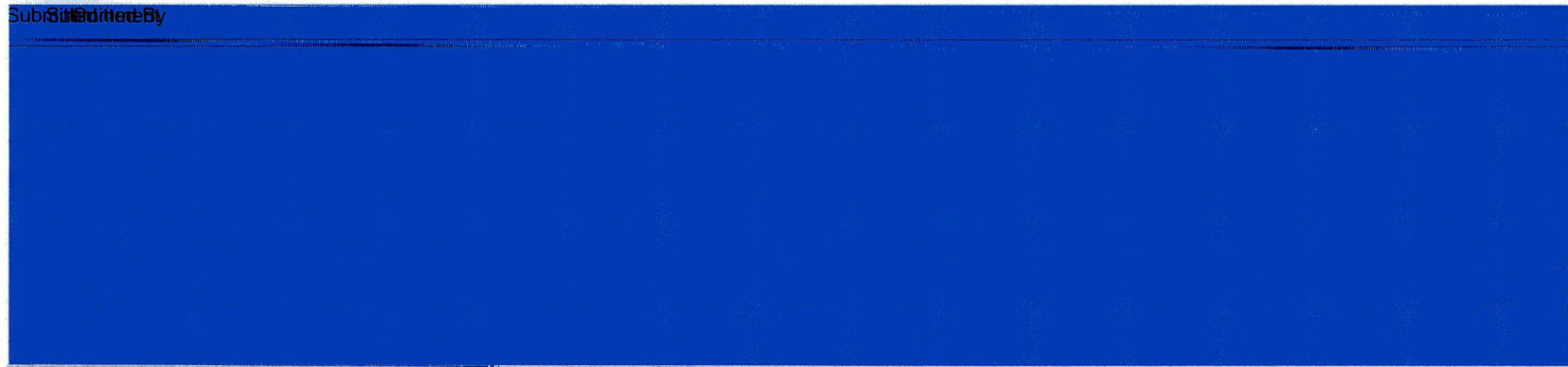

Submitter Name



Submitter's User ID	Submitter	Location	Phone No.	Org Code	Organization
J0938	Dexter Mcdaniel	730-4B Rm 135	(803) 952-7401	F4113	Archival & Acp Records Process

Admin Only ==>

Review Document	List of Attachment Types
-----------------	--------------------------

Request for Information Review and Release: Approved on 08/05/2019				
Approvers	Assigned	Received	Status Changed	Status
Daniel Campbell	08/05/2019 03:32:24 PM	08/05/2019 09:37:46 PM	08/05/2019 09:38:16 PM	Approved