

**ENVIRONMENTAL COMPLIANCE & AREA COMPLETION PROJECTS (EC&ACP) STANDARD
OPERATING PROCEDURES, VOL. I**
Manual: C3
Procedure: ER-IDS-019-026
Revision: 4
Effective Date: 06/02/2016
Type-Class: Form
Page: 1 of 3

**R-BINGHAM PUMP OUTAGE PIT AND UNKNOWN PITS OPERABLE UNIT FIELD INSPECTION
CHECKLIST**
WORKING COPY

This document is a Working Copy. Prior to start of work, verify this is the latest revision per the Procedure Index.

Charles F. Carter

Verified By

6-14-18

Date

CAUTION

The Inspector shall IMMEDIATELY notify the Post-Closure Manager and Environmental Compliance Authority if there has been a breach or compromise of the institutional controls of this waste unit. This notification shall be in accordance with Savannah River Site post-closure inspection procedures.

NOTE

1. Manual C3, ER-SOP-019, *Waste Unit Inspection and Maintenance*, shall be referred to for inspection details.
2. Monitoring wells associated with this waste unit are maintained in accordance with EC&ACP Monitoring Well Procedures.
3. Steps in this checklist may be completed concurrently or in any order.



SCHEDULED



UNSCHEDULED

A = Satisfactory X = Unsatisfactory (Explanation required)		A or X	Observation/Corrective Action Taken
1.	Verify roads to waste unit are accessible.	A	
2.	Verify that the waste unit signs (4) are in acceptable condition, have the correct information and are legible from a distance of 25 feet.	A	
3.	Verify there is no unauthorized digging, excavation or construction activities on the soil cover.	A	

R-Bingham Pump Outage Pit and Unknown Pits Operable Unit Field Inspection Checklist

Manual: C3
 Procedure: ER-IDS-019-026
 Revision: 4
 Page: 2 of 3

SCHEDULED UNSCHEDULED

A = Satisfactory X = Unsatisfactory (Explanation required)		A or X	Observation/Corrective Action Taken
4.	Verify that no woody vegetation is growing on the soil cover. Remove or identify as needed.	A	
5.	Visually check vegetative cover for grass density with no bare spots more than 3 feet by 3 feet in area. The height of the vegetation should not impair the visual inspection of the soil cover. This will be determined by the Inspector.	A	
6.	Check the soil cover for signs of erosion or depressions (subsidence).	A	
7.	Check for signs of burrowing animals.	X	ACTIVE ANT MOUNDS ON SOIL COVER. SEE MAP NOTE (D) REF. MAINT REGISTER PC-2018-00057
8.	Other NO FURTHER ENTRIES		CPC 6-14-18

Inspected By		
CHARLES P. CARTER	<i>Charles P. Carter</i>	6-14-18
(Print Name)	(Signature)	(Date)

Review By Post-Closure Manager		
George W Joyner	<i>George W Joyner</i>	6/25/18
(Print Name)	(Signature)	(Date)

R-Bingham Pump Outage Pit and Unknown Pits Operable Unit Field Inspection Checklist

Manual: C3
Procedure: ER-IDS-019-026
Revision: 4
Page: 3 of 3

MAP R-BINGHAM PUMP OUTAGE PITS (643-8G, 643-9G AND 643-10G) AND R-AREA UNKNOWN PITS 1, 2 & 3 (RUNK 1, 2, & 3)

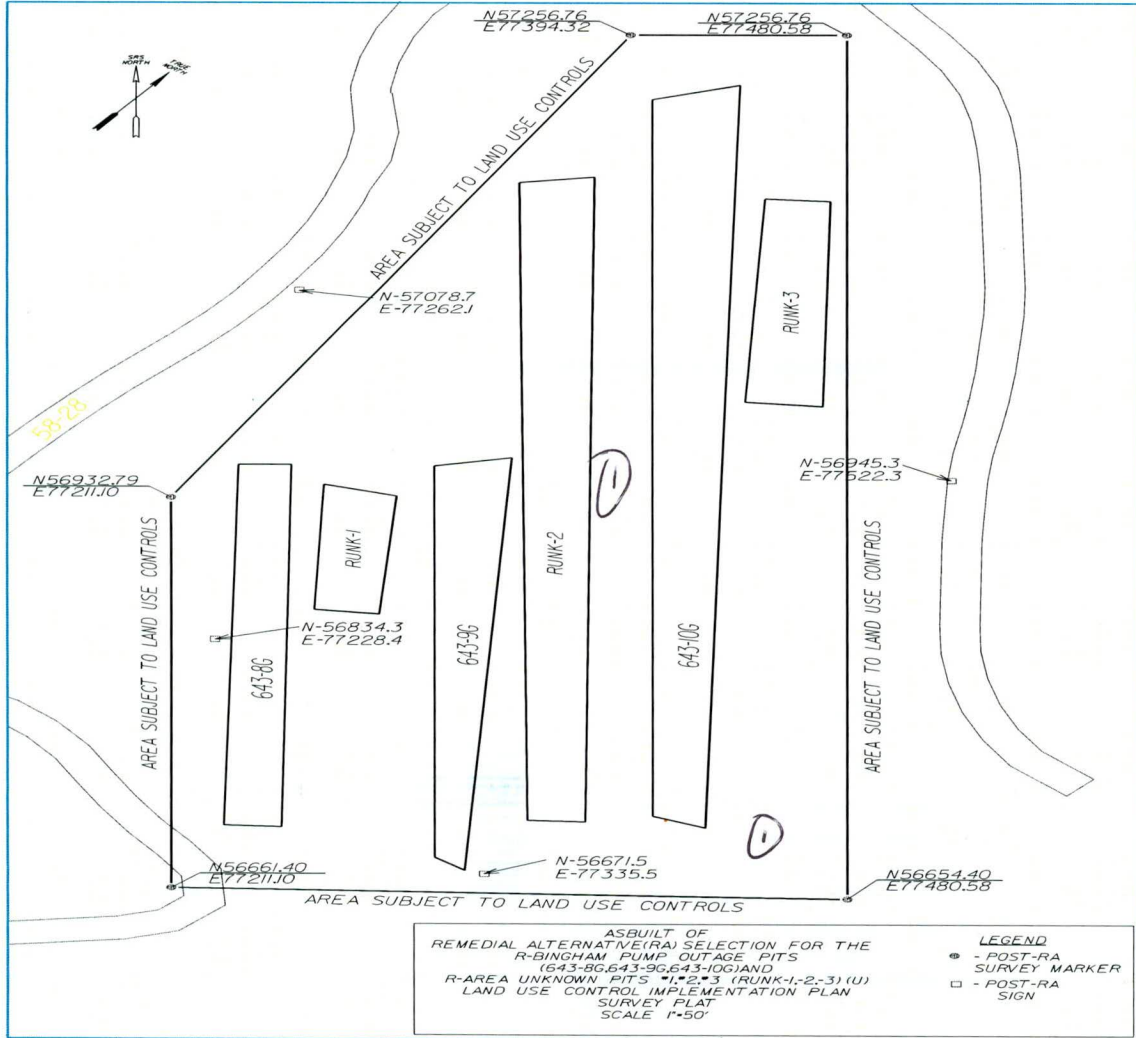

NOTES: ① = ACTIVE ANT MOUNDS ON SOIL COVER.
Applied 15 lbs of EXTINGUISH ANT BAIT.

~~NO FURTHER ENTRIES~~

OPC 6-14-18

POST CLOSURE MAINTENANCE REGISTER

Index Number	Unit Name
113	R-AREA BINGHAM PUMP OUTAGE PITS - 643-10G
115	R-AREA BINGHAM PUMP OUTAGE PITS - 643-9G
114	R-AREA BINGHAM PUMP OUTAGE PITS - 643-8G

Watershed LOWER THREE RUNS

AHA #	NA
Work Order #	N/A
Work Group	POST CLOSURE MAINTENANCE
Priority	Medium
RCRA	NO

Maintenance Number	PC-2018-00057	Maintenance Status	Complete
Inspection Date	6/14/2018	Chemical Type	Pesticide
Completion Date	6/14/2018	Chemical Name	Extinguish
		Amount Used	0.5 Pounds

Description Of Maintenance Item
Active ant mounds on waste unit

Maintenance Item Corrected
Applied Extinguish ant bait pesticide

Notes New observation.

Approved by : George Joyner - ACP Post Closure Manager

Signature

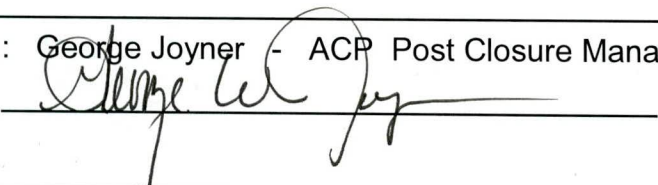

Approval date :

7/9/18