

**ENVIRONMENTAL COMPLIANCE & AREA COMPLETION PROJECTS (EC&ACP) STANDARD
OPERATING PROCEDURES, VOL. I**
Manual: C3
Procedure: ER-IDS-019-016
Revision: 4
Effective Date: 06/01/2016
Type-Class: Form
Page: 1 of 3
C-AREA BURNING RUBBLE PIT (BLDG. 131-C) FIELD INSPECTION CHECKLIST
WORKING COPY

This document is a Working Copy. Prior to start of work, verify this is the latest revision per the Procedure Index.



Verified By

05/20/2020

Date

CAUTION

The Inspector shall IMMEDIATELY notify the Post-Closure Manager and Environmental Compliance Authority if there has been a breach or compromise of the institutional controls of this waste unit. This notification shall be in accordance with Savannah River Site post-closure inspection procedures.

NOTE

1. Manual C3, ER-SOP-019, *Waste Unit Inspection and Maintenance*, shall be referred to for inspection details.
2. Monitoring wells associated with this waste unit are maintained in accordance with EC&ACP monitoring well procedures.
3. Steps in this checklist may be completed concurrently or in any order.

 SCHEDULED
 UNSCHEDULED

A = Satisfactory X = Unsatisfactory (Explanation required)		A or X	Observation/Corrective Action Taken
1.	Verify roads are accessible.	A	
2.	Verify waste unit signs (4) are in acceptable condition, have correct information, and are legible from a distance of 25 feet.	A	

C-Area Burning Rubble Pit (Bldg. 131-C) Field Inspection Checklist

Manual: C3
 Procedure: ER-IDS-019-016
 Revision: 4
 Page: 2 of 3

 SCHEDULED

 UNSCHEDULED

A = Satisfactory X = Unsatisfactory (Explanation required)	A or X	Observation/Corrective Action Taken
3. Verify there is no excavating, digging, or construction activity on soil cover.	A	
4. Verify no woody vegetation is growing on the soil cover. Remove or identify as needed.	A	
5. Visually check vegetative cover for grass density with no bare spots more than 3 feet by 3 feet in area. The height of vegetation should not impair visual inspection of soil cover. This will be determined by the Inspector.	A	
6. Check soil cover for signs of erosion or depressions (subsidence).	A	
7. Check for signs of burrowing animals.	X	Active ant mounds on soil cover See map note:1 Ref. Maint. Register: PC-2020-00033
8. Other	NO FURTHER ENTRIES	CPC 05/20/2020

Inspected By

Charles P. Carter (Print Name)	<i>Charles P. Carter</i> (Signature)	05/20/2020 (Date)
-----------------------------------	---	----------------------

Review By Post-Closure Manager

George W. Joyner (Print Name)	<i>George W. Joyner</i> (Signature)	5/27/20 (Date)
----------------------------------	--	-------------------

C-Area Burning Rubble Pit (Bldg. 131-C) Field Inspection Checklist

Manual: C3
Procedure: ER-IDS-019-016
Revision: 4
Page: 3 of 3

Map of C-Area Burning Rubble Pit (Bldg. 131-C)

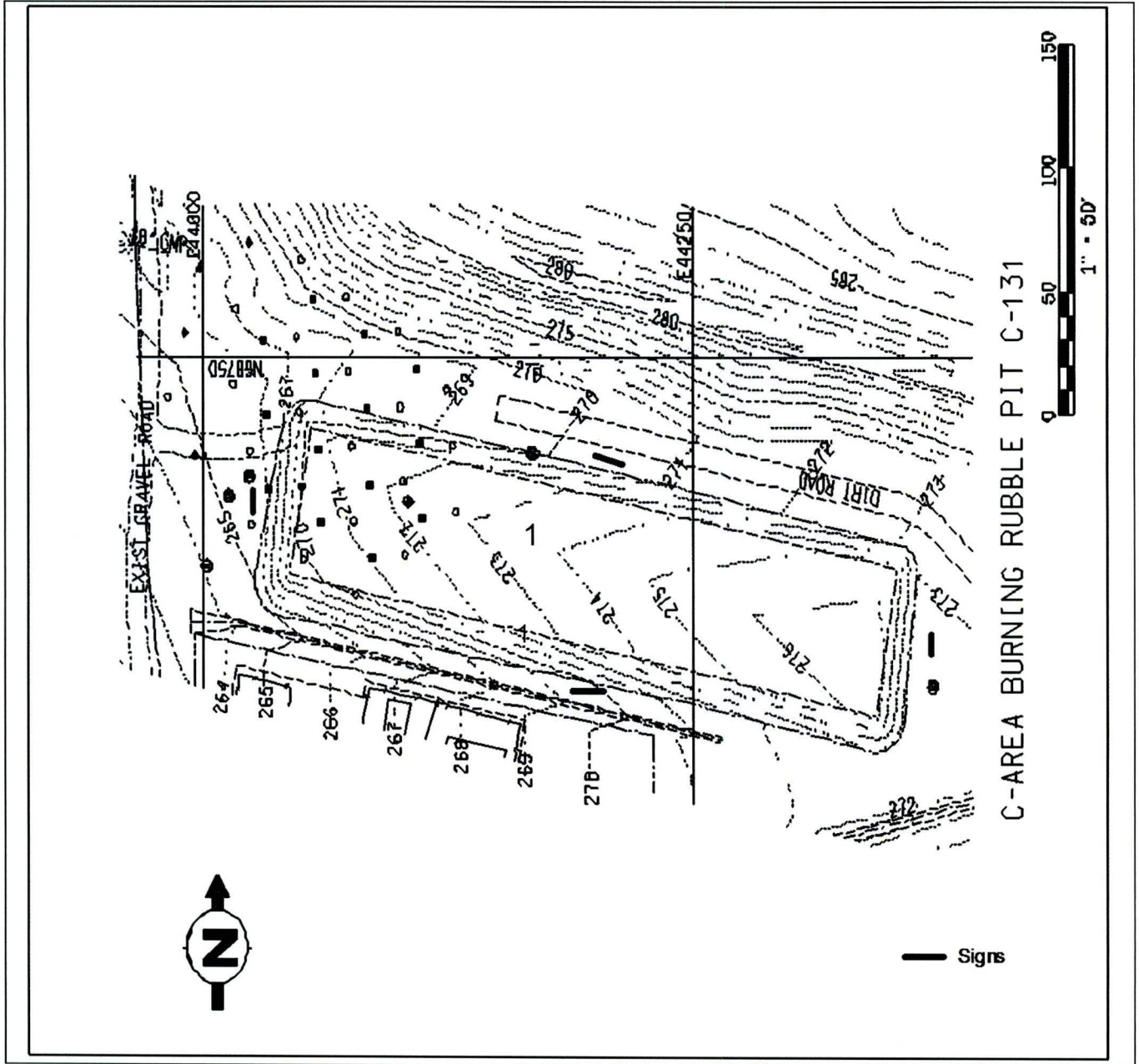

NOTES: 1=Active ant mounds on soil cover. Applied 0.5 lbs. of Extinguish ant bait.

NO FURTHER ENTRIES

POST CLOSURE MAINTENANCE REGISTER

Index Number

Unit Name

51 C -AREA BURNING/RUBBLE PIT - 131 - C

Watershed FOURMILE BRANCH

AHA # AHA-ER-5534
 Work Order # NA
 Work Group POST CLOSURE MAINTENANCE
 Priority Medium
 RCRA NO

Maintenance Number PC-2020-00033

Maintenance Status Complete

Inspection Date 5/20/2020

Chemical Type Pesticide

Completion Date 5/20/2020

Chemical Name Extinguish

Amount Used 0.5 Pounds

Description Of Maintenance Item

Active ant mounds on waste unit

Maintenance Item Corrected

Applied Extinguish pesticide

Notes New observation

Approved by : George Joyner - ACP Post Closure Manager

Signature

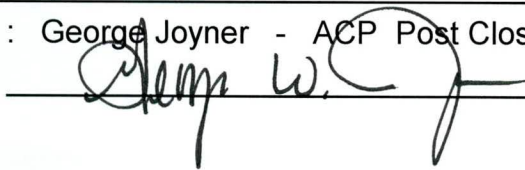

Approval date :

~~5/20/~~ 5/27/20
 5/27/20