

**ENVIRONMENTAL COMPLIANCE & AREA COMPLETION PROJECTS (EC&ACP) STANDARD
OPERATING PROCEDURES, VOL. I**
Manual: C3
Procedure: ER-IDS-019-020
Revision: 6
Effective Date: 11/23/2020
Type-Class: Checklist
Page: 1 of 4
**METALLURGICAL LABORATORY HAZARDOUS WASTE MANAGEMENT FACILITY (HWMF) POST
CLOSURE FIELD INSPECTION CHECKLIST**
WORKING COPY

This document is a Working Copy. Prior to start of work, verify this is the latest revision per the Procedure Index.

Douglas E. Barron
Verified By

02/07/2023
Date

CAUTION

The Inspector will IMMEDIATELY notify the Post-Closure Manager and Environmental Compliance Authority if there has been a breach or compromise of the institutional controls of this waste unit. This notification will be in accordance with Savannah River Site post-closure inspection procedures.

NOTE

1. Manual C3, Volume 1, Procedure ER-SOP-019, Waste Unit and IOU Inspection and Maintenance, will be referred to for inspection details.
2. Monitoring wells associated with this waste unit are maintained in accordance with EC&ACP monitoring well procedures located at ACP Homepage.
3. Steps in this checklist may be completed concurrently or in any order.

 SCHEDULED
 UNSCHEDULED

A = Satisfactory X = Unsatisfactory (Explanation required)	A or X	Observation/Corrective Action Taken
1. VERIFY roads to waste unit are accessible.	A	
2. VERIFY signs on the fence are in acceptable condition and are legible from a distance of 25 feet. Signs must include "Danger Unauthorized Personnel Keep Out" and include Post Closure Manager and Savannah River Site Operations Center contact information.	A	

Metallurgical Laboratory Hazardous Waste Management Facility (HWMF) Post Closure Field Inspection Checklist

Manual: C3
 Procedure: ER-IDS-019-020
 Revision: 6
 Page: 2 of 4

SCHEDULED UNSCHEDULED

A = Satisfactory X = Unsatisfactory (Explanation required)		A or X	Observation/Corrective Action Taken
3.	VERIFY fence is in good condition (e.g., shows no signs of serious wear, no vegetative growth) and unattended gates are locked.	A	
4.	CHECK the soil cover and side slopes for signs of erosion, depression (subsidence) and evidence of burrowing animals.	X	Active Ant Mounds on Soil Cover See Map Note: 1 Reference Maintenance Register PC-2023-00014
5.	CHECK the integrity of drainage ditches for the presence of excessive erosion, sediment buildup, and any debris restricting water flow.	A	
6.	VERIFY that no woody vegetation is growing on the soil cover, AND REMOVE OR IDENTIFY as needed.	A	
7.	VISUALLY CHECK vegetative cover for grass density with no bare spots more than 3 feet by 3 feet in area. The height of the vegetation should not impair visual inspection of the soil cover. This will be determined by the Inspector.	A	
8.	VISUALLY PERFORM a condition check of the survey benchmarks for damage and visibility.	A	
9.	VERIFY annual topographic/subsidence survey has been performed by end of June for current year, AND VERIFY copies of survey results are in EC&ACP Document Control Center.	A	Completed 04/11/2022 SRNS-J2000-2022-00344

Metallurgical Laboratory Hazardous Waste Management Facility (HWMF) Post Closure Field Inspection Checklist

Manual: C3
 Procedure: ER-IDS-019-020
 Revision: 6
 Page: 3 of 4

SCHEDULED UNSCHEDULED

A = Satisfactory	A or X	Observation/Corrective Action Taken
X = Unsatisfactory (Explanation required)		
10. INSPECT A-08 Outfall Diversion Ditch for the presence of erosion and debris restricting water flow.	A	
11. Other		
NO FURTHER ENTRIES		
DEB 02/07/2023		

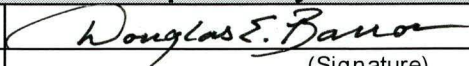
Inspected By		
Douglas E. Barron (Print Name)	 (Signature)	02/07/2023 (Date)

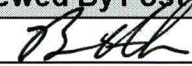
Reviewed By Post-Closure Manager		
Brian Hanshew (Print Name)	 (Signature)	2-16-2023 (Date)

Map of Metallurgical Laboratory HWMF

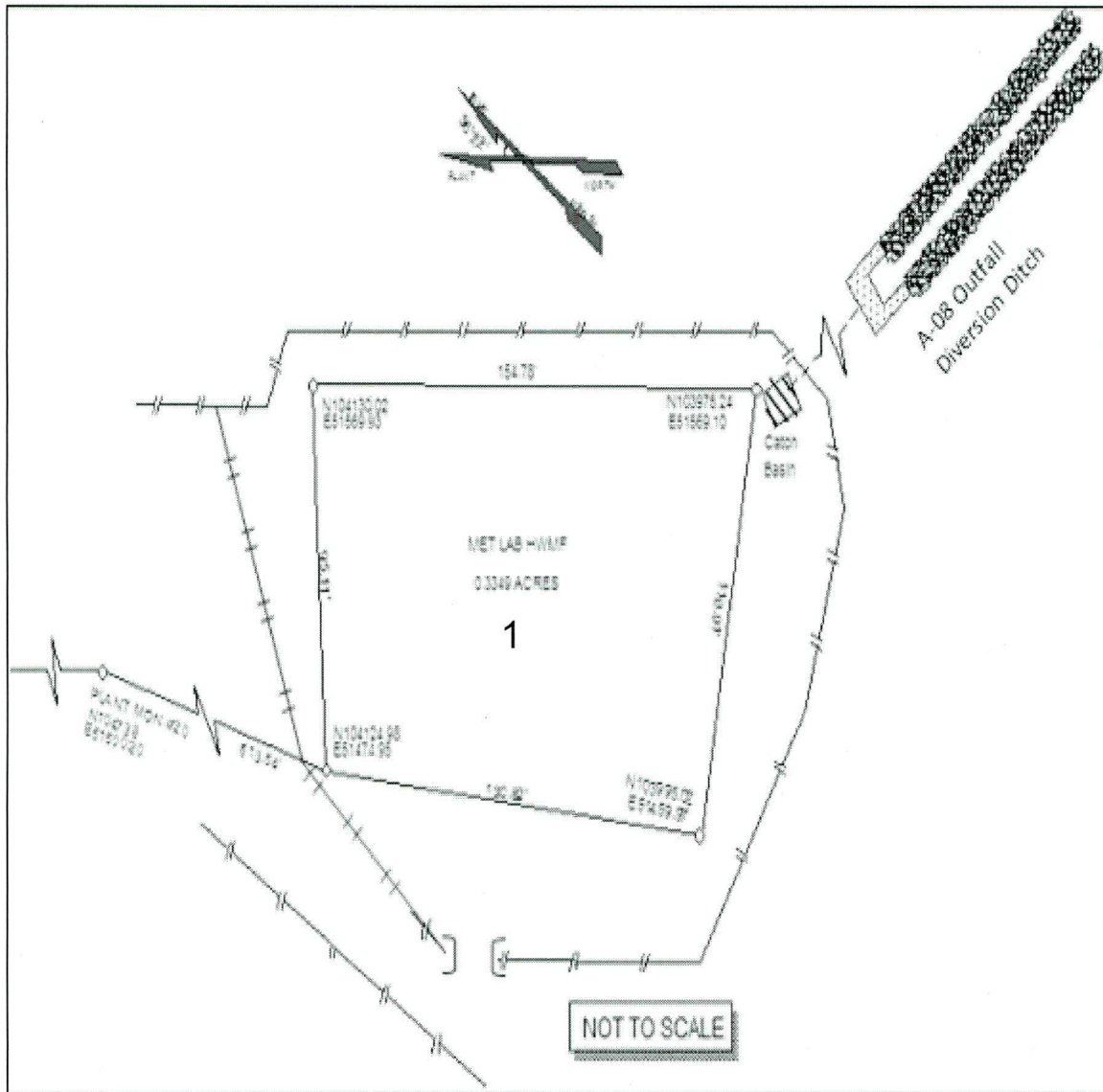

NOTES: 1= Active ant mounds on soil cover. Applied 0.5 lb. of Extinguish ant bait.

NO FURTHER ENTRIES

POST CLOSURE MAINTENANCE REGISTER

Index Number

Unit Name

15 METALLURGICAL LABORATORY HAZARDOUS WASTE MANAGEMENT FACILITY - 904-110G

Watershed UPPER THREE RUNS

AHA # AHA-ER-5534
Work Order # NA
Work Group POST CLOSURE MAINTENANCE
Priority Medium
RCRA YES

Maintenance Number	PC-2023-00014	Maintenance Status	Complete
Inspection Date	2/7/2023	Chemical Type	Pesticide
Completion Date	2/7/2023	Chemical Name	Extinguish
		Amount Used	.5 Pound

Description Of Maintenance Item
Active ant mounds on waste unit

Maintenance Item Corrected
Applied Extinguish pesticide

Notes ER-IDS-019-020

Approved by : Brian Hanshew - ACP Post Closure Manager

Signature



Approval date : 2/16/2023