

**ENVIRONMENTAL COMPLIANCE & AREA COMPLETION PROJECTS (EC&ACP) STANDARD OPERATING PROCEDURES, VOL. I**

Manual: C3  
 Procedure: ER-IDS-019-028  
 Revision: 4  
 Effective Date: 08/13/2018  
 Type-Class: Checklist  
 Page: 1 of 4

**SANITARY LANDFILL (BLDG. 740-G) FIELD INSPECTION CHECKLIST**

**WORKING COPY**

This document is a Working Copy. Prior to start of work, verify this is the latest revision per the Procedure Index.

*Charles P. Carter*

Verified By

*11-19-18*

Date

**CAUTION**

The Inspector shall IMMEDIATELY notify the Post Closure Manager and Environmental Compliance Authority if there has been a breach or compromise of the institutional controls of this waste unit. This notification shall be in accordance with Savannah River Site post closure inspection procedures.

**NOTE**

1. Manual C3, ER-SOP-019, Waste Unit Inspection and Maintenance, shall be referred to for inspection details.
2. Monitoring wells associated with this waste unit are maintained in accordance with EC&ACP monitoring well procedures.
3. Steps in this checklist may be completed concurrently or in any order.
4. Unsatisfactory conditions found during the inspection may be listed on the detailed map of the inspected area.

**SCHEDULED**

**UNSCHEDULED**

A = Satisfactory X = Unsatisfactory (Explanation required)		A or X	Observation/Corrective Action Taken
1.	Verify roads to waste unit are accessible.	A	
2.	Verify gates and fence are in Good condition and all unattended gates are locked.	X	GAP IN BOTTOM OF FENCE AT THE OUTLET DITCH TO THE SOUTH CATCH BASIN, ALSO SEVERAL ARMADILLO HOLES UNDER FENCE. SEE MAP NOTE: ①
3.	Inspect for excessive vegetative growth which may obstruct warning signs and visibility of inspection areas.	A	

## Sanitary Landfill (Bldg. 740-G) Field Inspection Checklist

Manual: C3  
 Procedure: ER-IDS-019-028  
 Revision: 4  
 Page: 2 of 4

 SCHEDULED

 UNSCHEDULED

A = Satisfactory X = Unsatisfactory (Explanation required)	A or X	Observation/Corrective Action Taken
4. Verify waste unit signs (12) are in Acceptable condition, have correct information, and are legible from a distance of 25 feet.	A	
5. Inspect soil cover for signs of erosion, abnormal soil cracks, ponding, or depressions (subsidence).	A	
6. Inspect for signs of burrowing animals.	X	ARMADILLO'S DIGGING IN SEVERAL AREAS ON CAP. SEE MAP NOTE (2). REF. MAINT REGISTER PC-2018-00128
7. Visually inspect vegetative cover for grass density, with no bare spots more than 3 feet by 3 feet in the area. The height of vegetative cover should not impair visual inspection of soil cover. This will be determined by the Inspector.	A	
8. Inspect integrity of drainage system for presence of excessive erosion, sediment build-ups, slumping of banks, and any debris restricting water flow.	X	CARRY OVER ITEM: VEGETATION NEEDS TO BE REMOVED FROM THE OUTLET DRAINAGE PIPE LOCATED ON THE WEST SIDE. SEE MAP NOTE (3)
9. Inspect integrity of catch basins, including inlet/outlet drainage structures. Basins shall be cleaned every 2 years or when Inspector or Post Closure Manager determines capacity of basin has been reduced by greater than 50 percent.	X	CARRY OVER ITEM: OUTLET DRAINAGE DITCHES NEED VEGETATION REMOVED ON THE SOUTH + WEST CATCH BASINS. SEE MAP NOTE (4) REF. MAINT REGISTER - PC-2018-00046
10. Inspect gas vents for signs of damage or obstructions.	A	
11. Inspect subsidence monitors annually for damage and visibility.	A	

Sanitary Landfill (Bldg. 740-G) Field Inspection Checklist

Manual: C3  
 Procedure: ER-IDS-019-028  
 Revision: 4  
 Page: 3 of 4

SCHEDULED       UNSCHEDULED

A = Satisfactory X = Unsatisfactory (Explanation required)		A or X	Observation/Corrective Action Taken
12.	Inspect benchmarks to ensure each is visible and free of damage.	A	
13.	Survey subsidence monitors every 5 years. The next topographical survey is due November 2022 and every 5 years thereafter. Verify copies of the latest survey results are in EC&ACP Document Control Center.	A	SURVEY COMPLETE 10-31-17
14.	Other  WEST CATCH BASIN	X	CARRY OVER ITEM: HOLE DAMAGE ON THE SIDE SLOPE OF THE WEST CATCH BASIN. SEE MAP NOTE (3) REF. MAINT. REGISTER PC-2018-00084

Inspected By:		
CHARLES P. CARTER Print Name	<i>Charles P. Carter</i> Signature	11-19-18 Date

Reviewed By Post Closure Manager:		
George W. Joyner Print Name	<i>George W. Joyner</i> Signature	12/3/18 Date

Map of Sanitary Landfill (Bldg. 740-G)

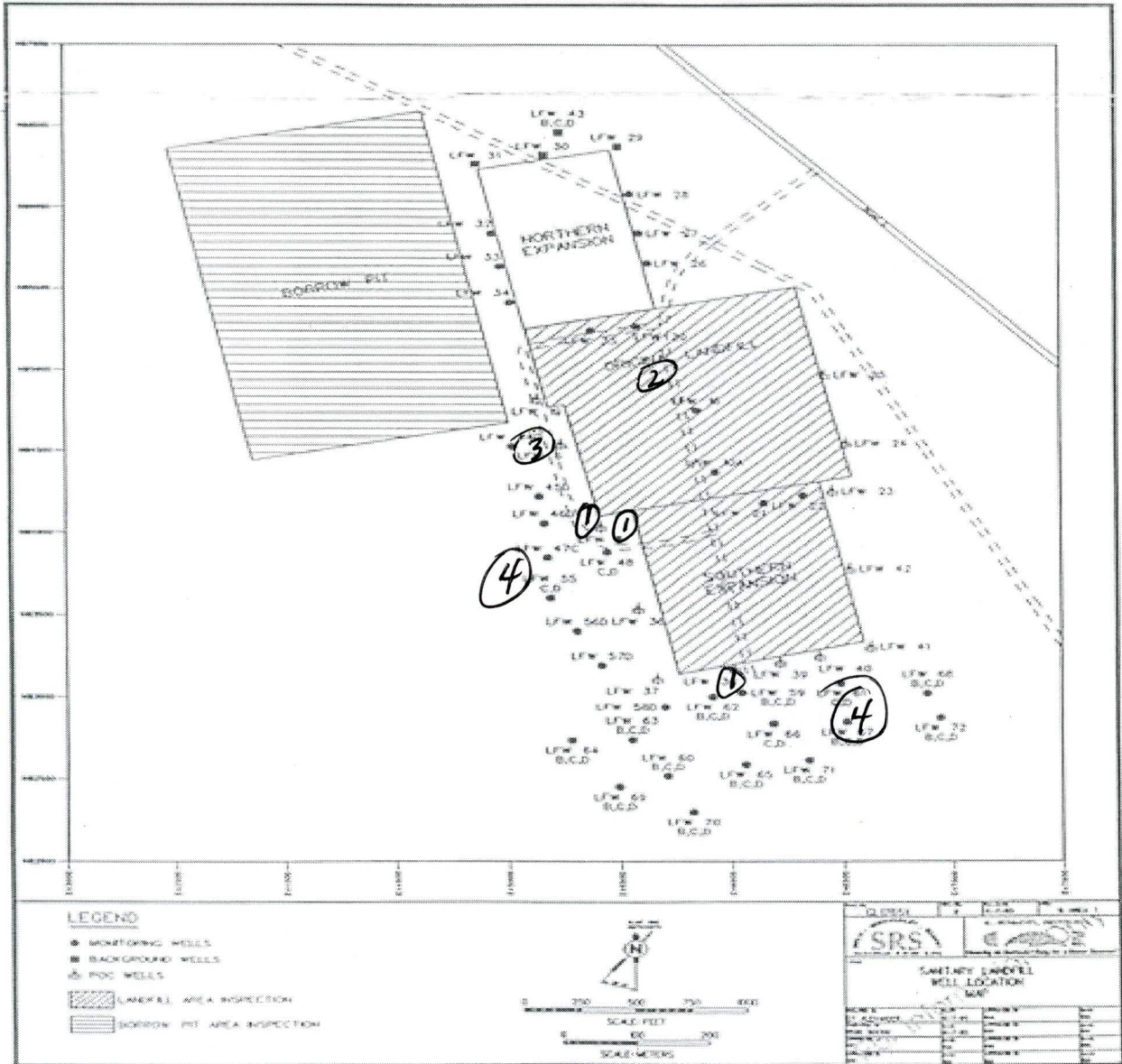

NOTES: ① GAP IN BOTTOM OF FENCE AT THE OUTLET DITCH TO THE SOUTH CATCH BASIN, ALSO SEVERAL ARMADILLO HOLES UNDER FENCE. USES WILL FILL HOLES WITH REP-RAP. REF. MAINT REGISTER PC-2018-0012?

② = ARMADILLO'S DIGGING IN SEVERAL AREA'S ON CAP. USES WILL REPAIR.

③ = CARRY OVER ITEM: VEGETATION NEEDS TO BE REMOVED FROM THE OUTLET DRAINAGE PIPE LOCATED ON THE WEST SIDE. USES WILL REMOVE VEGETATION. REF. MAINT REGISTER PC-2018-0045

④ = CARRY OVER ITEM: OUTLET DRAINAGE DITCHES NEEDS VEGETATION REMOVED ON THE SOUTH + WEST CATCH BASINS; USES WILL REMOVE VEGETATION.

⑤ = CARRY OVER ITEM: HOLE DAMAGE ON THE SIDE SLOPE OF THE WEST CATCH BASIN. USES WILL REPAIR WITH TOP SOIL, GRASS SEED + STRAW.

CPL 11-19-18

# POST CLOSURE MAINTENANCE REGISTER

**Index Number**
**Unit Name**

21 NON-RADIOACTIVE WASTE DISPOSAL FACILITY (AKA SANITARY LANDFILL RCRA PORTION)- 740-G

**Watershed** UPPER THREE RUNS

AHA # NA  
 Work Order # N/A  
 Work Group USFS  
 Priority Medium  
 RCRA YES

**Maintenance Number** PC-2018-00128

Maintenance Status Complete

Inspection Date 11/19/2018

Chemical Type

Completion Date 1/7/2019

Chemical Name

Amount Used

**Description Of Maintenance Item**

Armadillo's digging in several area's on the cap.

**Maintenance Item Corrected**

US Forest service will make repairs with top soil, grass seed and straw

**Notes** New observation

Approved by : George Joyner - ACP Post Closure Manager

Signature

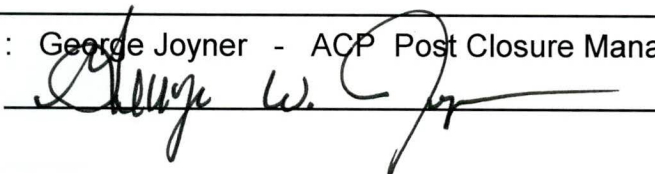

Approval date :

1/24/19

# POST CLOSURE MAINTENANCE REGISTER

**Index Number**
**Unit Name**

21 NON-RADIOACTIVE WASTE DISPOSAL FACILITY (AKA SANITARY LANDFILL RCRA PORTION)- 740-G

**Watershed** UPPER THREE RUNS

AHA # NA  
 Work Order # N/A  
 Work Group USFS  
 Priority Medium  
 RCRA YES

**Maintenance Number** PC-2018-00127      **Maintenance Status** Complete  
**Inspection Date** 11/19/2018      **Chemical Type**  
**Completion Date** 1/2/2019      **Chemical Name**  
    **Amount Used**

**Description Of Maintenance Item**

Gap in the bottom of the fence at the outlet ditch to the South Catch Basin, also several armadillo holes under fence.

**Maintenance Item Corrected**

US Forest service will make repairs.

**Notes** New observation

Approved by : George Joyner - ACP Post Closure Manager

Signature

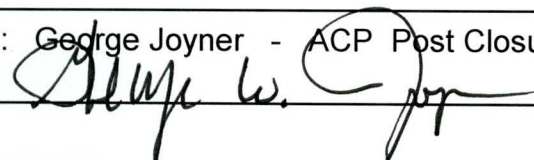

Approval date :

1/24/19