

**ENVIRONMENTAL COMPLIANCE & AREA COMPLETION PROJECTS (EC&ACP) STANDARD  
OPERATING PROCEDURES, VOL. I**
**Manual:** C3  
**Procedure:** ER-IDS-019-016  
**Revision:** 5  
**Effective Date:** 12/21/2021  
**Type-Class:** Checklist  
**Page:** 1 of 3

**C-AREA BURNING RUBBLE PIT (BLDG. 131-C) FIELD INSPECTION CHECKLIST**
**WORKING COPY**

This document is a Working Copy. Prior to start of work, verify this is the latest revision per the Procedure Index.

Bronson Heise  
Verified By

12/20/24  
Date

**CAUTION**

The Inspector is required to IMMEDIATELY notify the Post-Closure Manager and Environmental Compliance Authority if there has been a breach or compromise of the institutional controls of this waste unit. This notification is required to be in accordance with Savannah River Site post-closure inspection procedures.

**NOTE**

1. Manual C3, Volume 1, Procedure ER-SOP-019, Waste Unit and IOU Inspection and Maintenance, is referenced for inspection details.
2. Monitoring wells associated with this waste unit are maintained in accordance with Environmental Compliance and Area Completion Projects monitoring well procedures.
3. Steps in this checklist may be completed concurrently or in any order.

 SCHEDULED

 UNSCHEDULED

A = Satisfactory X = Unsatisfactory (Explanation required)		A or X	Observation/Corrective Action Taken
1.	VERIFY roads are accessible.	A	
2.	VERIFY waste unit signs (4) are in acceptable condition, have correct information, and are legible from a distance of 25 feet.	A	

**C-Area Burning Rubble Pit (Bldg. 131-C) Field Inspection Checklist**

Manual: C3  
 Procedure: ER-IDS-019-016  
 Revision: 5  
 Page: 2 of 3

SCHEDULED

UNSCHEDULED

A = Satisfactory X = Unsatisfactory (Explanation required)		A or X	Observation/Corrective Action Taken
3.	VERIFY there is no excavating, digging, or construction activity on soil cover.	A	
4.	VERIFY no woody vegetation is growing on the soil cover, AND REMOVE OR IDENTIFY as needed.	A	
5.	VISUALLY CHECK vegetative cover for grass density with no bare spots more than 3 feet by 3 feet in area. (The height of vegetation should not impair visual inspection of soil cover. This will be determined by the Inspector.)	A	
6.	CHECK soil cover for signs of erosion or depressions (subsidence).	A	
7.	CHECK for signs of burrowing animals.	A	
8.	Other.	A	none.

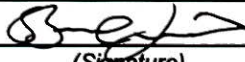
Inspected By		
Brunson Heise (Print Name)	 (Signature)	12/20/24 (Date)

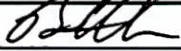
Reviewed By Post-Closure Manager		
Brian Hanshaw (Print Name)	 (Signature)	12/30/2024 (Date)

Map of C-Area Burning Rubble Pit (Bldg. 131-C)

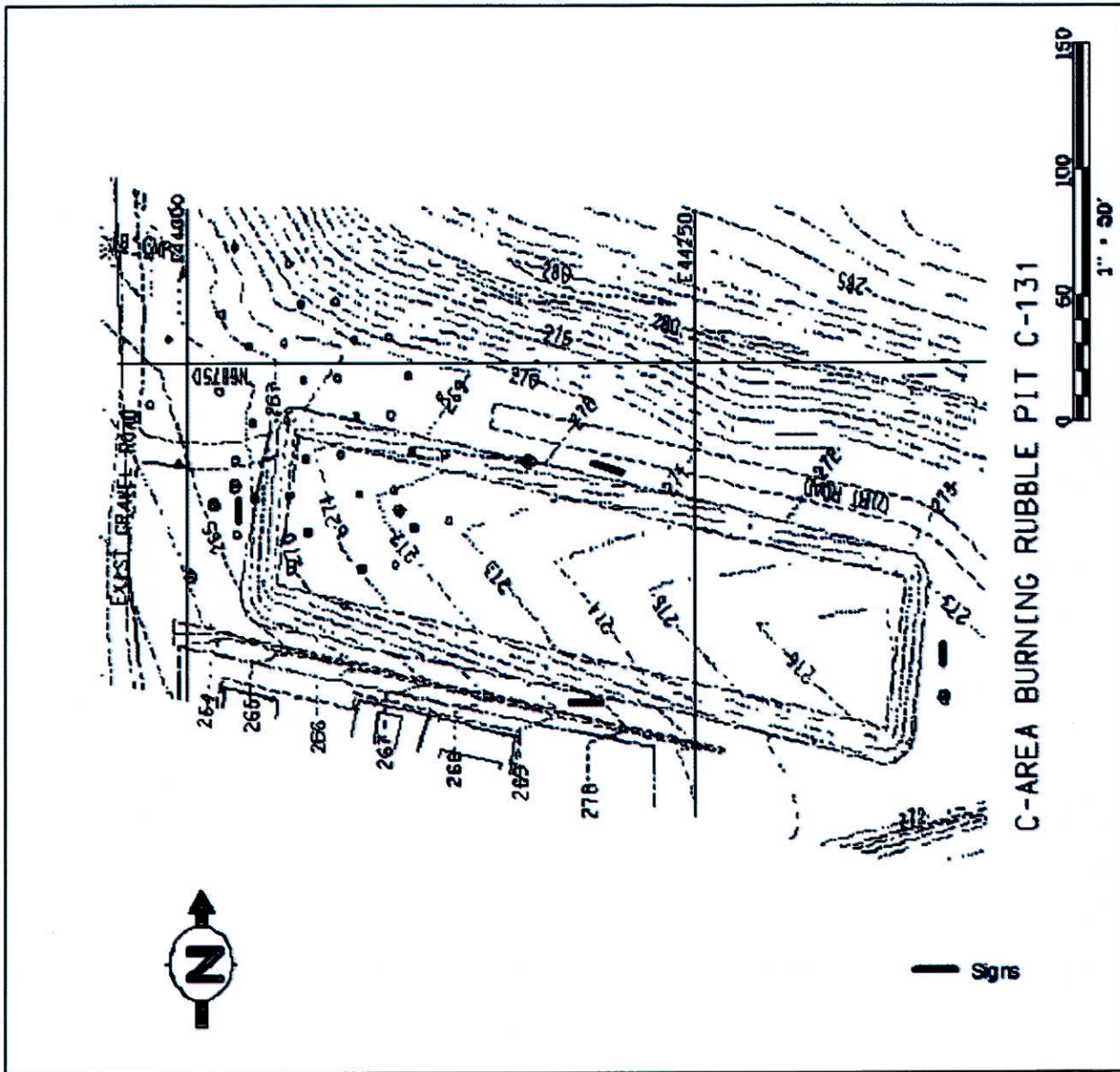

NOTES: None.

---

---

---

---

---

---

---

---