

F-AREA BURNING/RUBBLE PITS 231-F, 231-1F AND 231-2F FIELD INSPECTION CHECKLIST

WORKING COPY

This document is a Working Copy. Prior to start of work, verify this is the latest revision per the Procedure Index.

Douglas E. Barron

 Verified By

07/11/2024

 Date

CAUTION

The Inspector will IMMEDIATELY notify the Post-Closure Manager and Environmental Compliance Authority if there has been a breach or compromise of the institutional controls of this waste unit. This notification will be in accordance with Savannah River Site post-closure inspection procedures.

NOTE

1. Manual C3, Volume 1, Procedure ER-SOP-019, Waste Unit and IOU Inspection and Maintenance, is used as a reference for inspection details.
2. Monitoring wells associated with this waste unit are maintained in accordance with Environmental Compliance and Area Completion Projects monitoring well procedures.
3. Steps in this checklist may be completed concurrently or in any order.

SCHEDULED

UNSCHEDULED

A = Satisfactory X = Unsatisfactory (Explanation required)		A or X	Observation/Corrective Action Taken
1.	VERIFY roads to waste unit are accessible.	A	
2.	VERIFY waste unit signs (8) are in acceptable condition, have correct information, and are legible from a distance of 25 feet.	A	

F-Area Burning/Rubble Pits 231-F, 231-1F and 231-2F Field Inspection Checklist

Manual: C3
 Procedure: ER-IDS-019-002
 Revision: 9
 Page: 2 of 3

SCHEDULED UNSCHEDULED

A = Satisfactory		A or X	Observation/Corrective Action Taken
X = Unsatisfactory (Explanation required)			
3.	VERIFY there is no excavating, digging, or construction activity on soil cover.	A	
4.	VERIFY no woody vegetation is growing on soil cover, AND REMOVE OR IDENTIFY as needed.	A	
5.	VISUALLY CHECK vegetative cover for grass density with no bare spots more than 3 feet by 3 feet in area. (The height of vegetative cover should not impair visual inspection of soil cover. This will be determined by Inspector.)	A	
6.	CHECK soil cover for signs of erosion or depressions (subsidence).	A	
7.	CHECK for signs of burrowing animals.	X	Active Ant Mounds on Soil Cover See Map Note: 1 Reference Maintenance Register: PC-2024-00039
8.	Other NONE	A	

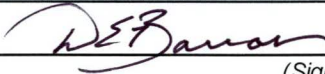
Inspected by		
Douglas E. Barron (Print Name)	 (Signature)	07/11/2024 (Date)

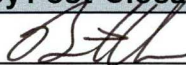
Reviewed by Post-Closure Manager		
Brian Hanshew (Print Name)	 (Signature)	7/17/2024 (Date)

Map of F-Area Burning/Rubble Pits

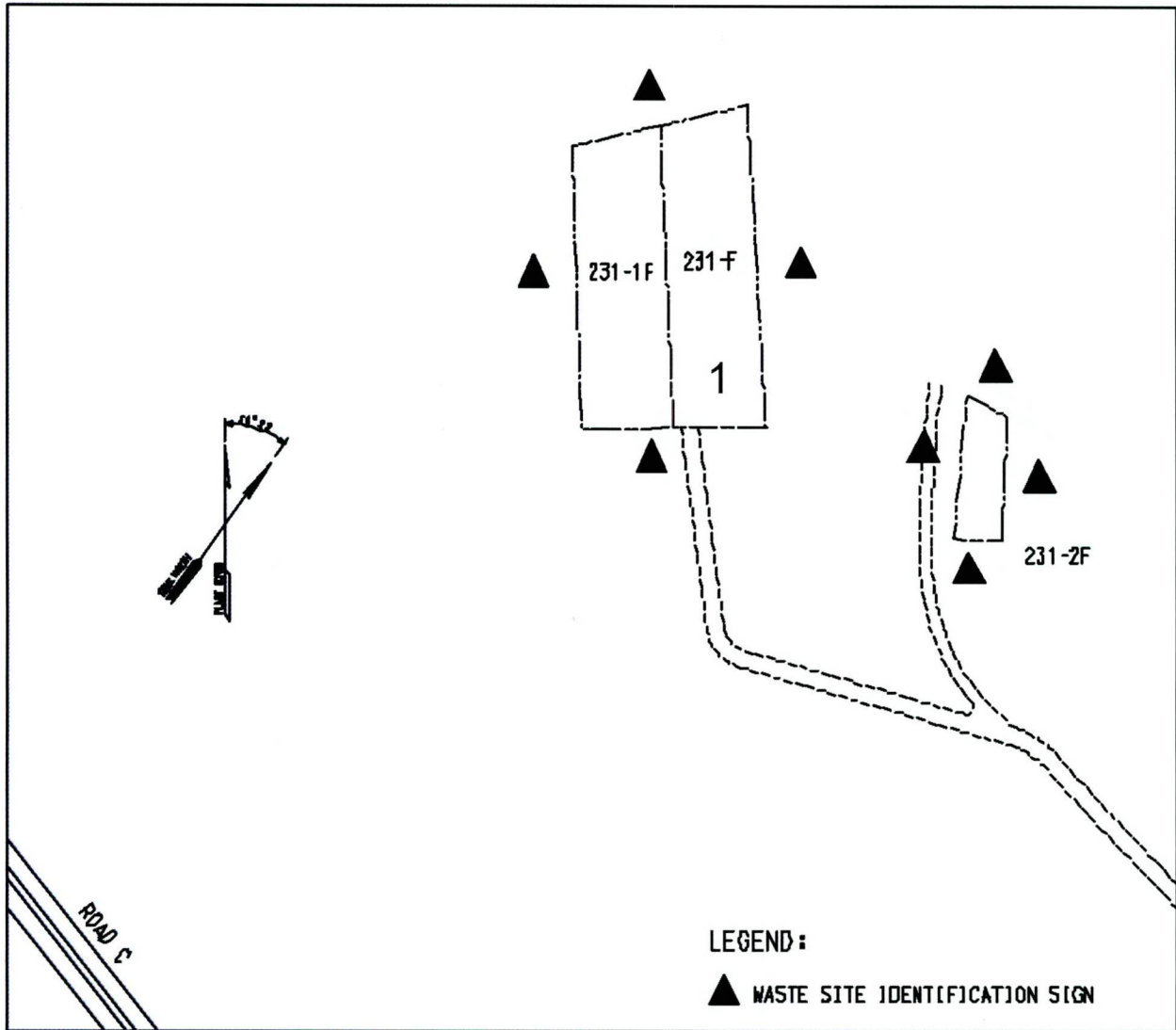

NOTES: 1=Active ant mounds on soil cover. Applied 1.0 lbs. of Extinguish ant bait.

No Further Entries

NEB 7-11-24

POST CLOSURE MAINTENANCE REGISTER

Index Number	Unit Name
34	F-AREA BURNING/RUBBLE PITS - 231-1F
35	F-AREA BURNING/RUBBLE PITS - 231-2F
36	F-AREA BURNING/RUBBLE PITS - 231-F

Watershed UPPER THREE RUNS

AHA # AHA-ER-5534
Work Order # NA
Work Group POST CLOSURE MAINTENANCE
Priority Medium
RCRA NO

Maintenance Number	PC-2024-00039	Maintenance Status	Complete
Inspection Date	7/11/2024	Chemical Type	Pesticide
Completion Date	7/11/2024	Chemical Name	Extinguish
		Amount Used	1.0 Pounds

Description Of Maintenance Item
Active ant mounds on waste unit

Maintenance Item Corrected
Applied Extinguish pesticide

Notes ER-IDS-019-002

Approved by : Brian Hanshew - ACP Post Closure Manager

Signature



Approval date :

7/17/24