





**P-Area Early Construction and Operational Disposal Site (ECODS) P-2 Operable Unit Field  
Inspection Checklist**

**Manual:** C3  
**Procedure:** ER-IDS-019-055  
**Revision:** 4  
**Page:** 2 of 3

SCHEDULED       UNSCHEDULED

	A = Satisfactory X = Unsatisfactory (Explanation required)	A or X	Observation/Corrective Action Taken
4.	VERIFY there are no unauthorized excavations, digging, or construction activities within the Early Construction and Operational Disposal Site (ECODS) P-2 boundaries.	X	Carry over - PC-2024-00110 Trees down in waste unit boundary.
5.	VERIFY signs of erosion or depression (e.g., subsidence) are not present. (CMIR/RACR, Section 7, Item 5).	A	
6.	VERIFY signs of burrowing or mounding animals are not present. (CMIR/RACR, Section 7, Item 4).	A	
7.	Other	A	None.

Inspected By		
Bronson Heise (Print Name)	 (Signature)	5/16/25 (Date)

Reviewed by Post-Closure Manager		
Brian Hanshaw (Print Name)	 (Signature)	5-28-25 (Date)

**P-Area Early Construction and Operational Disposal Site  
(ECODS) P-2 Operable Unit Field Inspection Checklist**

**Manual: C3**  
**Procedure: ER-IDS-019-055**  
**Revision: 4**  
**Page: 3 of 3**

**Map of P-Area ECODS P-2 Operable Unit**

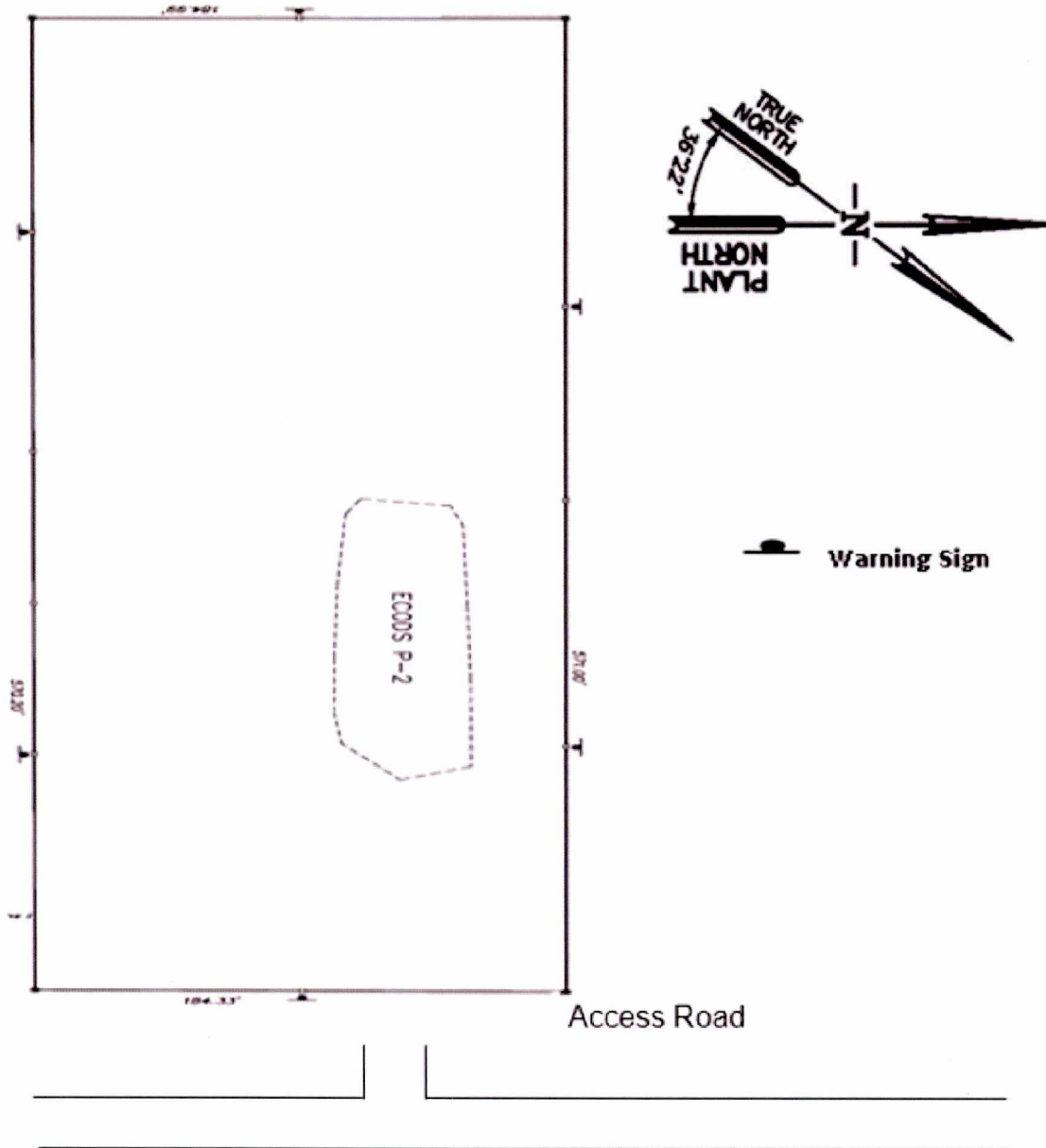

**NOTES:**

*None. BA 5/16/25*