

**ENVIRONMENTAL COMPLIANCE & AREA COMPLETION PROJECTS (EC&ACP) STANDARD  
OPERATING PROCEDURES, VOL. I**
**Manual: C3**  
**Procedure: ER-IDS-019-053**  
**Revision: 3**  
**Effective Date: 09/02/2021**  
**Type-Class: Checklist**  
**Page: 1 of 3**
**L-AREA EARLY CONSTRUCTION AND OPERATIONAL DISPOSAL SITE (ECODS) L-1 OPERABLE  
UNIT FIELD INSPECTION CHECKLIST**
**WORKING COPY**

This document is a Working Copy. Prior to start of work, verify this is the latest revision per the Procedure Index.

Dylan Price  
Verified By

12-6-24  
Date

**CAUTION**

The Inspector will IMMEDIATELY notify the Post-Closure Manager and Environmental Compliance Authority if there has been a breach or compromise of the institutional controls of this waste unit. This notification will be made in accordance with Savannah River Site post-closure inspection procedures.

**NOTE**

1. Manual C3, Volume 1, Procedure ER-SOP-019, Waste Unit and IOU Inspection and Maintenance, will be referenced for inspection details.
2. Steps in this checklist may be completed concurrently or in any order.

DP  
12-6-24

 SCHEDULED

UNSCHEDULED

<b>A = Satisfactory</b> <b>X = Unsatisfactory (Explanation required)</b>		A or X	Observation/Corrective Action Taken
1.	<b>VERIFY</b> roads are accessible, <b>AND</b>  REFER TO SRNS-RP-2010-01524, Corrective Measures Implementation Report (CMIR)/Remedial Action Completion Report (RACR), Section 7, Note 1.	A	
2.	<b>VERIFY</b> waste unit warning signs (6) are in acceptable condition, have correct information, and are legible from a distance of 25 feet.	A	
3.	<b>CHECK</b> survey boundary monuments for damage and visibility.	A	

**L-Area Early Construction and Operational Disposal Site (ECODS) L-1 Operable Unit Field  
Inspection Checklist**

Manual: C3  
 Procedure: ER-IDS-019-053  
 Revision: 3  
 Page: 2 of 3

SCHEDULED                       UNSCHEDULED

A = Satisfactory	A or X	Observation/Corrective Action Taken
X = Unsatisfactory (Explanation required)		
4. VERIFY there are no unauthorized excavations, digging, or construction activities within the Early Construction and Operational Disposal Site L-1 boundaries.	A	
5. VERIFY signs of erosion or depression (subsidence) is not present. SRNS-RP-2010-01524 (CMIR/RACR, Section 7, Item 5).	X	Root ball is uprooted reference maintenance Register PC-2024-00094
6. VERIFY signs of burrowing or mounding animals are not present. SRNS-RP-2010-01524 (CMIR/RACR, Section 7, Item 4).	A	
7. Other	X	Tree across walkway Maintenance Register PC-2024-00094

Inspected By		
Dylan Price (Print Name)	Dylan Price (Signature)	12-6-24 (Date)

Reviewed by Post-Closure Manager		
BRIAN HANSREW (Print Name)	[Signature] (Signature)	12-19-2024 (Date)

L-Area ECODS L-1 Operable Unit

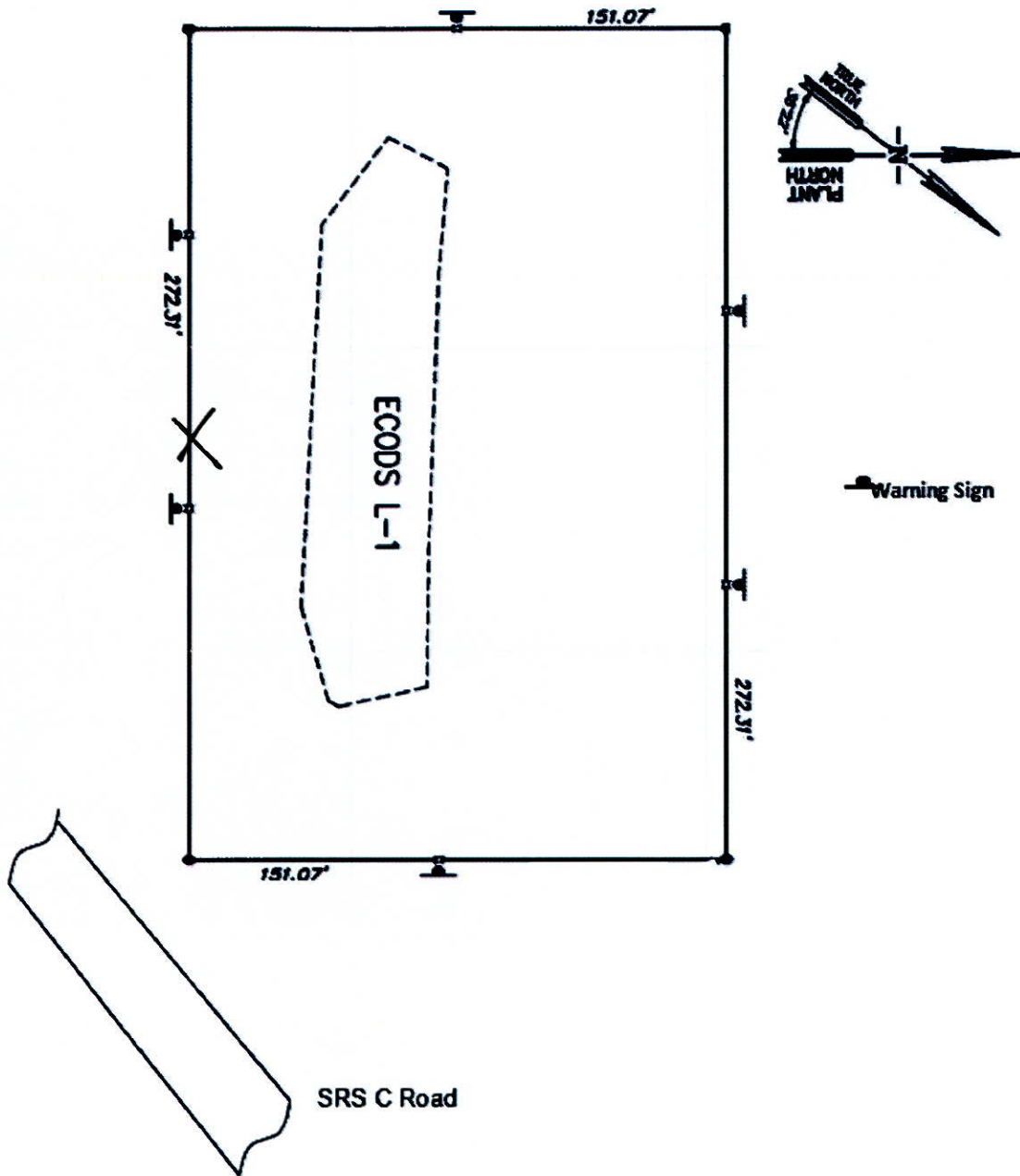

NOTES: X-Tree uprooted and across the walkway

No further Entries

DP 12-6-24

# POST CLOSURE MAINTENANCE REGISTER

**Index Number**

**Unit Name**

535 L AREA ECODS L-1 OPERABLE UNIT

**Watershed** STEEL CREEK

AHA # NA  
Work Order # N/A  
Work Group USFS  
Priority Medium  
RCRA NO

**Maintenance Number** PC-2024-00094

**Maintenance Status** Complete

**Inspection Date** 12/6/2024

**Chemical Type** NA

**Completion Date** 1/14/2025

**Chemical Name**

**Amount Used**

**Description Of Maintenance Item**

The boundary trail has fallen trees laying across the trail that needs to be removed. Contacted USFS to remove.

**Maintenance Item Corrected**

USFS removed trees.

**Notes** ER-IDS-019-053

---

Approved by : Brian Hanshew - ACP Post Closure Manager

Signature



Approval date :

3/12/2025