

**ENVIRONMENTAL COMPLIANCE & AREA COMPLETION PROJECTS (EC&ACP) STANDARD  
OPERATING PROCEDURES, VOL. I**

**Manual:** C3  
**Procedure:** ER-IDS-019-030  
**Revision:** 6  
**Effective Date:** 12/21/2021  
**Type-Class:** Checklist  
**Page:** 1 of 3

**P-AREA BURNING RUBBLE PIT (BLDG. 131-P) FIELD INSPECTION CHECKLIST**

**WORKING COPY**

This document is a Working Copy. Prior to start of work, verify this is the latest revision per the Procedure Index.

Bronson Heise  
Verified By

5/16/25  
Date

**CAUTION**

The Inspector is required to IMMEDIATELY notify the Post-Closure Manager and Environmental Compliance Authority if there has been a breach or compromise of the institutional controls of this waste unit. This notification is required to be in accordance with Savannah River Site post-closure inspection procedures.

**NOTE**

1. Manual C3, Volume I, Procedure ER-SOP-019, Waste Unit and IOU Inspection and Maintenance, is referenced for inspection details.
2. Monitoring wells associated with this waste unit are maintained in accordance with Environmental Compliance & Area Completion Projects monitoring well procedures.
3. Steps in this checklist may be completed concurrently or in any order.

SCHEDULED

UNSCHEDULED

A = Satisfactory X = Unsatisfactory (Explanation required)		A or X	Observation/Corrective Action Taken
1.	VERIFY roads to waste unit are accessible.	A	
2.	VERIFY waste unit signs (4) are in acceptable condition, have correct information, and are legible from a distance of 25 feet.	A	

**P-Area Burning Rubble Pit (Bldg. 131-P) Field Inspection Checklist**

Manual: **C3**  
 Procedure: **ER-IDS-019-030**  
 Revision: **6**  
 Page: **2 of 3**

SCHEDULED       UNSCHEDULED

	<b>A = Satisfactory</b> <b>X = Unsatisfactory (Explanation required)</b>	<b>A or X</b>	<b>Observation/Corrective Action Taken</b>
3.	<b>VERIFY</b> there are no unauthorized excavations, digging, or construction activities on soil cover.	A	
4.	<b>CHECK</b> integrity of drainage ditches for presence of excessive erosion, sediment build-up, and any debris restricting water flow.	X	Post closure removed grass/debris from drainage ditch.
5.	<b>VERIFY</b> no woody vegetation is growing on soil cover, <b>AND REMOVE OR IDENTIFY</b> as needed.	A	
6.	<b>VISUALLY CHECK</b> vegetative cover for grass density with no bare spots more than 3 feet by 3 feet in area. (The height of vegetative cover should not impair visual inspection of soil cover. This will be determined by the Inspector.)	A	
7.	<b>CHECK</b> soil cover for signs of erosion or depressions (subsidence).	A	
8.	<b>CHECK</b> for evidence of burrowing animals.	A	
9.	Other.	A	None.

**Inspected By**

Bronson Heise (Print Name)	 (Signature)	5/16/25 (Date)

**Reviewed By Post-Closure Manager**

Brian Hanshue (Print Name)	 (Signature)	5-28-25 (Date)

**P-Area Burning Rubble Pit (Bldg. 131-P) Field Inspection Checklist**

**Manual:** C3  
**Procedure:** ER-IDS-019-030  
**Revision:** 6  
**Page:** 3 of 3

**Map of P-Area Burning Rubble Pit**

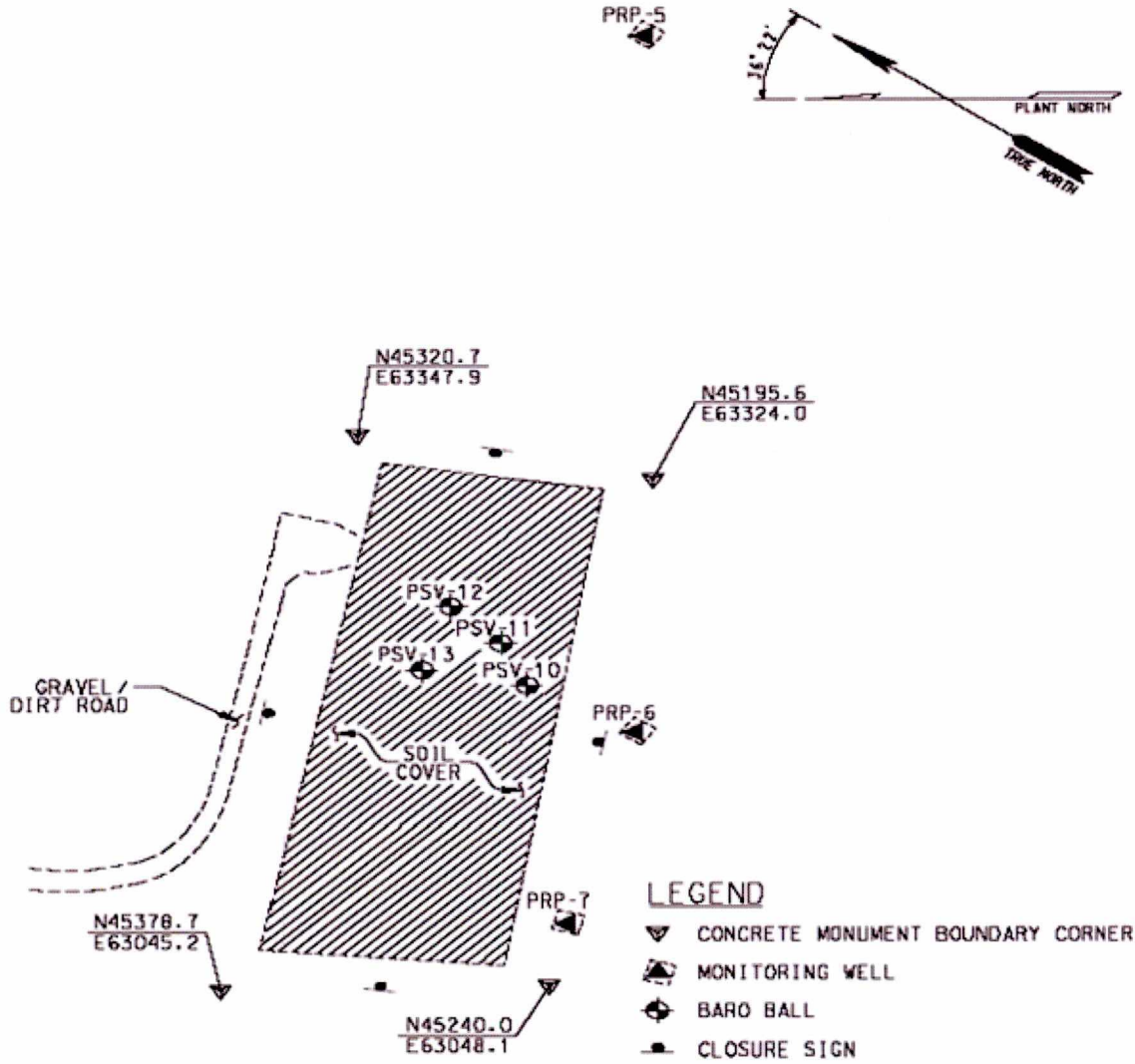

**NOTES:** None - BIA 5/16/25

